

AECOM

LENNIUM
GROUP

Prepared for Lennium Group
V12 | 23 Oct 2024

Lilywood

LANDINGS

Landscape
Master Plan
Report
Stages 1 to 4



Contents

Introduction

/ Context Plan 5

Landscape Masterplan

/ Landscape Masterplan 7

Open Space

/ Local Park - Design Inspiration, Plan, Sections 10-12

/ Southern Drain - Plan 13-17

Streetscape

/ Entry Experience - Design Inspiration, Plan, Sections, Elevation, Entry Wall Montage 20-24

/ The Triple Avenue - Plan 25

/ Fencing Plan Stage 1-4 26-27

Character

/ Character Imagery 30

/ Planting Palette 31

Introduction

Caboolture West is a master planned residential community located on the Caboolture River, within the Moreton Bay Region. It is approximately 10 minutes' drive west of Morayfield and 25 minutes from Moreton Bay.

The site is bounded by the Caboolture River to the north, the existing residential community of Upper Caboolture to the east, Caboolture River Road to the south and a future residential development to the west.

Report Background

The following report outlines the master plan for the proposed stages of 1 to 4 Streetscape and Landscape Design Structure. This report is to be read in association with the accompanying civil and planning reports.

The report outlines the design intent and direction for the detailed design and documentation of all landscape and streetscape elements within the development, and should be used as a guide in developing detailed works.

The overall theme of the development should draw upon the sites unique location within the Moreton Bay Region. A riverside community between the city and sand, Caboolture West.

Landscape Character

The landscape character intent for Caboolture West is to achieve a well-designed residential community that is cohesive, legible and site responsive landscape reflective of the sites history, climate and existing character.

A timeless and contemporary quality is to be achieved through the use of quality materials and attention to detail. The design intent is to take inspiration from the rustic and rural nature of the sites historic and balance it with refined contemporary design utilising quality materials and finishes to establish a unique design language for Caboolture West.

Landscape Vision

To provide a consistent landscape character and amenity throughout the entirety of Caboolture West bringing together a seamless transition of landscape treatments and experiences between stages 1 to 4.

Landscape Principles

- / Celebrate the natural hinterland vegetation and its character
- / Celebrate the sites heritage and draw inspiration from it
- / Provide a high quality landscape with attention to detail and use of quality materials
- / Utilise a predominantly native planting palette
- / Consideration of maintenance
- / Be sustainability, legibility and functionality
- / Encourage active transport through shaded legible connections

Site Context Plan

Situated on the Caboolture River in a valley surrounded by distant hills. The site is at the southern entry to the future Caboolture West development area and minutes from Morayfield and Caboolture transport links and the Bruce Highway.



Not to Scale



Landscape Masterplan

Landscape Masterplan

1:2500 @ A3



Legend

- - - Site boundary
- - - Stage boundary
- Prevailing winds
- Landscape vegetation
- Turf
- GN Green Network (MBRC)
- WSUD elements
- Pathway arrangement. Refer to Civil
- Road and forecourt arrangement. Refer to Civil
- Feature Fig Tree
- Feature Hoop Pine Trees
- Street Trees
- Shade / Revegetation Trees
- Entrance wall





Open space

Local Park

Design Inspiration

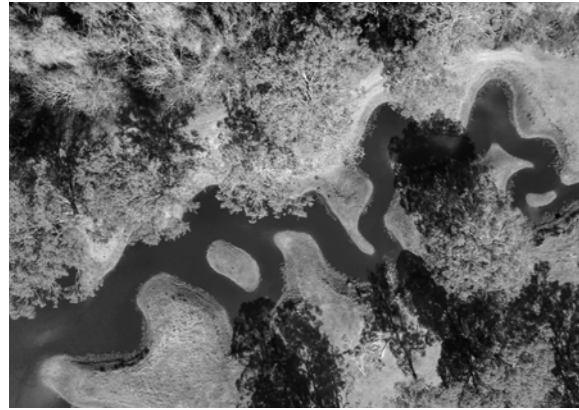
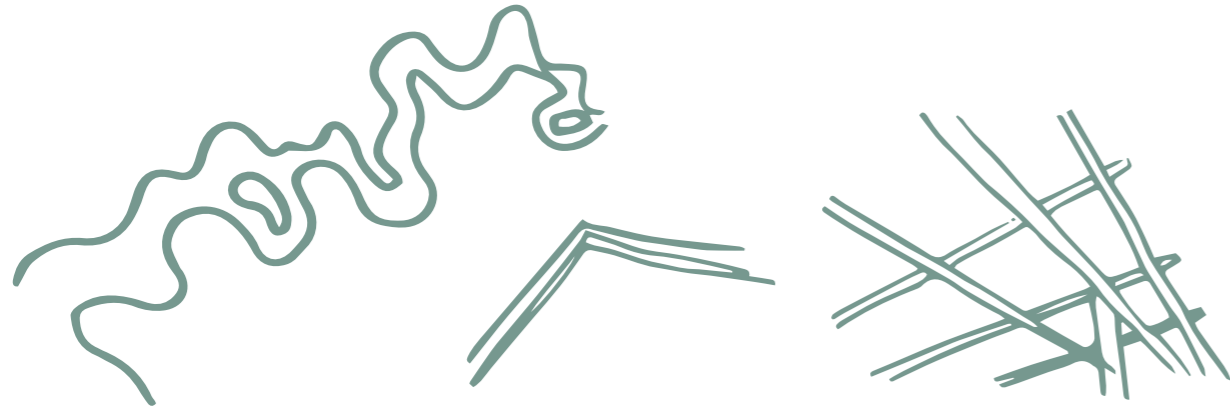

Caboolture River - Softscape / Curves / Land Form / Mounds / Tree Structure / Garden Beds



Historical Architecture - Hardscape / Shelters / Concrete Features / Structure / Pathway Alignments / Geometric Shapes

Form & Function



Coloured features which are inspired by the surrounding natural environment, will entice the residents to explore, whilst creating visual cues for wayfinding and connectivity.

Colour



Artist Impression

Local Park - Plan

1:500 @ A3



Local Park - Section

1:250 @ A3

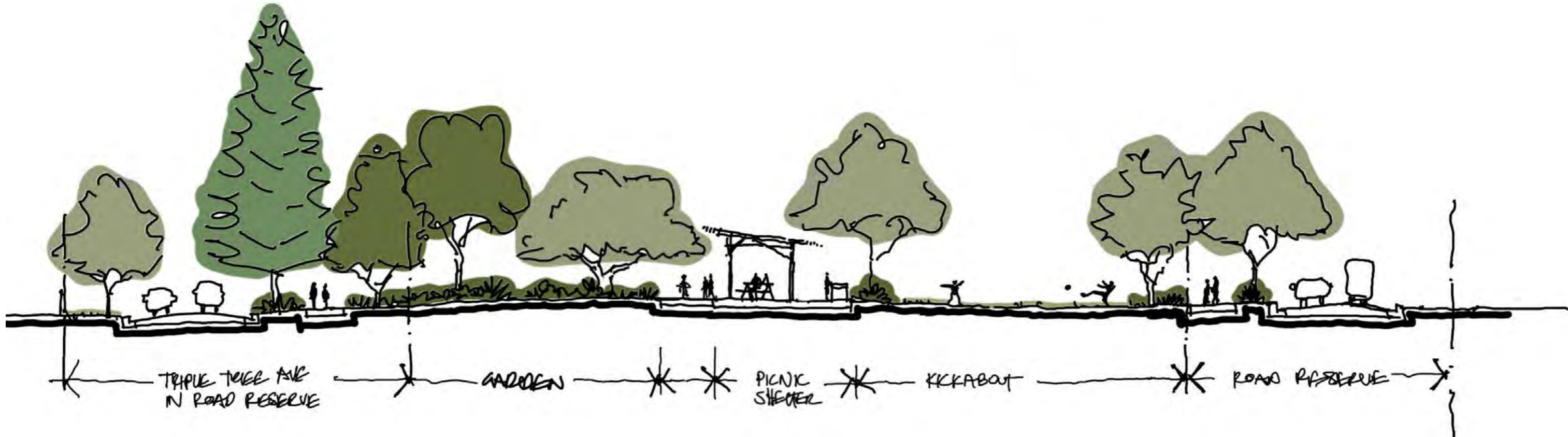

Typical Section AA

Southern Green Network Waterway - Plan

1:1500 @ A3



Legend

- Stage boundary
- Prevailing winds
- Sewer Trunk. Refer Civil
- Revegetation / Drain Trees
- 1 Rock Invert Channel
- 2 Low Flow Channel Planting
- 3 Planted Drain Batters
- 4 Bioretention Basin
- 5 Concrete Footpath. Refer to Civil.



Southern Green Network Waterway - Sections

1:200 @ A3

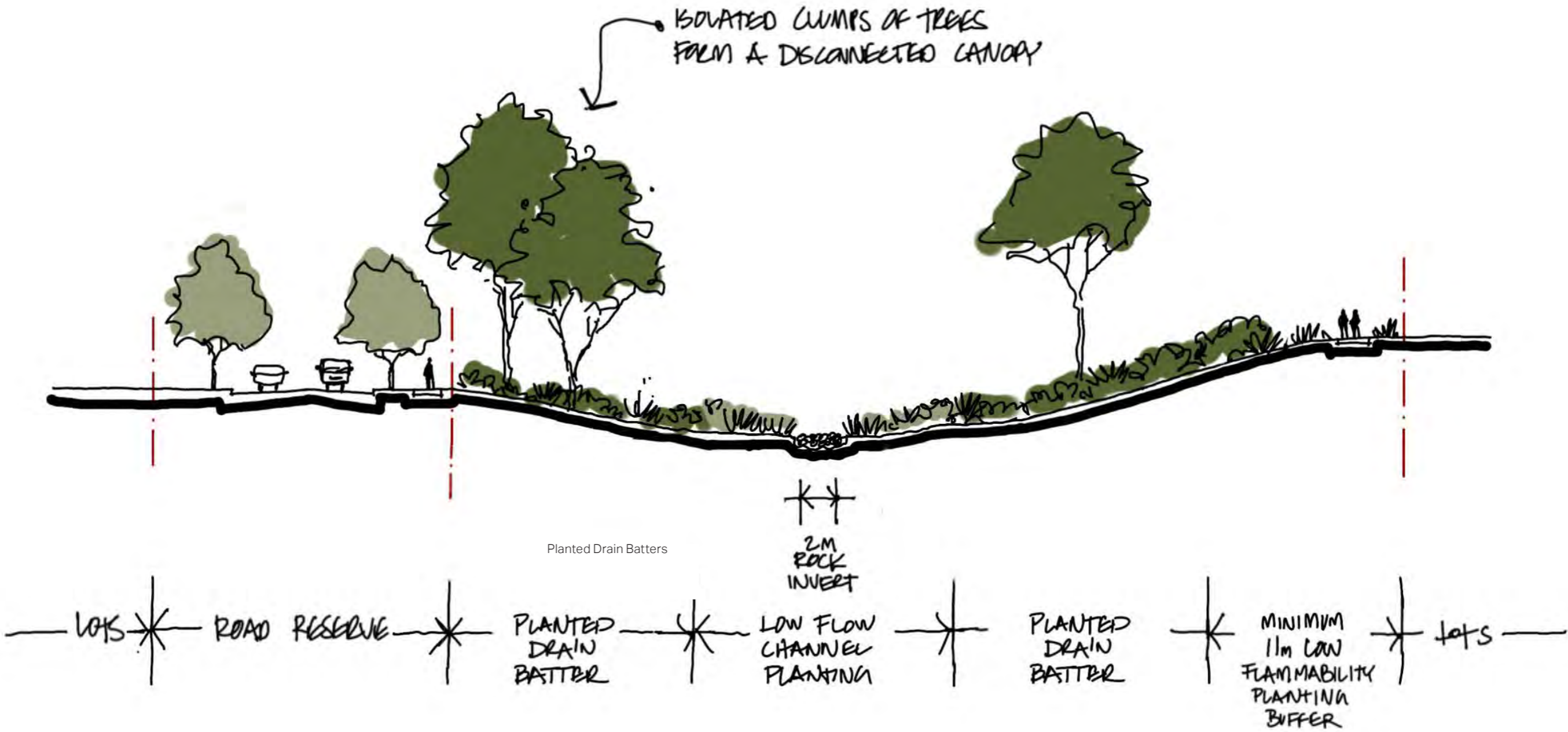

Typical Section AA

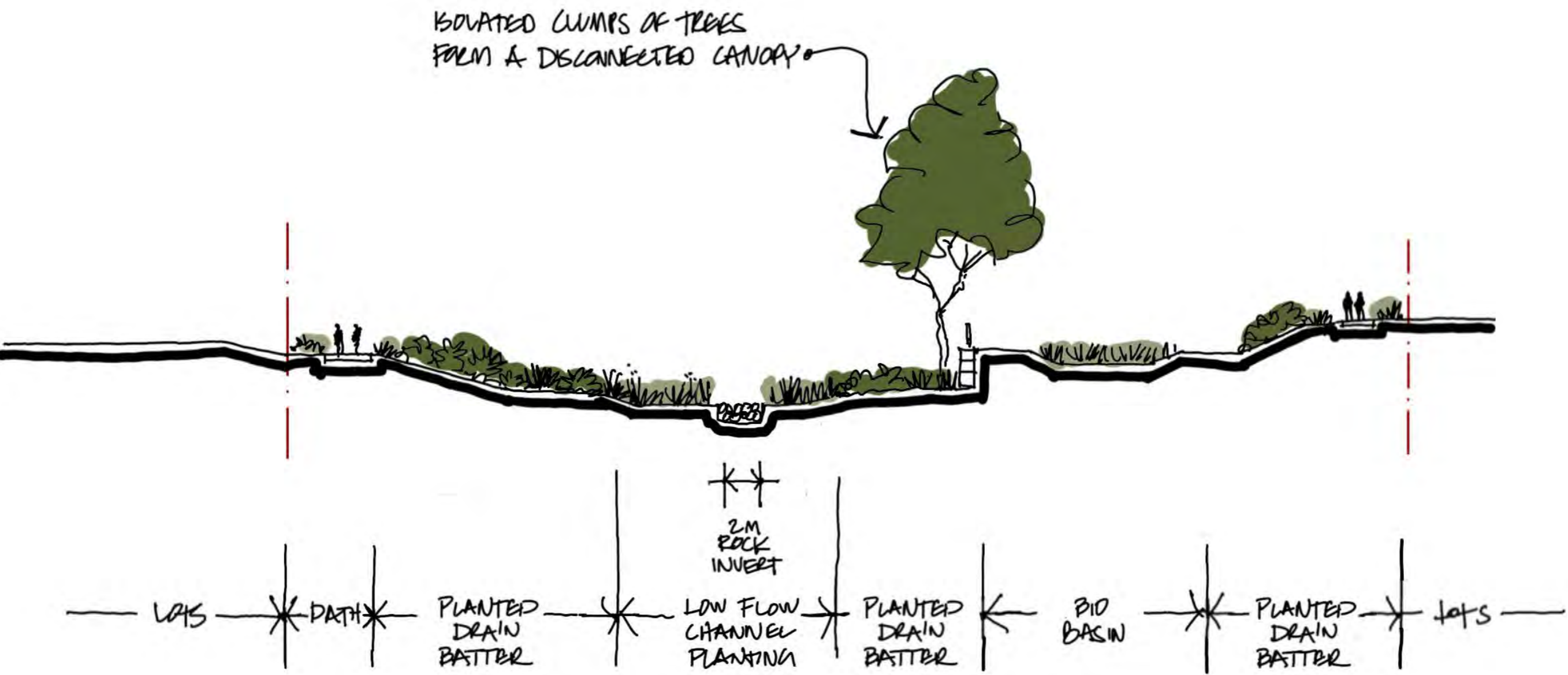

Typical Section BB

Southern Green Network Waterway - Sections

1:200 @ A3

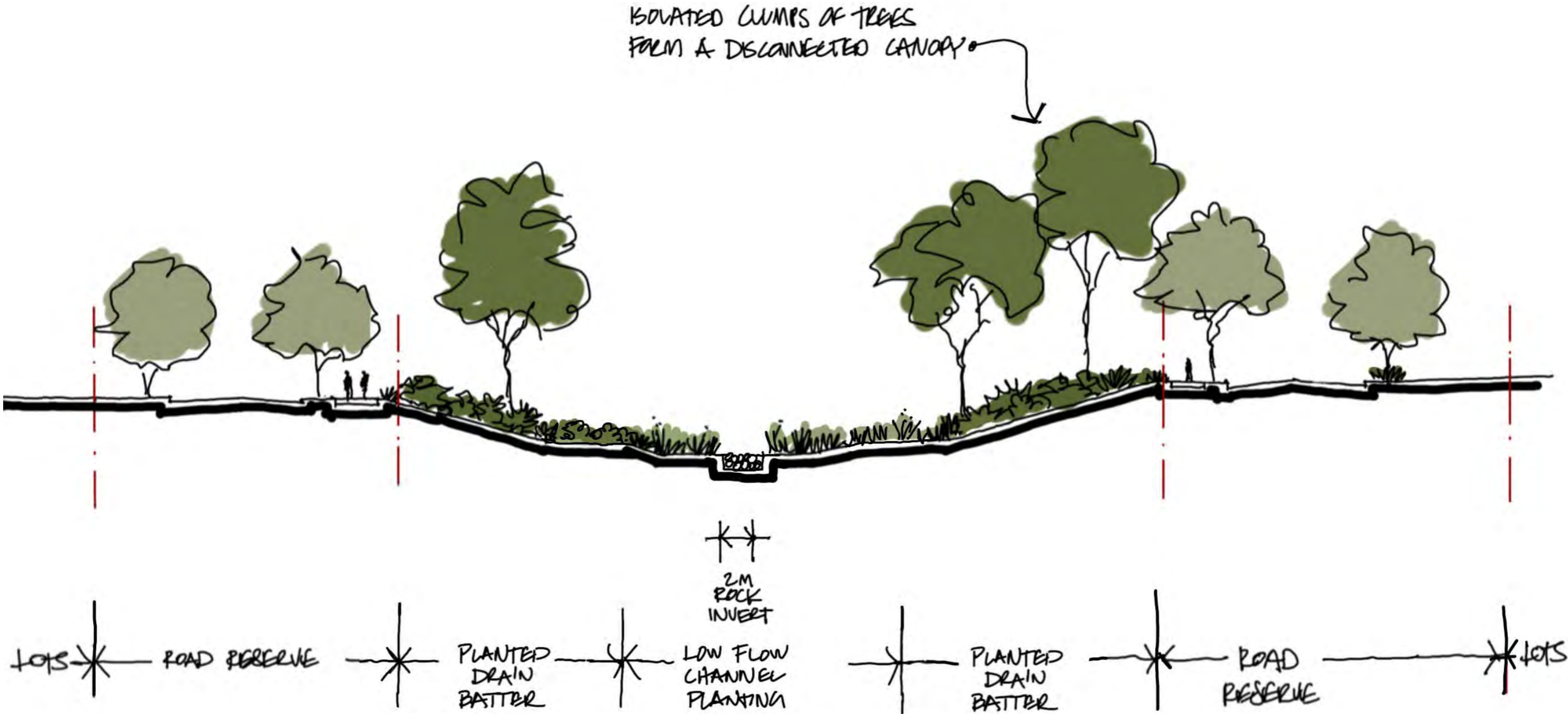

Typical Section CC

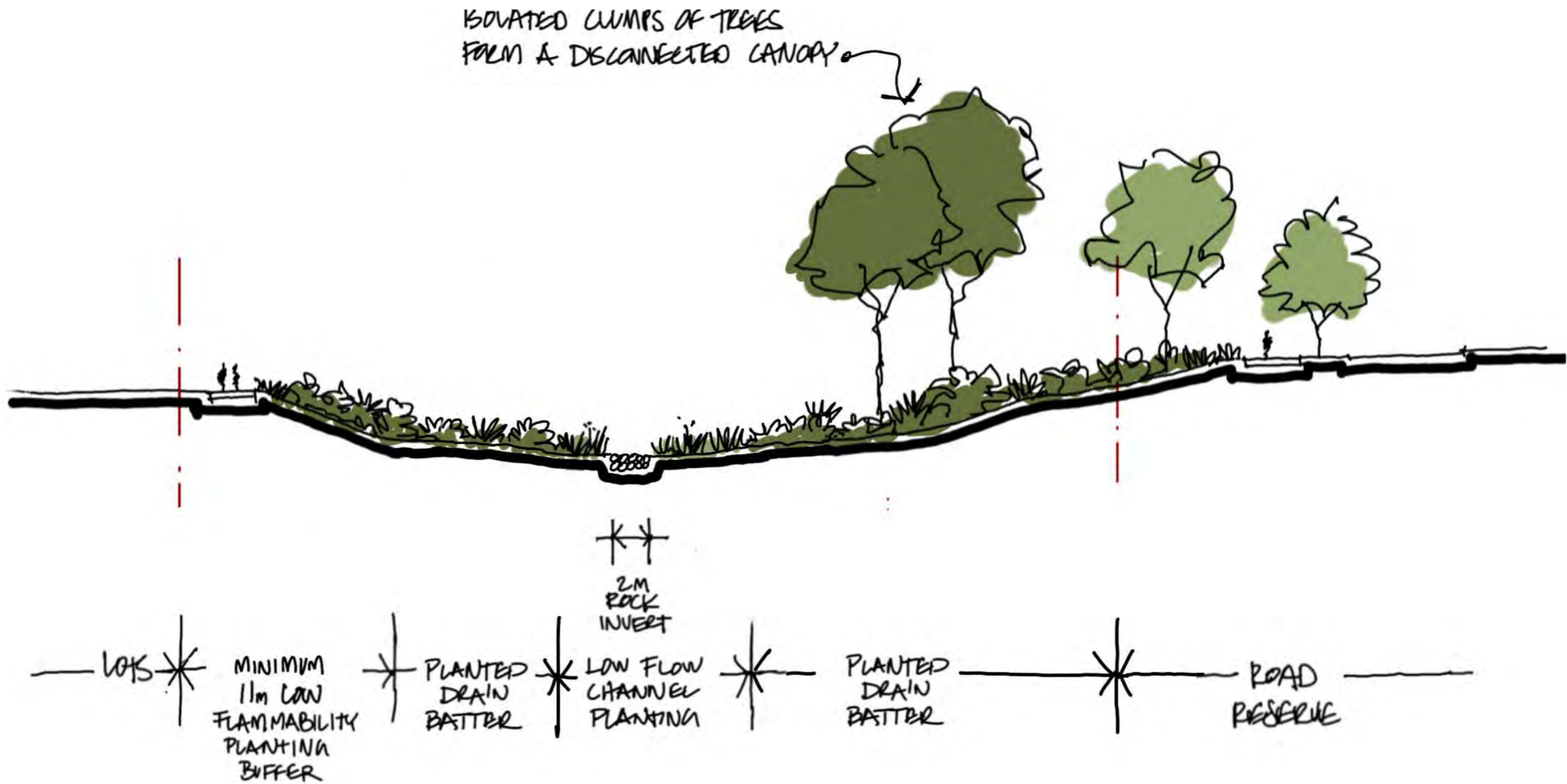

Typical Section DD





Streetscape

Entry Experience

Design Inspiration



Entry Experience Plan

1:1500 @ A3



- ### Legend
- - - - - Site boundary
 - - - - - Stage boundary
 - Prevailing winds
 - Entry Wall
 - Feature posts/pillars on private property
 - Landscape Areas / Vegetation
 - Turf
 - Pathways / Concrete
 - Feature Hoop Pine Trees
 - Street Trees
 - Revegetation / Drain Trees
 - 1 Arrival Feature Planting
 - 2 Shrubs and Understorey to Roundabout. Feature Trees with clear trunks, to accommodate sightlines.
 - 3 Naturalised Drain
 - 4 The Triple Avenue - Major North/South Road
 - 5 Dense hedge screening in front of fencing

Arrival Sequence

1:250 @A3

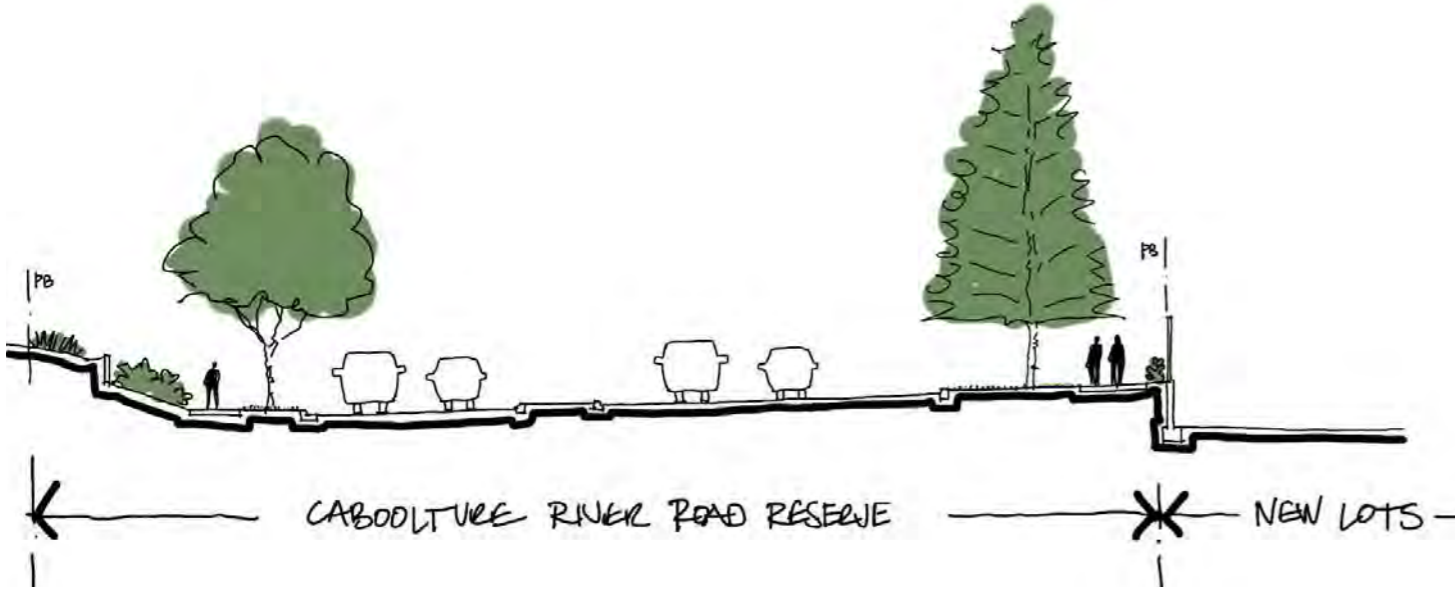

Section AA

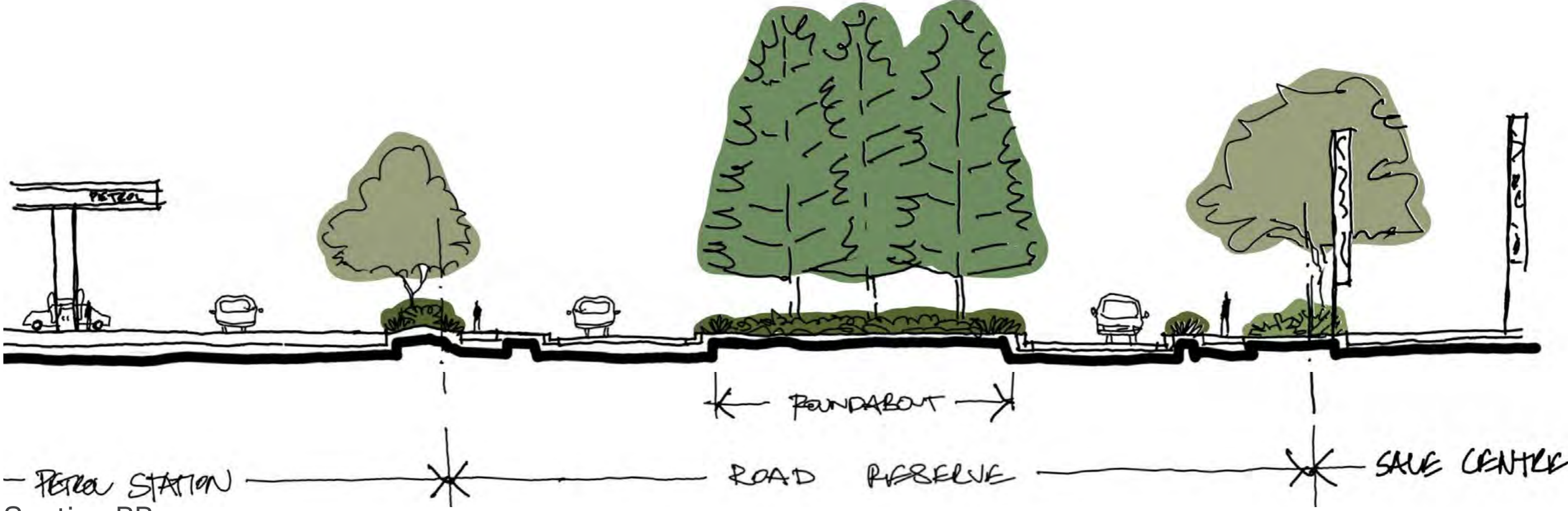

Section BB



Section CC

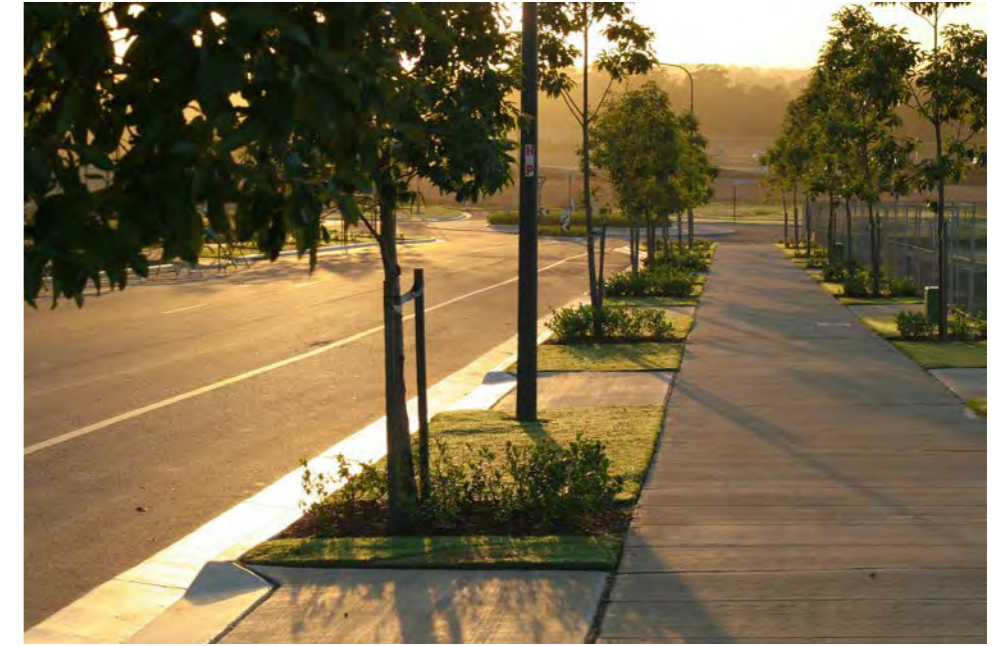

Entry Wall Montage

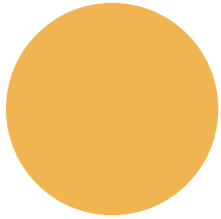

A true sense of arrival



Artist impression

The Triple Avenue - Major North / South Road

1:500 @ A3

Amended by Council in red

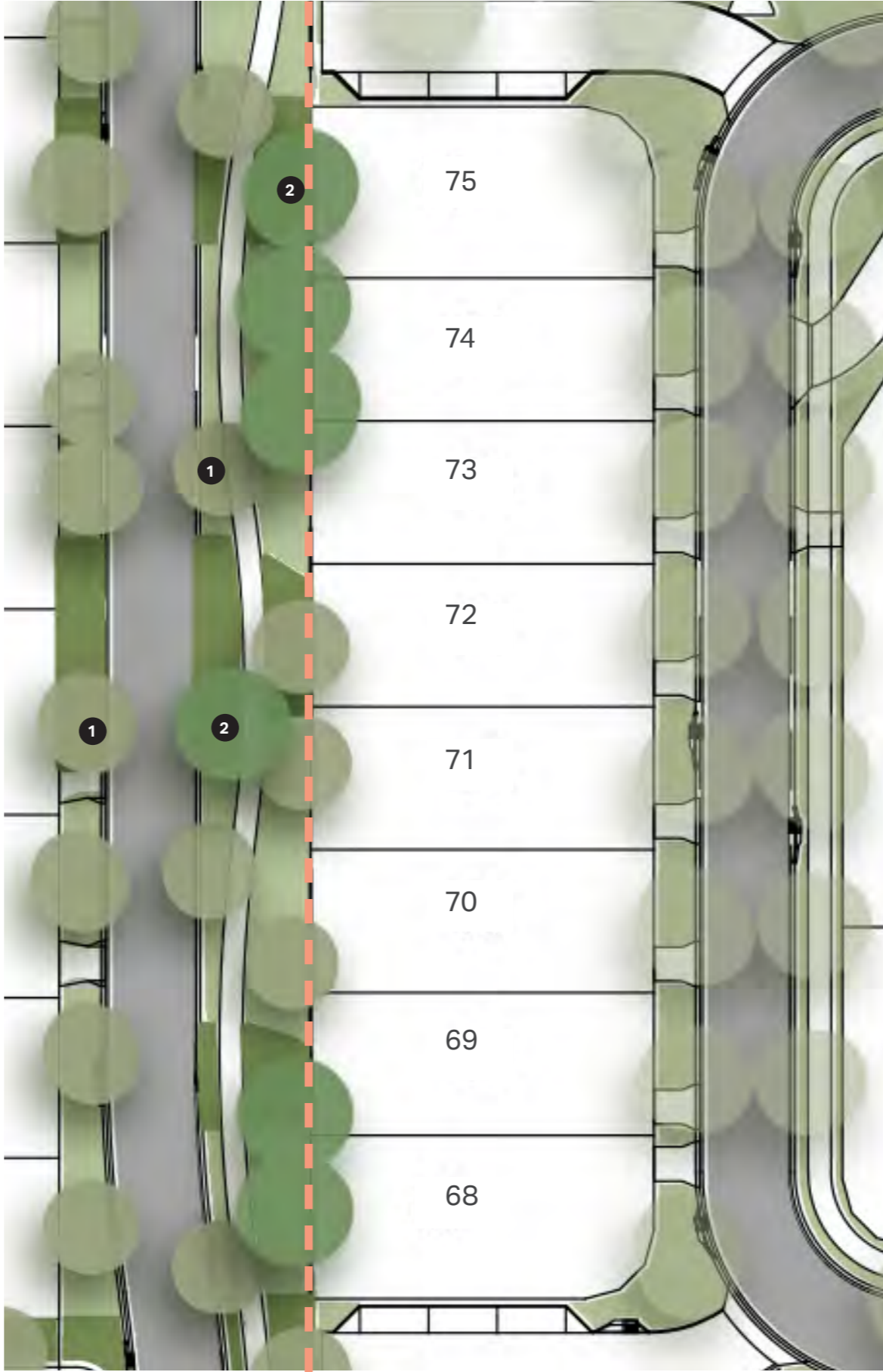

Legend

- Stage boundary
- Prevailing winds
- Civil design contours. Refer to civil package for civil earthworks.
- Existing contours
- Planted Verge
- Native Grass / Groundcover
- 2m Pedestrian Pathway
- Feature Hoop Pine Trees
- Street Trees
- Trees in Mulch / Native Grass / Groundcover
- Trees in Planting

Fencing Plan - Stage 1 to 4

1:2000 @ A3



Legend

- - - - Site boundary
- - - - Stage boundary
- Entry Wall
- Feature posts/pillars on private property
- - - - Acoustic timber paling fence painted charcoal.
- - - - Timber paling fence painted charcoal.
- - - - Open Space Semi-transparent fence
- - - - Side boundary Semi-transparent fence

Fence Types

Variety of proposed fence types to be used in the project including timber paling, acoustic barrier paling and semi transparent fences. Fences to comply with relevant Australian standards for safety and quality assurance.

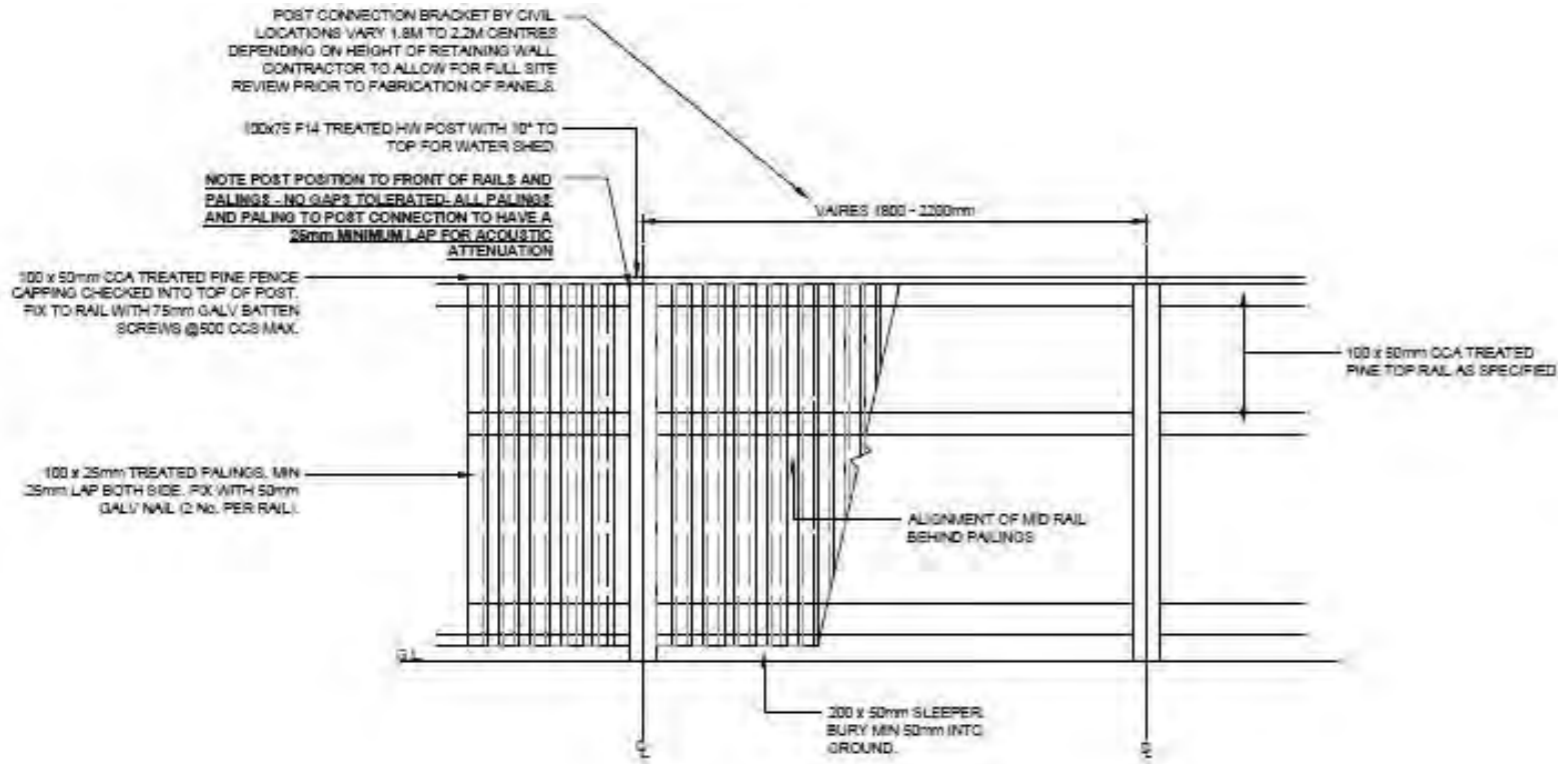

1800 High Acoustic and non-acoustic timber paling fence painted charcoal (Height varies for Acoustic fence)

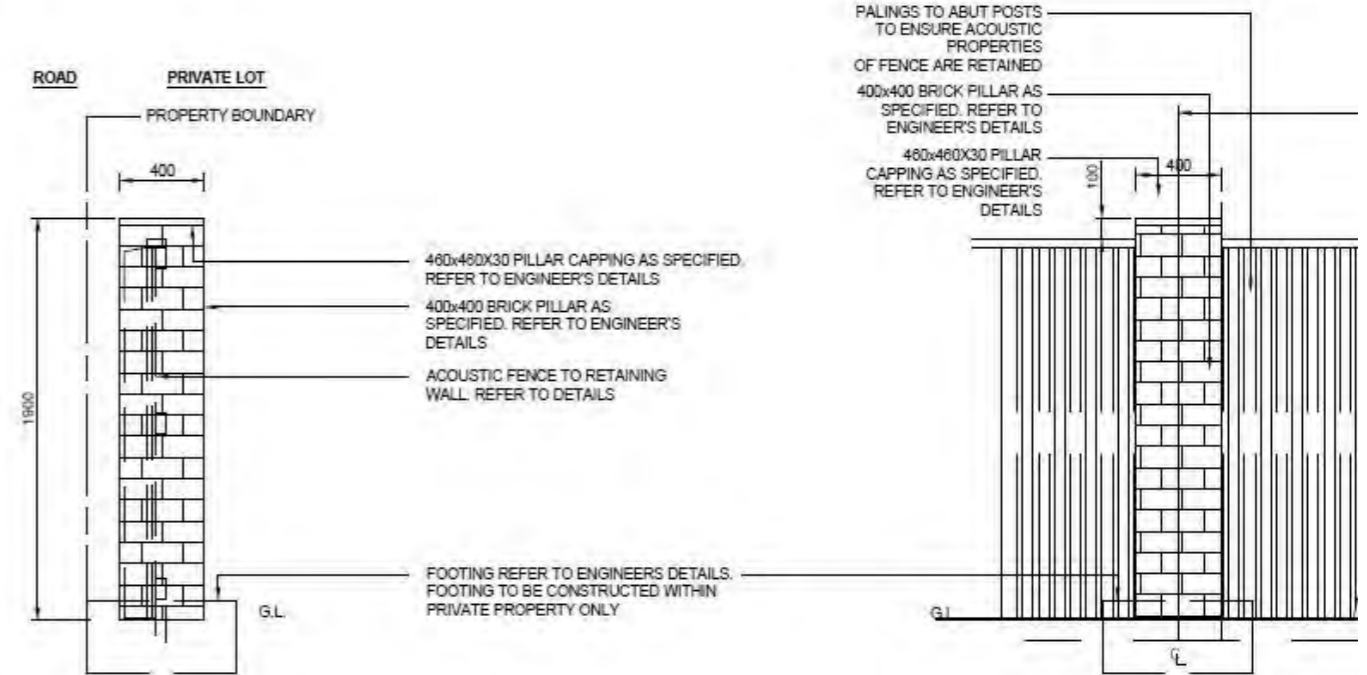

1900 High Pillar Detail

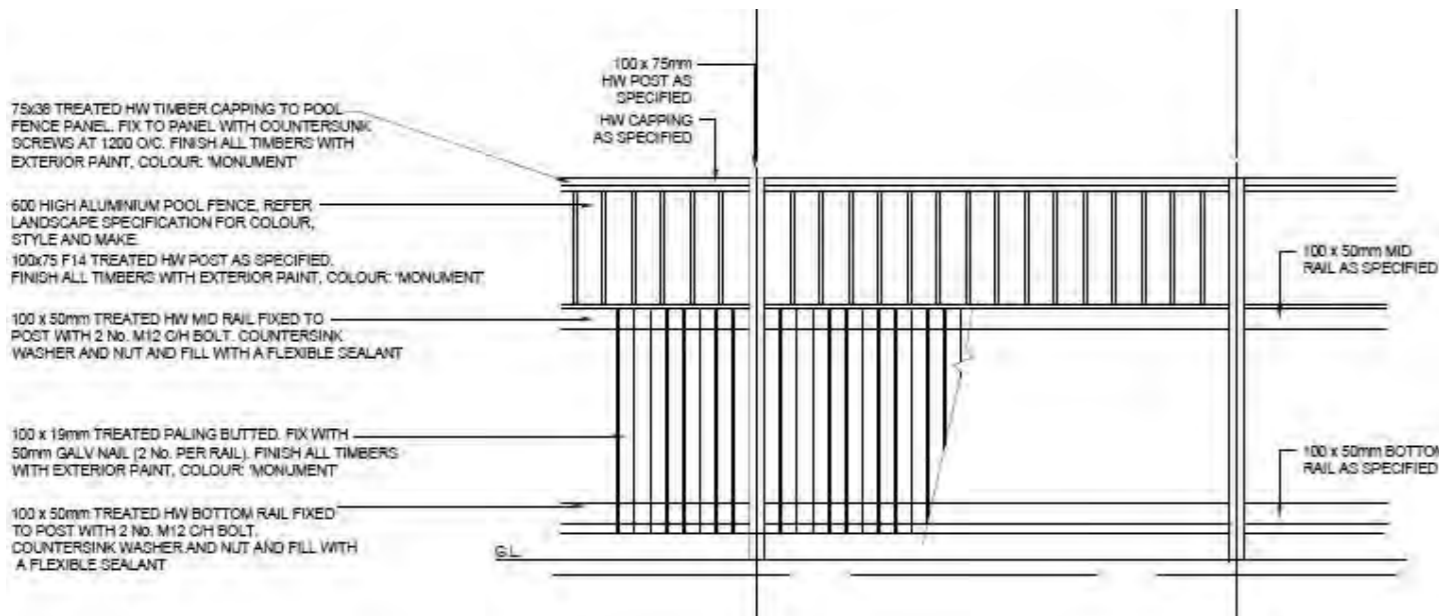

1800 High Open Space Semi-transparent fence

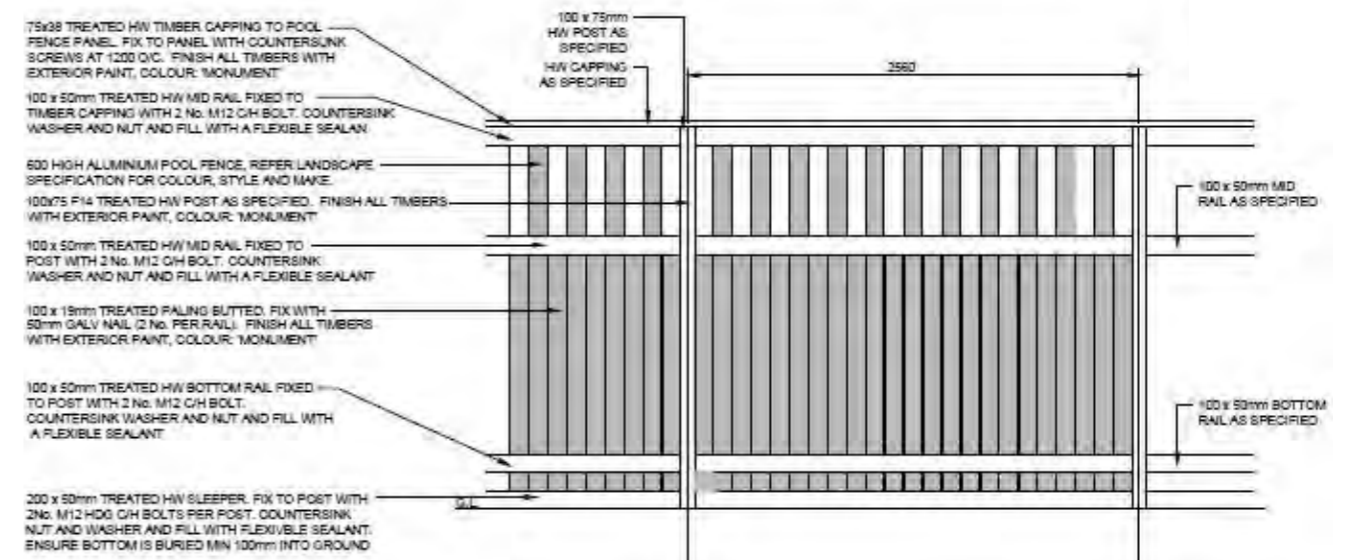

1800 High Side boundary Semi-transparent fence





Character

Character Imagery

Considered landscape embellishments will create a balance between formal and informal open space that is underpinned by large shade trees, fine timber detailing, stone features and vibrant activation spaces.

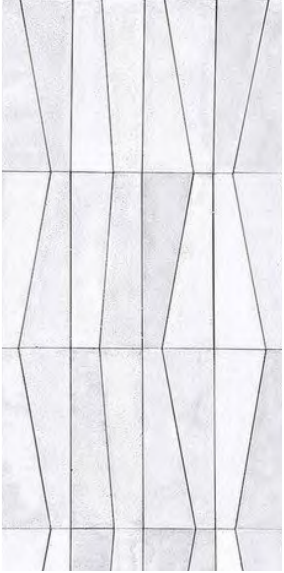

Planting Palette

An understanding of the land history creates an opportunity for contemporary design with an embedded cultural response. The planting palette features historical signature trees, complemented by Australian native shade trees and understorey planting representative of the local area.

Signature Tree



Araucaria cunninghamii

Trees



Acmena hemilampra



Tristaniopsis laurina 'luscious'



Waterhousea floribunda 'sweeper'

Feature Tree *



Ficus macrophylla

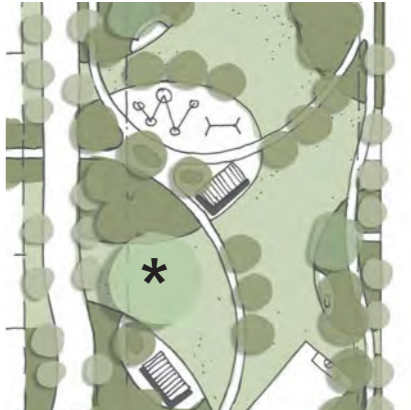

Shrubs

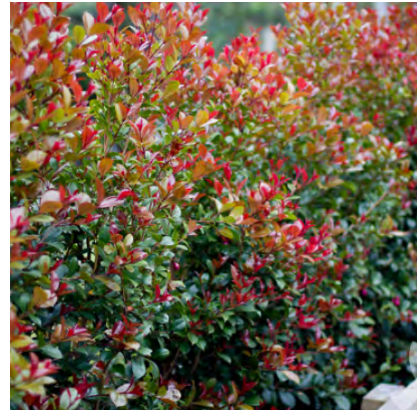

Syzygium resilience

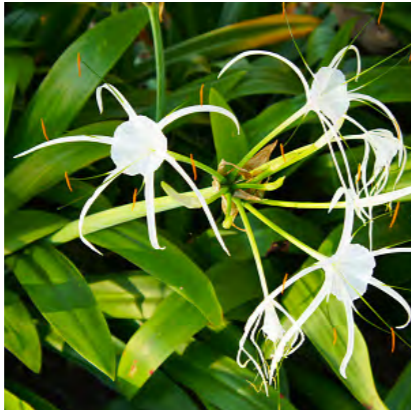

Hymenocallis littoralis



Lomandra 'Lime Tuff'



Philodendron xanadu

Understorey



Callistemon 'Little Jo' CITY OF MORETON BAY



Callistemon 'Firebrand'



Trachelospermum Jasminoides



Myoporum ellipticum



Sunshine Coast Studio

Level 1, 29 The Esplanade
Maroochydore
QLD 4558

Brisbane Studio

Level 8, 540 Wickham Street
Fortitude Valley
QLD 4006

