



**ADDITIONAL NOTES:**  
The LOT dimensions and area shown hereon are subject to final field survey and also to the requirements of Council and any other authority which may have requirements under any relevant legislation

Compaction of any fill material placed on this site shall be completed to level one inspection and testing services in accordance with AS3798-2007.

Copyright © Veris Australia Pty Ltd August 2025

**IMPORTANT NOTES:**  
(These notes are an integral part of this plan)  
This plan has been prepared for Lennium Group for the purposes of A Disclosure Plan Under the Land Sales Act 1984 (as amended).  
It is not to be used by any other person or corporation or for any other purposes and is subject to the following limitations:  
  
Please refer to the approved Development Application for conditions relating to the LOT and to approved Operational Works drawings for services location and possible easements.

**Data Sources**  
Cadastral Boundaries: 401871-LC01-P.dwg  
Engineering Design: X\_22-000082\_8\_BASE-20250812.dwg  
Final Surface Contours: 22-000082-5-12-Design-Contours-250mm-20250808.dwg  
Depth of Fill: 22-000082-5-12-depth-contour-0.1m-20250808.dwg  
Retaining Walls: X\_22-000082\_8\_BASE-20250812.dwg

B	Updated Engineering	12/08/2025	TEM
A	Original	6/02/2025	TEM
Issue	Revisions	Date	Drawn

Locality: Lillywood  
Local Authority: Moreton Bay C. C.  
Horizontal Meridian: MGA, Zone56  
Vertical Level Datum: AHD  
Scale: 1:250 @ A4  
Designed: Egis  
Drawn: TEM 6/02/2025  
Checked: DC  
Plot Date: 12 Aug, 2025  
**Computer File Ref:** 401871-S18-DP(B).dwg

DISCLOSURE PLAN  
of Proposed LOT 195  
being part of  
Lot 12  
on RP866105

**veris**

**BRISBANE**  
(07) 3666 4700

**WHITSUNDAYS**  
(07) 4945 6600

**MACKAY**  
(07) 4957 9700

**CAIRNS**  
(07) 4252 9400

veris.com.au  
ACN 615 735 727  
Veris Australia Pty Ltd

Drawing No	Issue
401871-DP 195	B

## LEGEND

Final surface contours based on A.H.D. datum at an interval of 0.5m,  
shown as: — 15.5 —

Where applicable, areas to be filled are shown as:

Depth of fill, in metres, shown as:- + 0.5

Retaining wall and retaining wall height, shown on the lower side of the wall, have been calculated from digital data supplied by Egis and shown as:

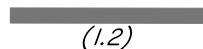



#### ADDITIONAL NOTES:

The LOT dimensions and area shown hereon are subject to final field survey and also to the requirements of Council and any other authority which may have requirements under any relevant legislation

Final surface contours shown hereon have been supplied by Egis.

Compaction of any fill material placed on this site shall be completed to level one inspection and testing services in accordance with AS3798-2007.

Depth of fill values are calculated to the lower of the pre-development surface and the ground surface from Survey.

Copyright © Veris Australia Pty Ltd August 2025

### Lilywood Landings Stage 8 For Lennium Group

#### IMPORTANT NOTES:

(These notes are an integral part of this plan)

This plan has been prepared for Lennium Group for the purposes of A Disclosure Plan Under the Land Sales Act 1984 (as amended).

It is not to be used by any other person or corporation or for any other purposes and is subject to the following limitations:

Please refer to the approved Development Application for conditions relating to the LOT and to approved Operational Works drawings for services location and possible easements.

THESE DESIGNS AND DRAWINGS ARE COPYRIGHT AND ARE NOT TO BE USED OR REPRODUCED WITHOUT THE WRITTEN PERMISSION OF VERIS

#### Data Sources

Cadastral Boundaries: 401871-LC01-P.dwg

Engineering Design: X\_22-000082\_8\_BASE-20250812.dwg

Final Surface Contours: 22-000082-5-12-Design-Contours-250mm-20250808.dwg

Depth of Fill: 22-000082-5-12-depth-contour-0.1m-20250808.dwg

Retaining Walls: X\_22-000082\_8\_BASE-20250812.dwg

X\_22-000082\_8\_BASE-20250812.dwg

B Updated Engineering 12/08/2025 TEM

A Original 6/02/2025 TEM

Issue Revisions Date Drawn

Locality: Lilywood

Local Authority: Moreton Bay C. C.

Horizontal Meridian: MGA, Zone56

Vertical Level Datum: AHD

Scale: 1:250 @ A4

Designed: Egis

Drawn: TEM 6/02/2025

Checked: DC

Plot Date: 12 Aug, 2025

Computer File Ref: 401871-S18-DP(B).dwg

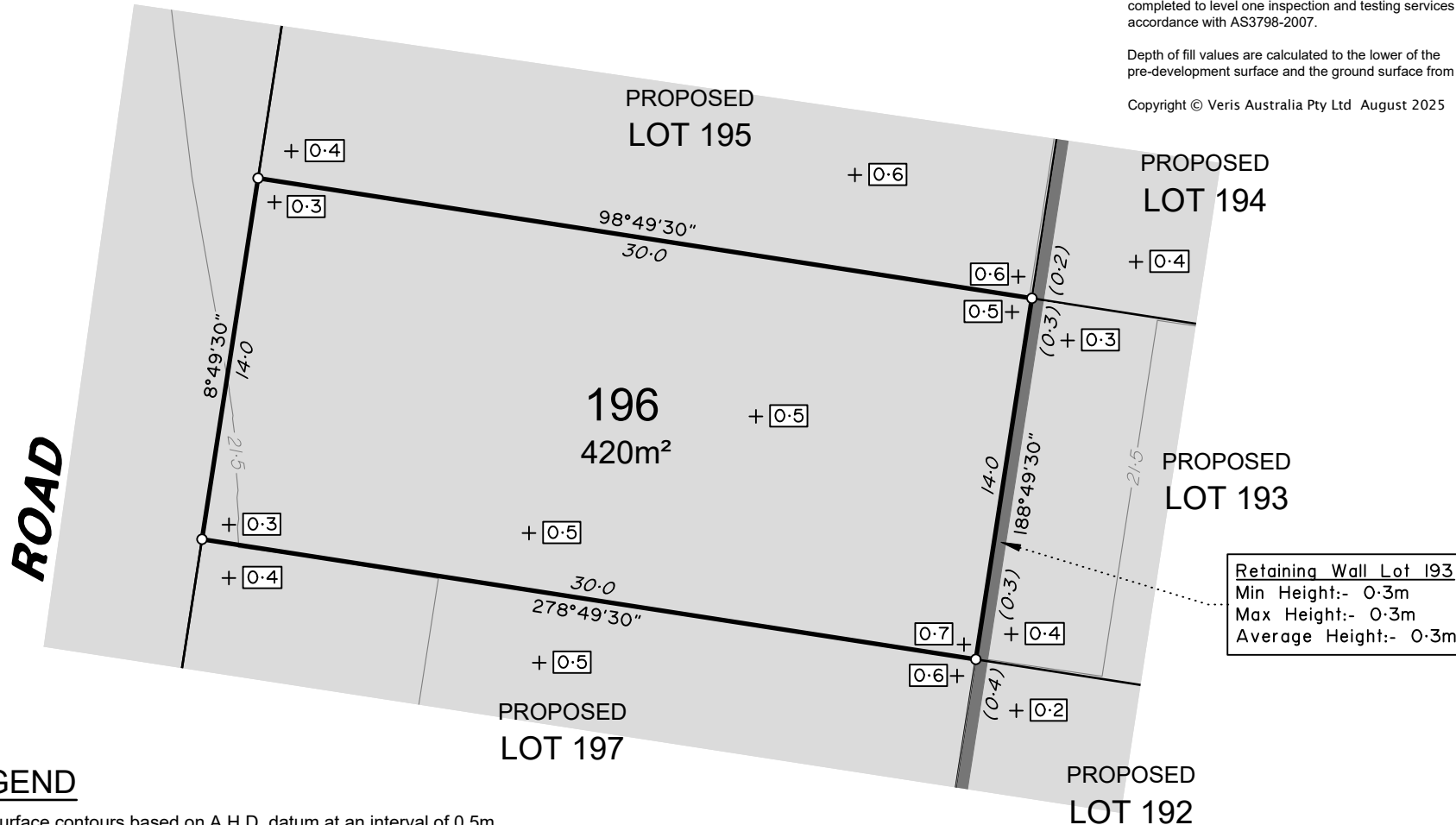

## LEGEND

Final surface contours based on A.H.D. datum at an interval of 0.5m, shown as: 15.5

Where applicable, areas to be filled are shown as:

Depth of fill, in metres, shown as:- +0.5

Retaining wall and retaining wall height, shown on the lower side of the wall, have been calculated from digital data supplied by Egis and shown as:

(1.2)

0 12.5m 50 mm 25m 100 mm 37.5m 150 mm SCALE BAR

Drawing No 401871-DP196 Issue B



ASHFORD CRESCENT

#### ADDITIONAL NOTES:

The LOT dimensions and area shown hereon are subject to final field survey and also to the requirements of Council and any other authority which may have requirements under any relevant legislation

Final surface contours shown hereon have been supplied by Egis.

Compaction of any fill material placed on this site shall be completed to level one inspection and testing services in accordance with AS3798-2007.

Depth of fill values are calculated to the lower of the pre-development surface and the ground surface from Survey.

Copyright © Veris Australia Pty Ltd August 2025

### Lilywood Landings Stage 8 For Lennium Group

#### IMPORTANT NOTES:

(These notes are an integral part of this plan)

This plan has been prepared for Lennium Group for the purposes of A Disclosure Plan Under the Land Sales Act 1984 (as amended).

It is not to be used by any other person or corporation or for any other purposes and is subject to the following limitations:

Please refer to the approved Development Application for conditions relating to the LOT and to approved Operational Works drawings for services location and possible easements.

THESE DESIGNS AND DRAWINGS ARE COPYRIGHT AND ARE NOT TO BE USED OR REPRODUCED WITHOUT THE WRITTEN PERMISSION OF VERIS

#### Data Sources

Cadastral Boundaries: 401871-LC01-P.dwg

Engineering Design: X\_22-000082\_8\_BASE-20250812.dwg

Final Surface Contours: 22-000082-5-12-Design-Contours-250mm-20250808.dwg

Depth of Fill: 22-000082-5-12-Depth-contour-0.1m-20250808.dwg

Retaining Walls: X\_22-000082\_8\_BASE-20250812.dwg

X\_22-000082\_8\_BASE-20250812.dwg

B Updated Engineering 12/08/2025 TEM

A Original 6/02/2025 TEM

Issue Revisions Date Drawn

Locality: Lilywood

Local Authority: Moreton Bay C. C.

Horizontal Meridian: MGA, Zone56

Vertical Level Datum: AHD

Scale: 1:250 @ A4

Designed: Egis

Drawn: TEM 6/02/2025

Checked: DC

Plot Date: 12 Aug, 2025

Computer File Ref: 401871-S18-DP(B).dwg

## LEGEND

Final surface contours based on A.H.D. datum at an interval of 0.5m, shown as: 15.5

Where applicable, areas to be filled are shown as:

Depth of fill, in metres, shown as:- +0.5

Retaining wall and retaining wall height, shown on the lower side of the wall, have been calculated from digital data supplied by Egis and shown as:

(1.2)

0 12.5m 50 mm 25m 100 mm 37.5m 150 mm SCALE BAR

PROPOSED  
LOT 193

PROPOSED  
LOT 192

PROPOSED  
LOT 191

PROPOSED  
LOT 196

197  
315m<sup>2</sup>

PROPOSED  
LOT 198

Retaining Wall Lot 192  
Min Height:- 0.4m  
Max Height:- 0.4m  
Average Height:- 0.4m

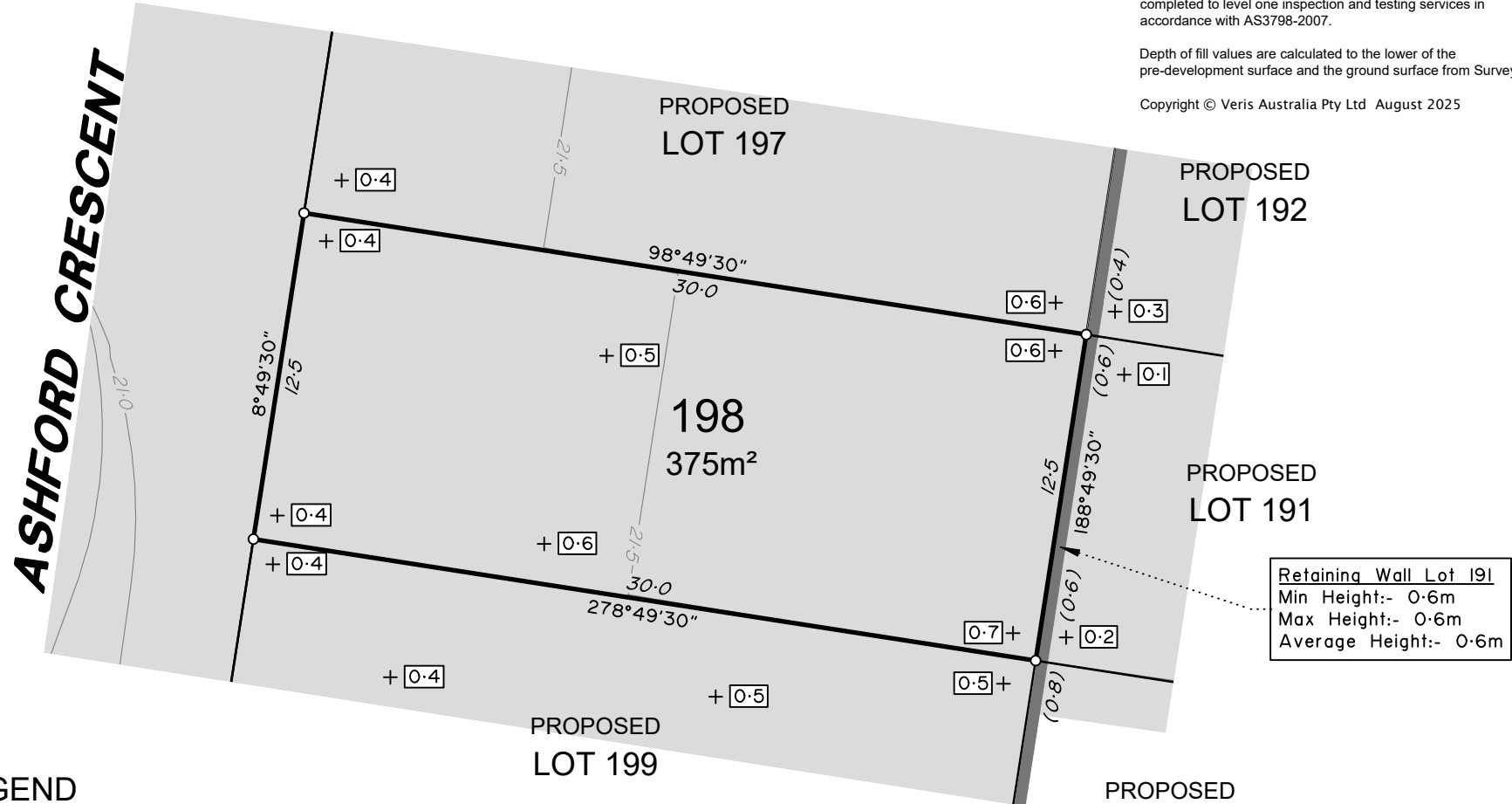

## LEGEND

Final surface contours based on A.H.D. datum at an interval of 0.5m, shown as:  15.5

Where applicable, areas to be filled are shown as: 

Depth of fill, in metres, shown as:- +[0.5]

Retaining wall and retaining wall height, shown on the lower side of the wall, have been calculated from digital data supplied by Egis and shown as: 

(1.2)

0 12.5m 50 mm 25m 100 mm 37.5m 150 mm SCALE BAR

### ADDITIONAL NOTES:

The LOT dimensions and area shown hereon are subject to final field survey and also to the requirements of Council and any other authority which may have requirements under any relevant legislation

Final surface contours shown hereon have been supplied by Egis.

Compaction of any fill material placed on this site shall be completed to level one inspection and testing services in accordance with AS3798-2007.

Depth of fill values are calculated to the lower of the pre-development surface and the ground surface from Survey.

Copyright © Veris Australia Pty Ltd August 2025

## Lilywood Landings Stage 8 For Lennium Group

### IMPORTANT NOTES:

(These notes are an integral part of this plan)

This plan has been prepared for Lennium Group for the purposes of A Disclosure Plan Under the Land Sales Act 1984 (as amended).

It is not to be used by any other person or corporation or for any other purposes and is subject to the following limitations:

Please refer to the approved Development Application for conditions relating to the LOT and to approved Operational Works drawings for services location and possible easements.

THESE DESIGNS AND DRAWINGS ARE COPYRIGHT AND ARE NOT TO BE USED OR REPRODUCED WITHOUT THE WRITTEN PERMISSION OF VERIS

### Data Sources

Cadastral Boundaries: 401871-LC01-P.dwg

Engineering Design: X\_22-000082\_8\_BASE-20250812.dwg

Final Surface Contours: 22-000082-5-12-Design-Contours-250mm-20250808.dwg

Depth of Fill: 22-000082-5-12-depth-contour-0.1m-20250808.dwg

Retaining Walls: X\_22-000082\_8\_BASE-20250812.dwg

Issue	Revisions	Date	Drawn
B	Updated Engineering	12/08/2025	TEM
A	Original	6/02/2025	TEM

Locality: Lilywood  
Local Authority: Moreton Bay C. C.  
Horizontal Meridian: MGA, Zone56  
Vertical Level Datum: AHD  
Scale: 1:250 @ A4  
Designed: Egis  
Drawn: TEM 6/02/2025  
Checked: DC  
Plot Date: 12 Aug, 2025  
Computer File Ref: 401871-S18-DP(B).dwg

DISCLOSURE PLAN  
of Proposed LOT 198  
being part of  
Lot 12  
on RP866105



# veris

BRISBANE WHITSUNDAYS  
(07) 3686 4700 (07) 4945 6600

MACKAY CAIRNS  
(07) 4957 9700 (07) 4252 9400

veris.com.au  
ACN 615 735 727  
Veris Australia Pty Ltd

Drawing No Issue  
401871-DP198 B

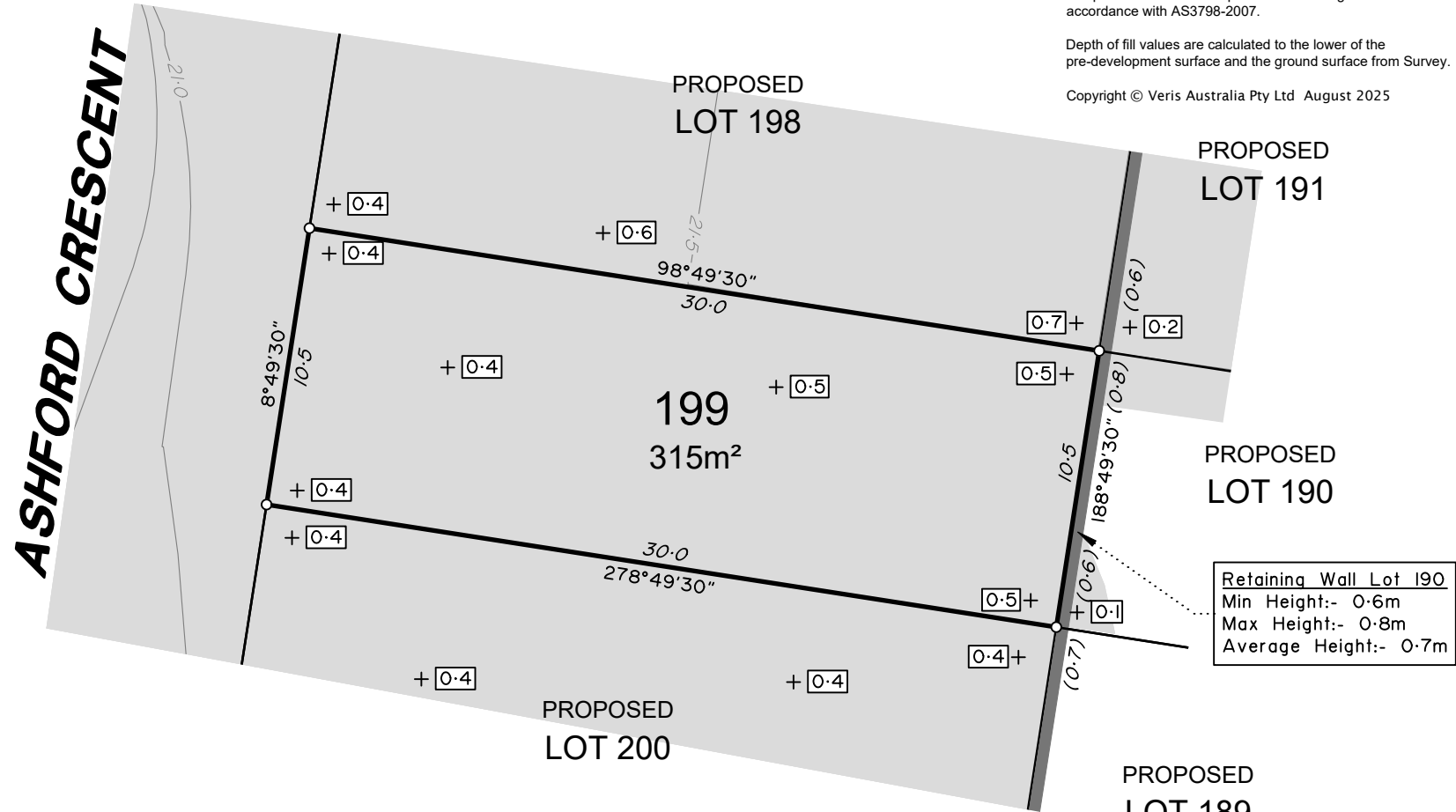

Final surface contours based on A.H.D. datum at an interval of 0.5m,  
shown as: — 15.5 —

□

Retaining wall and retaining wall height, shown on the lower side of the wall, have been calculated from digital data supplied by Egis and shown as:

(1.2)

Drawing No	Issue
401871-DP 199	B



ASHFORD CRESCENT

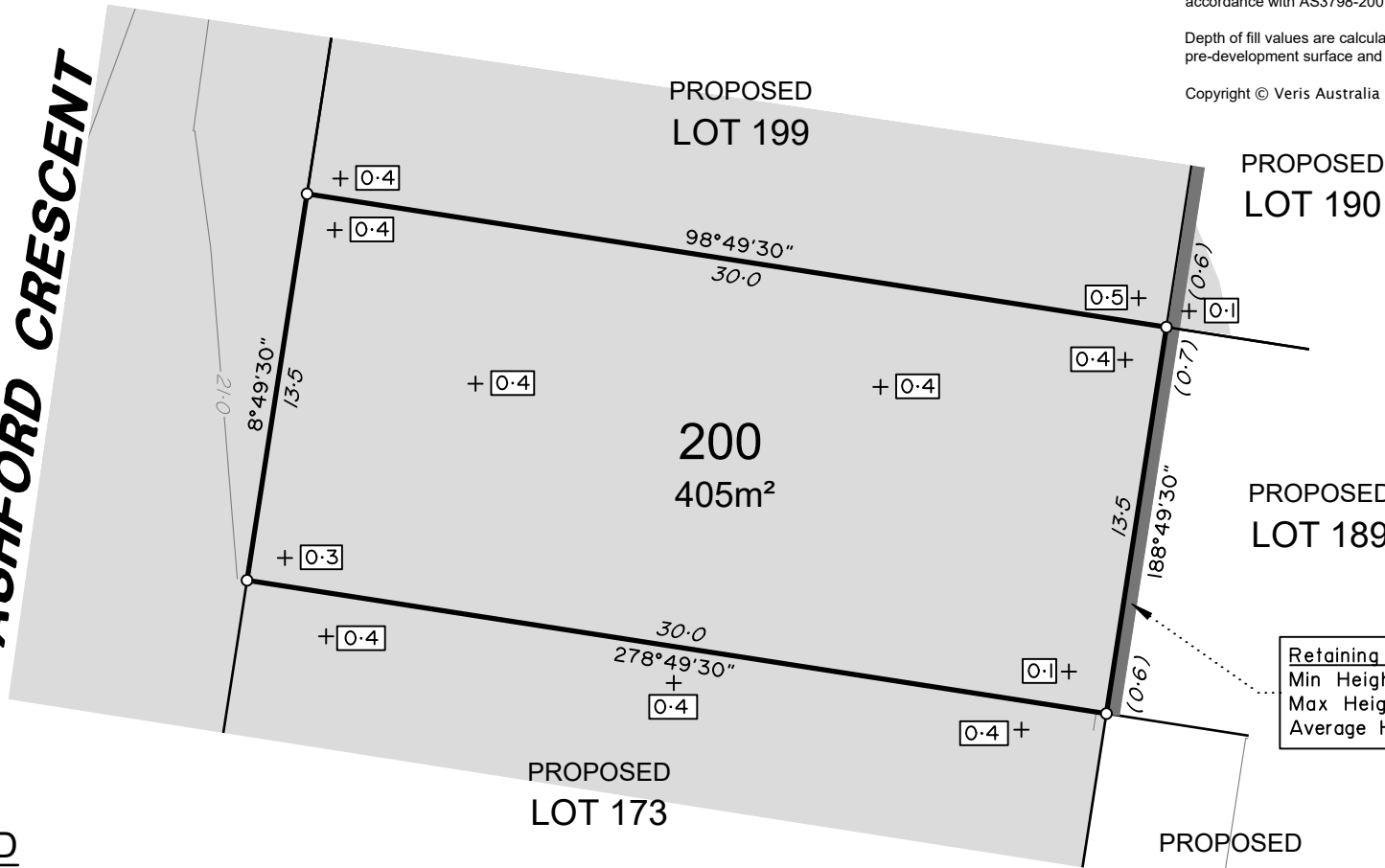

## LEGEND

Final surface contours based on A.H.D. datum at an interval of 0.5m, shown as: — 15.5 —

Where applicable, areas to be filled are shown as:

Depth of fill, in metres, shown as:- + 0.5

Retaining wall and retaining wall height, shown on the lower side of the wall, have been calculated from digital data supplied by Egis and shown as:

(1.2)

0 12.5m 50 mm 25m 100 mm 37.5m 150 mm SCALE BAR

### ADDITIONAL NOTES:

The LOT dimensions and area shown hereon are subject to final field survey and also to the requirements of Council and any other authority which may have requirements under any relevant legislation

Final surface contours shown hereon have been supplied by Egis.

Compaction of any fill material placed on this site shall be completed to level one inspection and testing services in accordance with AS3798-2007.

Depth of fill values are calculated to the lower of the pre-development surface and the ground surface from Survey.

Copyright © Veris Australia Pty Ltd August 2025

## Lilywood Landings Stage 8 For Lennium Group

### IMPORTANT NOTES:

(These notes are an integral part of this plan)

This plan has been prepared for Lennium Group for the purposes of A Disclosure Plan Under the Land Sales Act 1984 (as amended).

It is not to be used by any other person or corporation or for any other purposes and is subject to the following limitations:

Please refer to the approved Development Application for conditions relating to the LOT and to approved Operational Works drawings for services location and possible easements.

THESE DESIGNS AND DRAWINGS ARE COPYRIGHT AND ARE NOT TO BE USED OR REPRODUCED WITHOUT THE WRITTEN PERMISSION OF VERIS

### Data Sources

Cadastral Boundaries: 401871-LC01-P.dwg

Engineering Design: X\_22-000082\_8\_BASE-20250812.dwg

Final Surface Contours: 22-000082-5-12-Design-Contours-250mm-20250808.dwg

Depth of Fill: 22-000082-5-12-depth-contour-0.1m-20250808.dwg

Retaining Walls: X\_22-000082\_8\_BASE-20250812.dwg

Issue	Revisions	Date	Drawn
B	Updated Engineering	12/08/2025	TEM
A	Original	6/02/2025	TEM

Locality: Lilywood  
Local Authority: Moreton Bay C. C.  
Horizontal Meridian: MGA, Zone56  
Vertical Level Datum: AHD  
Scale: 1:250 @ A4  
Designed: Egis  
Drawn: TEM 6/02/2025  
Checked: DC  
Plot Date: 12 Aug, 2025  
Computer File Ref: 401871-S18-DP(B).dwg

DISCLOSURE PLAN  
of Proposed LOT 200  
being part of  
Lot 12  
on RP866105



veris

BRISBANE WHITSUNDAYS  
(07) 3686 4700 (07) 4945 6600

MACKAY CAIRNS  
(07) 4957 9700 (07) 4252 9400

veris.com.au  
ACN 615 735 727  
Veris Australia Pty Ltd

Drawing No Issue  
401871-DP200 B



# ASHFORD CRESCENT

PROPOSED  
LOT 202

PROPOSED  
LOT 151

PROPOSED  
LOT 152

201  
443m<sup>2</sup>

ASHFORD CRESCENT

Retaining Wall Lot 201  
Min Height:- 0.2m  
Max Height:- 0.6m  
Average Height:- 0.4m

Retaining Wall Lot 152  
Min Height:- 0.5m  
Max Height:- 0.5m  
Average Height:- 0.5m

## ADDITIONAL NOTES:

The LOT dimensions and area shown hereon are subject to final field survey and also to the requirements of Council and any other authority which may have requirements under any relevant legislation

Final surface contours shown hereon have been supplied by Egis.

Compaction of any fill material placed on this site shall be completed to level one inspection and testing services in accordance with AS3798-2007.

Depth of fill values are calculated to the lower of the pre-development surface and the ground surface from Survey.

Copyright © Veris Australia Pty Ltd August 2025

Lilywood Landings  
Stage 8  
For  
Lennium Group

## IMPORTANT NOTES:

(These notes are an integral part of this plan)

This plan has been prepared for Lennium Group for the purposes of A Disclosure Plan Under the Land Sales Act 1984 (as amended).

It is not to be used by any other person or corporation or for any other purposes and is subject to the following limitations:

Please refer to the approved Development Application for conditions relating to the LOT and to approved Operational Works drawings for services location and possible easements.

THESE DESIGNS AND DRAWINGS ARE COPYRIGHT AND ARE NOT TO BE USED OR REPRODUCED WITHOUT THE WRITTEN PERMISSION OF VERIS

## Data Sources

Cadastral Boundaries: 401871-LC01-P.dwg

Engineering Design: X\_22-000082\_8\_BASE-20250812.dwg

Final Surface Contours: 22-000082-5-12-Design-Contours-250mm-20250808.dwg

Depth of Fill: 22-000082-5-12-depth-contour-0.1m-20250808.dwg

Retaining Walls: X\_22-000082\_8\_BASE-20250812.dwg

Issue	Revisions	Date	Drawn
B	Updated Engineering	12/08/2025	TEM
A	Original	6/02/2025	TEM

Locality: Lilywood  
Local Authority: Moreton Bay C. C.  
Horizontal Meridian: MGA, Zone56  
Vertical Level Datum: AHD  
Scale: 1:250 @ A4  
Designed: Egis  
Drawn: TEM 6/02/2025  
Checked: DC  
Plot Date: 12 Aug, 2025  
Computer File Ref: 401871-S18-DP(B).dwg

DISCLOSURE PLAN  
of Proposed LOT 201  
being part of  
Lot 12  
on RP866105



veris

BRISBANE (07) 3666 4700 WHITSUNDAYS (07) 4945 6600

MACKAY (07) 4957 9700 CAIRNS (07) 4252 9400

veris.com.au  
ACN 615 735 727  
Veris Australia Pty Ltd

Drawing No 401871-DP201 Issue B

## LEGEND

Final surface contours based on A.H.D. datum at an interval of 0.5m, shown as: 15.5

Where applicable, areas to be filled are shown as:

Depth of fill, in metres, shown as:- +0.5

Retaining wall and retaining wall height, shown on the lower side of the wall, have been calculated from digital data supplied by Egis and shown as:

(1.2)

0 12.5m 50 mm 25m 100 mm 37.5m 150 mm SCALE BAR



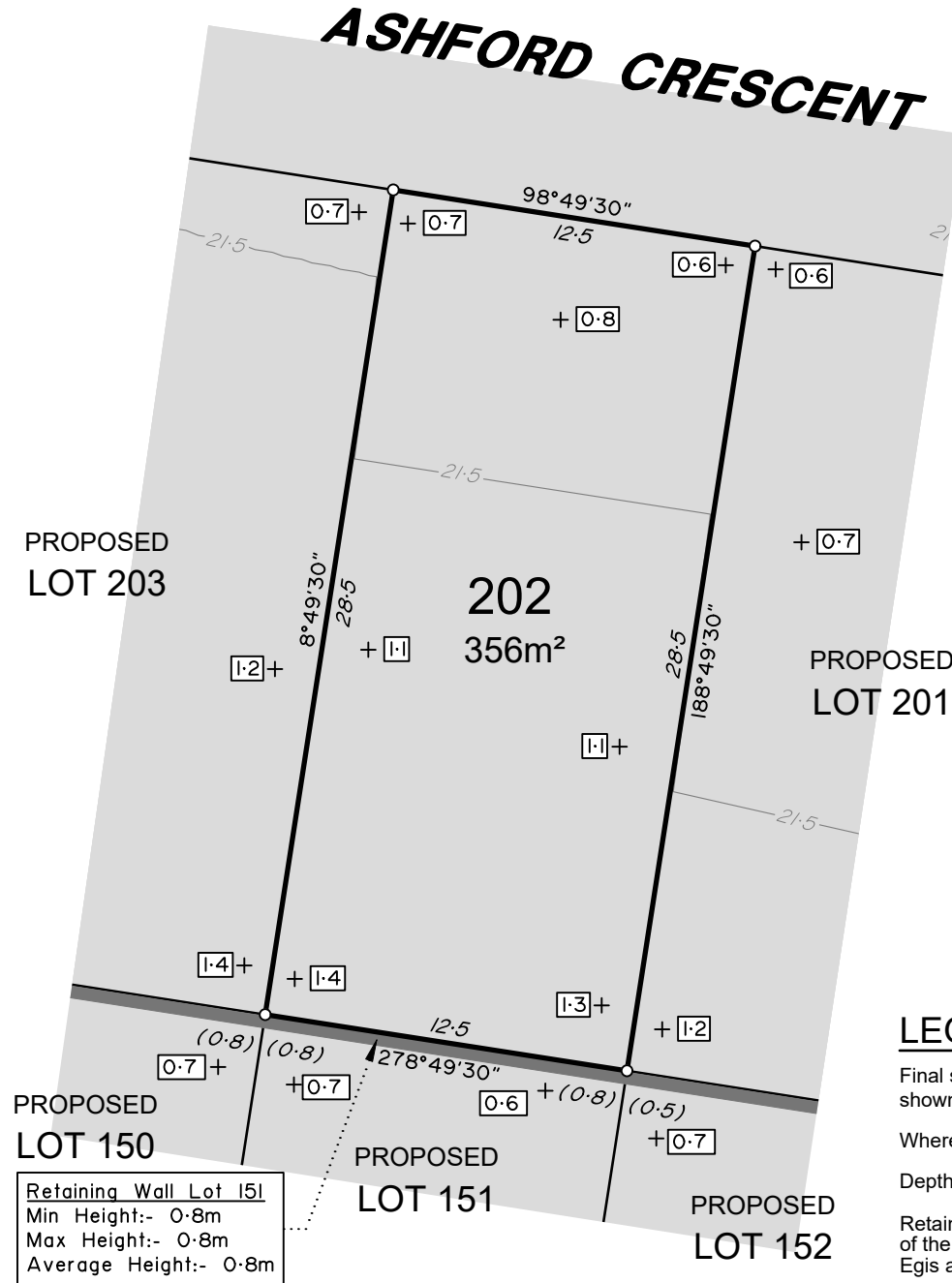

#### ADDITIONAL NOTES:

The LOT dimensions and area shown hereon are subject to final field survey and also to the requirements of Council and any other authority which may have requirements under any relevant legislation

Final surface contours shown hereon have been supplied by Egis.

Compaction of any fill material placed on this site shall be completed to level one inspection and testing services in accordance with AS3798-2007.

Depth of fill values are calculated to the lower of the pre-development surface and the ground surface from Survey.

Copyright © Veris Australia Pty Ltd August 2025

#### Lilywood Landings Stage 8 For Lennium Group

#### IMPORTANT NOTES:

(These notes are an integral part of this plan)

This plan has been prepared for Lennium Group for the purposes of A Disclosure Plan Under the Land Sales Act 1984 (as amended).

It is not to be used by any other person or corporation or for any other purposes and is subject to the following limitations:

Please refer to the approved Development Application for conditions relating to the LOT and to approved Operational Works drawings for services location and possible easements.

THESE DESIGNS AND DRAWINGS ARE COPYRIGHT AND ARE NOT TO BE USED OR REPRODUCED WITHOUT THE WRITTEN PERMISSION OF VERIS

#### Data Sources

Cadastral Boundaries: 401871-LC01-P.dwg

Engineering Design: X\_22-000082\_8\_BASE-20250812.dwg

Final Surface Contours: 22-000082-5-12-Design-Contours-250mm-20250808.dwg

Depth of Fill: 22-000082-5-12-Design-Contours-250mm-20250808.dwg

Retaining Walls: X\_22-000082\_8\_BASE-20250812.dwg

X\_22-000082\_8\_BASE-20250812.dwg

X\_22-000082\_8\_BASE-20250812.dwg

X\_22-000082\_8\_BASE-20250812.dwg

X\_22-000082\_8\_BASE-20250812.dwg

X\_22-000082\_8\_BASE-20250812.dwg

X\_22-000082\_8\_BASE-20250812.dwg

X\_22-000082\_8\_BASE-20250812.dwg

X\_22-000082\_8\_BASE-20250812.dwg

X\_22-000082\_8\_BASE-20250812.dwg

X\_22-000082\_8\_BASE-20250812.dwg

X\_22-000082\_8\_BASE-20250812.dwg

X\_22-000082\_8\_BASE-20250812.dwg

X\_22-000082\_8\_BASE-20250812.dwg

X\_22-000082\_8\_BASE-20250812.dwg

X\_22-000082\_8\_BASE-20250812.dwg

X\_22-000082\_8\_BASE-20250812.dwg

X\_22-000082\_8\_BASE-20250812.dwg

X\_22-000082\_8\_BASE-20250812.dwg

X\_22-000082\_8\_BASE-20250812.dwg

X\_22-000082\_8\_BASE-20250812.dwg

X\_22-000082\_8\_BASE-20250812.dwg

X\_22-000082\_8\_BASE-20250812.dwg

X\_22-000082\_8\_BASE-20250812.dwg

X\_22-000082\_8\_BASE-20250812.dwg

X\_22-000082\_8\_BASE-20250812.dwg

X\_22-000082\_8\_BASE-20250812.dwg

X\_22-000082\_8\_BASE-20250812.dwg

X\_22-000082\_8\_BASE-20250812.dwg

X\_22-000082\_8\_BASE-20250812.dwg

X\_22-000082\_8\_BASE-20250812.dwg

X\_22-000082\_8\_BASE-20250812.dwg

X\_22-000082\_8\_BASE-20250812.dwg

#### LEGEND

Final surface contours based on A.H.D. datum at an interval of 0.5m, shown as: — 15.5 —

Where applicable, areas to be filled are shown as: [shaded box]

Depth of fill, in metres, shown as:- +0.5

Retaining wall and retaining wall height, shown on the lower side of the wall, have been calculated from digital data supplied by Egis and shown as: [shaded box]

(1.2)

DISCLOSURE PLAN  
of Proposed LOT 202  
being part of  
Lot 12  
on RP866105



**veris**

BRISBANE WHITSUNDAYS  
(07) 3666 4700 (07) 4945 6600

MACKAY CAIRNS  
(07) 4957 9700 (07) 4252 9400

veris.com.au  
ACN 615 735 727  
Veris Australia Pty Ltd

Drawing No Issue  
401871-DP202 B



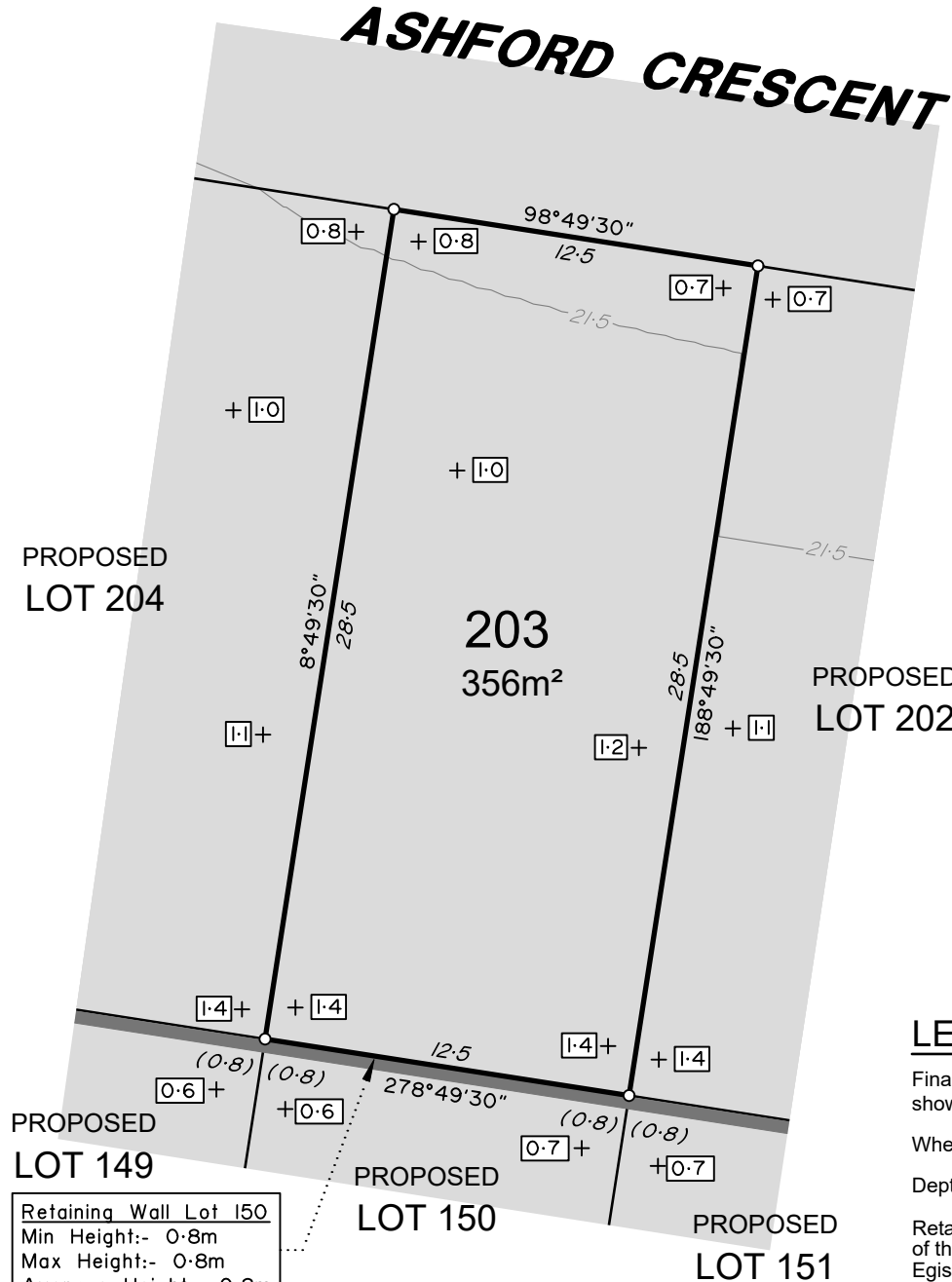

#### ADDITIONAL NOTES:

The LOT dimensions and area shown hereon are subject to final field survey and also to the requirements of Council and any other authority which may have requirements under any relevant legislation

Final surface contours shown hereon have been supplied by Egis.

Compaction of any fill material placed on this site shall be completed to level one inspection and testing services in accordance with AS3798-2007.

Depth of fill values are calculated to the lower of the pre-development surface and the ground surface from Survey.

Copyright © Veris Australia Pty Ltd August 2025

#### Lilywood Landings Stage 8 For Lennium Group

#### IMPORTANT NOTES:

(These notes are an integral part of this plan)

This plan has been prepared for Lennium Group for the purposes of A Disclosure Plan Under the Land Sales Act 1984 (as amended).

It is not to be used by any other person or corporation or for any other purposes and is subject to the following limitations:

Please refer to the approved Development Application for conditions relating to the LOT and to approved Operational Works drawings for services location and possible easements.

THESE DESIGNS AND DRAWINGS ARE COPYRIGHT AND ARE NOT TO BE USED OR REPRODUCED WITHOUT THE WRITTEN PERMISSION OF VERIS

#### Data Sources

Cadastral Boundaries: 401871-LC01-P.dwg

Engineering Design: X\_22-000082\_8\_BASE-20250812.dwg

Final Surface Contours: 22-000082-5-12-Design-Contours-250mm-20250808.dwg

Depth of Fill: 22-000082-5-12-depth-contour-0.1m-20250808.dwg

Retaining Walls: X\_22-000082\_8\_BASE-20250812.dwg

X\_22-000082\_8\_BASE-20250812.dwg

B Updated Engineering 12/08/2025 TEM

A Original 6/02/2025 TEM

Issue Revisions Date Drawn

Locality: Lilywood

Local Authority: Moreton Bay C. C.

Horizontal Meridian: MGA, Zone56

Vertical Level Datum: AHD

Scale: 1:250 @ A4

Designed: Egis

Drawn: TEM 6/02/2025

Checked: DC

Plot Date: 12 Aug, 2025

Computer File Ref: 401871-S18-DP(B).dwg

#### DISCLOSURE PLAN of Proposed LOT 203 being part of Lot 12 on RP866105



**veris**

BRISBANE (07) 3666 4700 WHITSUNDAYS (07) 4945 6600

MACKAY (07) 4957 9700 CAIRNS (07) 4252 9400

veris.com.au  
ACN 615 735 727  
Veris Australia Pty Ltd

Drawing No Issue  
401871-DP203 B

#### LEGEND

Final surface contours based on A.H.D. datum at an interval of 0.5m, shown as: — 15.5 —

Where applicable, areas to be filled are shown as: [shaded box]

Depth of fill, in metres, shown as:- +0.5

Retaining wall and retaining wall height, shown on the lower side of the wall, have been calculated from digital data supplied by Egis and shown as: [shaded box]

(1.2)

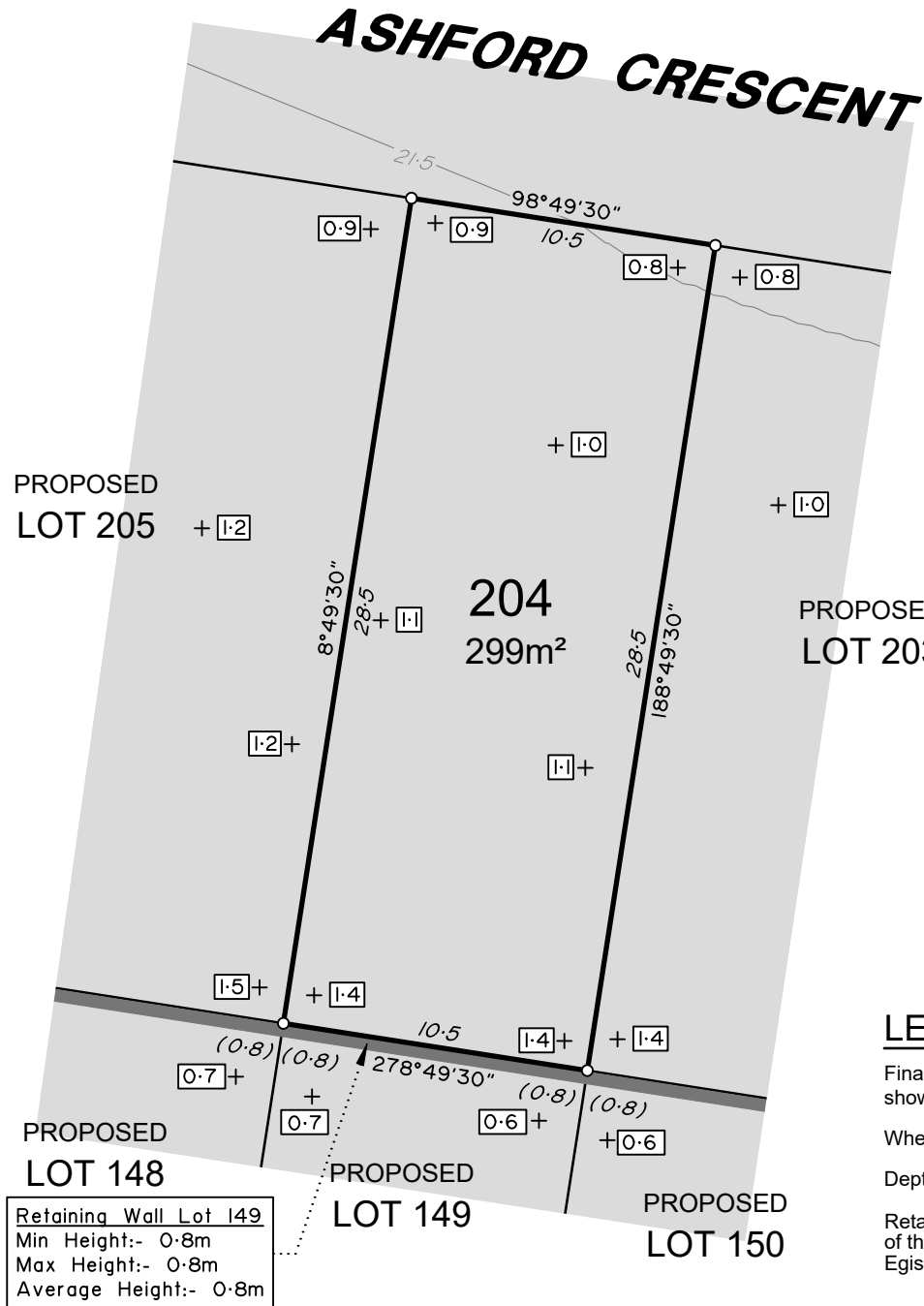

#### ADDITIONAL NOTES:

The LOT dimensions and area shown hereon are subject to final field survey and also to the requirements of Council and any other authority which may have requirements under any relevant legislation

Final surface contours shown hereon have been supplied by Egis.

Compaction of any fill material placed on this site shall be completed to level one inspection and testing services in accordance with AS3798-2007.

Depth of fill values are calculated to the lower of the pre-development surface and the ground surface from Survey.

Copyright © Veris Australia Pty Ltd August 2025

### Lilywood Landings Stage 8 For Lennium Group

#### IMPORTANT NOTES:

(These notes are an integral part of this plan)

This plan has been prepared for Lennium Group for the purposes of A Disclosure Plan Under the Land Sales Act 1984 (as amended).

It is not to be used by any other person or corporation or for any other purposes and is subject to the following limitations:

Please refer to the approved Development Application for conditions relating to the LOT and to approved Operational Works drawings for services location and possible easements.

THESE DESIGNS AND DRAWINGS ARE COPYRIGHT AND ARE NOT TO BE USED OR REPRODUCED WITHOUT THE WRITTEN PERMISSION OF VERIS

#### Data Sources

Cadastral Boundaries: 401871-LC01-P.dwg

Engineering Design: X\_22-000082\_8\_BASE-20250812.dwg

Final Surface Contours: 22-000082-5-12-Design-Contours-250mm-20250808.dwg

Depth of Fill: 22-000082-5-12-Design-Contours-250mm-20250808.dwg

Retaining Walls: X\_22-000082\_8\_BASE-20250812.dwg

X\_22-000082\_8\_BASE-20250812.dwg

B Updated Engineering 12/08/2025 TEM

A Original 6/02/2025 TEM

Issue Revisions Date Drawn

Locality: Lilywood

Local Authority: Moreton Bay C. C.

Horizontal Meridian: MGA, Zone56

Vertical Level Datum: AHD

Scale: 1:250 @ A4

Designed: Egis

Drawn: TEM 6/02/2025

Checked: DC

Plot Date: 12 Aug, 2025

Computer File Ref: 401871-S18-DP(B).dwg

### DISCLOSURE PLAN of Proposed LOT 204 being part of Lot 12 on RP866105



# veris

BRISBANE (07) 3666 4700 WHITSUNDAYS (07) 4945 6600

MACKAY (07) 4957 9700 CAIRNS (07) 4252 9400

veris.com.au  
ACN 615 735 727  
Veris Australia Pty Ltd

Drawing No 401871-DP204 Issue B

## LEGEND

Final surface contours based on A.H.D. datum at an interval of 0.5m, shown as: — 15.5 —

Where applicable, areas to be filled are shown as:

Depth of fill, in metres, shown as: +0.5

Retaining wall and retaining wall height, shown on the lower side of the wall, have been calculated from digital data supplied by Egis and shown as:

(1.2)

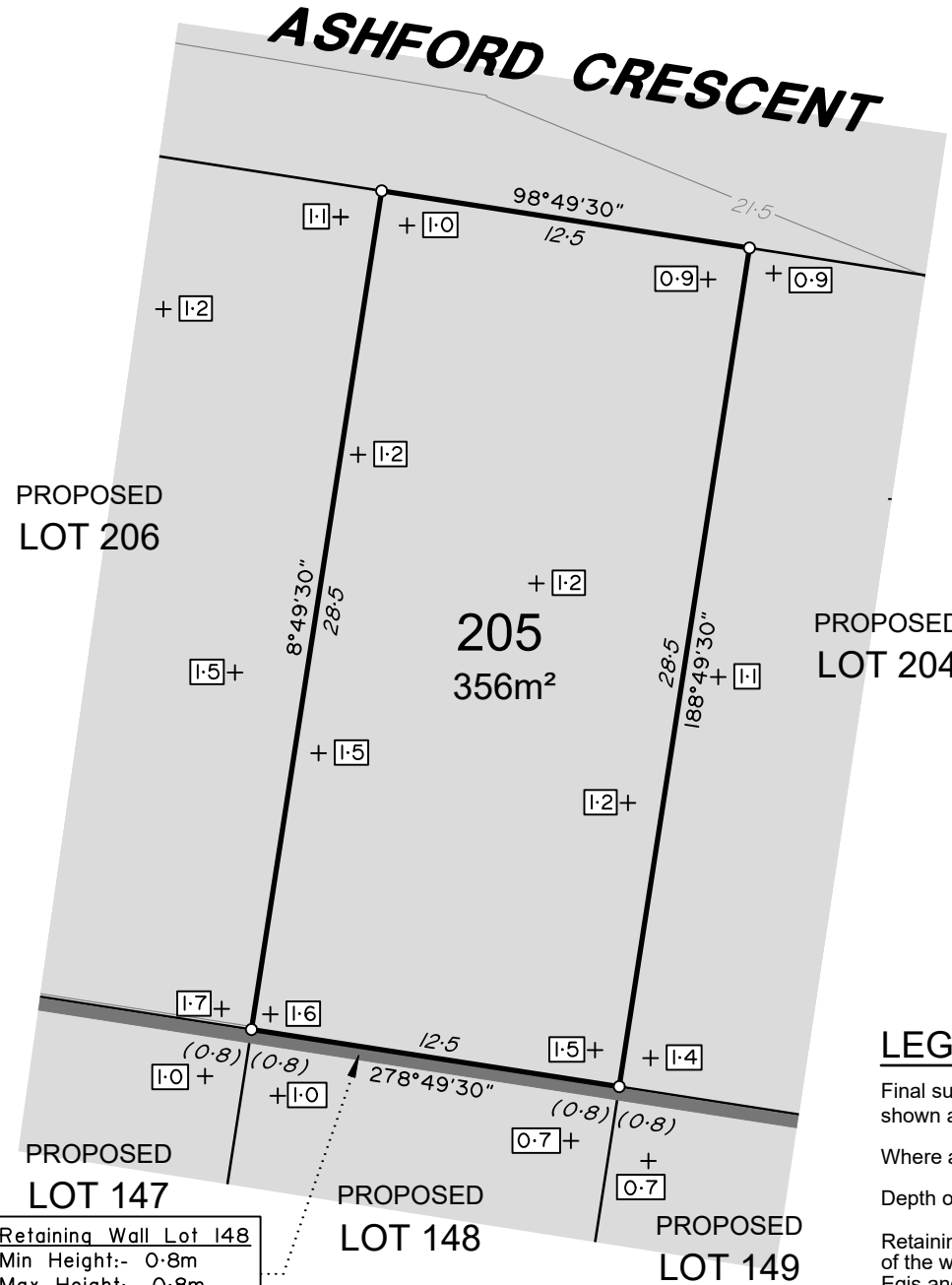

PROPOSED  
LOT 206

205  
356m<sup>2</sup>

PROPOSED  
LOT 204

PROPOSED  
LOT 147

PROPOSED  
LOT 148

PROPOSED  
LOT 149

Retaining Wall Lot 148  
Min Height:- 0.8m  
Max Height:- 0.8m  
Average Height:- 0.8m

## LEGEND

Final surface contours based on A.H.D. datum at an interval of 0.5m, shown as: 

Where applicable, areas to be filled are shown as: 

Depth of fill, in metres, shown as:- 

Retaining wall and retaining wall height, shown on the lower side of the wall, have been calculated from digital data supplied by Egis and shown as: 

### ADDITIONAL NOTES:

The LOT dimensions and area shown hereon are subject to final field survey and also to the requirements of Council and any other authority which may have requirements under any relevant legislation

Final surface contours shown hereon have been supplied by Egis.

Compaction of any fill material placed on this site shall be completed to level one inspection and testing services in accordance with AS3798-2007.

Depth of fill values are calculated to the lower of the pre-development surface and the ground surface from Survey.

Copyright © Veris Australia Pty Ltd August 2025

Lilywood Landings  
Stage 8  
For  
Lennium Group

### IMPORTANT NOTES:

(These notes are an integral part of this plan)

This plan has been prepared for Lennium Group for the purposes of A Disclosure Plan Under the Land Sales Act 1984 (as amended).

It is not to be used by any other person or corporation or for any other purposes and is subject to the following limitations:

Please refer to the approved Development Application for conditions relating to the LOT and to approved Operational Works drawings for services location and possible easements.

THESE DESIGNS AND DRAWINGS ARE COPYRIGHT AND ARE NOT TO BE USED OR REPRODUCED WITHOUT THE WRITTEN PERMISSION OF VERIS

### Data Sources

Cadastral Boundaries: 401871-LC01-P.dwg

Engineering Design: X\_22-000082\_8\_BASE-20250812.dwg

Final Surface Contours: 22-000082-5-12-Design-Contours-250mm-20250808.dwg

Depth of Fill: 22-000082-5-12-depth-contour-0.1m-20250808.dwg

Retaining Walls: X\_22-000082\_8\_BASE-20250812.dwg

Issue	Revisions	Date	Drawn
B	Updated Engineering	12/08/2025	TEM
A	Original	6/02/2025	TEM

Locality: Lilywood  
Local Authority: Moreton Bay C. C.  
Horizontal Meridian: MGA, Zone56  
Vertical Level Datum: AHD  
Scale: 1:250 @ A4  
Designed: Egis  
Drawn: TEM 6/02/2025  
Checked: DC  
Plot Date: 12 Aug, 2025  
Computer File Ref: 401871-S18-DP(B).dwg

DISCLOSURE PLAN  
of Proposed LOT 205  
being part of  
Lot 12  
on RP866105



**veris**

BRISBANE (07) 3666 4700 WHITSUNDAYS (07) 4945 6600

MACKAY (07) 4957 9700 CAIRNS (07) 4252 9400

veris.com.au  
ACN 615 735 727  
Veris Australia Pty Ltd

Drawing No 401871-DP205 Issue B

0 12.5m 50 mm 25m 100 mm 37.5m 150 mm SCALE BAR

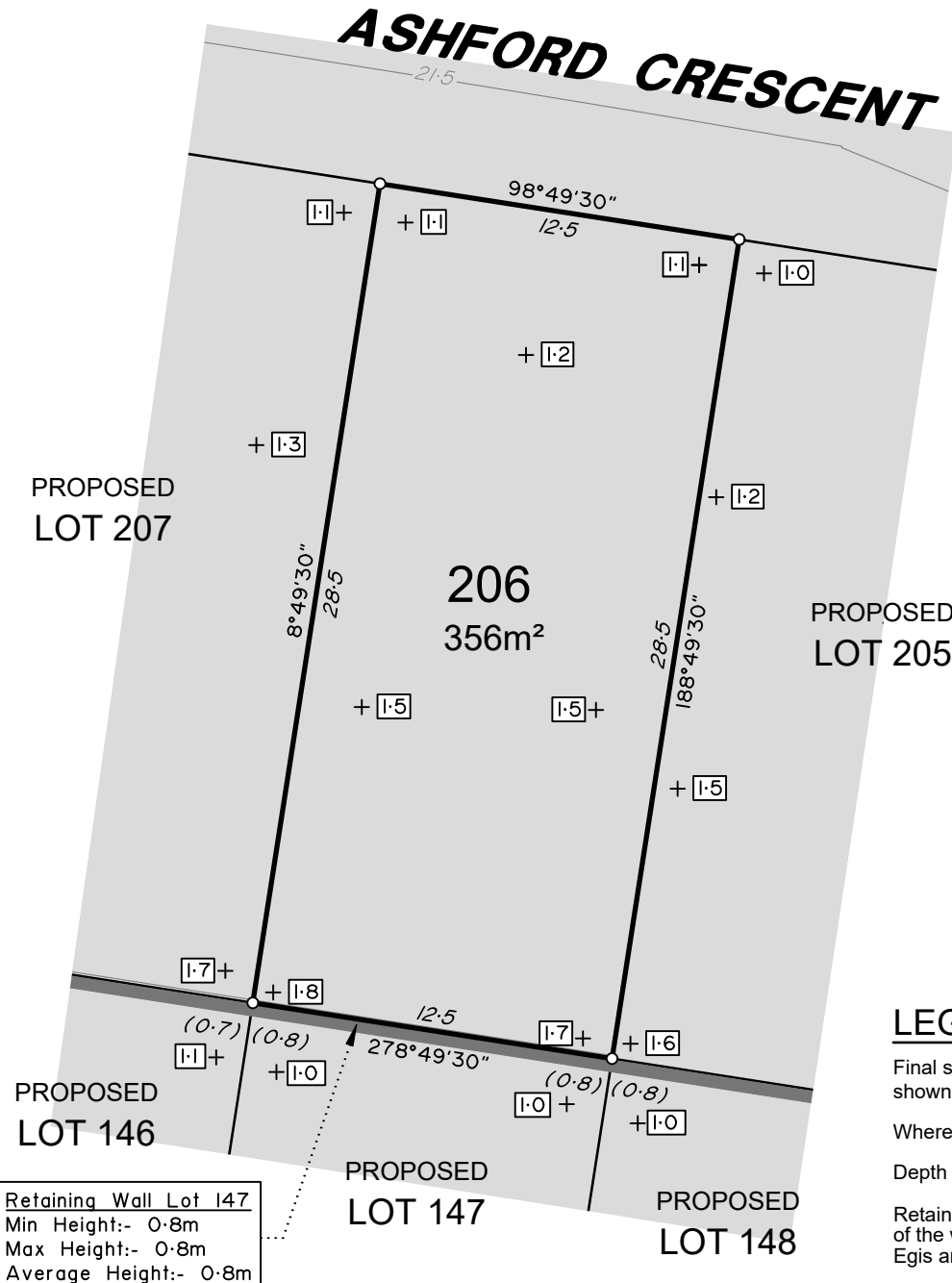

Retaining Wall Lot 147  
Min Height:- 0.8m  
Max Height:- 0.8m  
Average Height:- 0.8m



#### ADDITIONAL NOTES:

The LOT dimensions and area shown hereon are subject to final field survey and also to the requirements of Council and any other authority which may have requirements under any relevant legislation

Final surface contours shown hereon have been supplied by Egis.

Compaction of any fill material placed on this site shall be completed to level one inspection and testing services in accordance with AS3798-2007.

Depth of fill values are calculated to the lower of the pre-development surface and the ground surface from Survey.

Copyright © Veris Australia Pty Ltd August 2025

#### LEGEND

Final surface contours based on A.H.D. datum at an interval of 0.5m, shown as: — 15.5 —

Where applicable, areas to be filled are shown as:

Depth of fill, in metres, shown as:- +0.5

Retaining wall and retaining wall height, shown on the lower side of the wall, have been calculated from digital data supplied by Egis and shown as:

(1.2)

#### Lilywood Landings Stage 8 For Lennium Group

#### IMPORTANT NOTES:

(These notes are an integral part of this plan)

This plan has been prepared for Lennium Group for the purposes of A Disclosure Plan Under the Land Sales Act 1984 (as amended).

It is not to be used by any other person or corporation or for any other purposes and is subject to the following limitations:

Please refer to the approved Development Application for conditions relating to the LOT and to approved Operational Works drawings for services location and possible easements.

THESE DESIGNS AND DRAWINGS ARE COPYRIGHT AND ARE NOT TO BE USED OR REPRODUCED WITHOUT THE WRITTEN PERMISSION OF VERIS

#### Data Sources

Cadastral Boundaries: 401871-LC01-P.dwg

Engineering Design: X\_22-000082\_8\_BASE-20250812.dwg

Final Surface Contours: 22-000082-5-12-Design-Contours-250mm-20250808.dwg

Depth of Fill: 22-000082-5-12-Design-Contours-250mm-20250808.dwg

Retaining Walls: X\_22-000082\_8\_BASE-20250812.dwg

Issue	Revisions	Date	Drawn
B	Updated Engineering	12/08/2025	TEM
A	Original	6/02/2025	TEM

Locality: Lilywood  
Local Authority: Moreton Bay C. C.  
Horizontal Meridian: MGA, Zone56  
Vertical Level Datum: AHD  
Scale: 1:250 @ A4  
Designed: Egis  
Drawn: TEM 6/02/2025  
Checked: DC  
Plot Date: 12 Aug, 2025  
Computer File Ref: 401871-S18-DP(B).dwg

DISCLOSURE PLAN  
of Proposed LOT 206  
being part of  
Lot 12  
on RP866105



veris

BRISBANE (07) 3666 4700 WHITSUNDAYS (07) 4945 6600

MACKAY (07) 4957 9700 CAIRNS (07) 4252 9400

veris.com.au  
ACN 615 735 727  
Veris Australia Pty Ltd

Drawing No 401871-DP206 Issue B

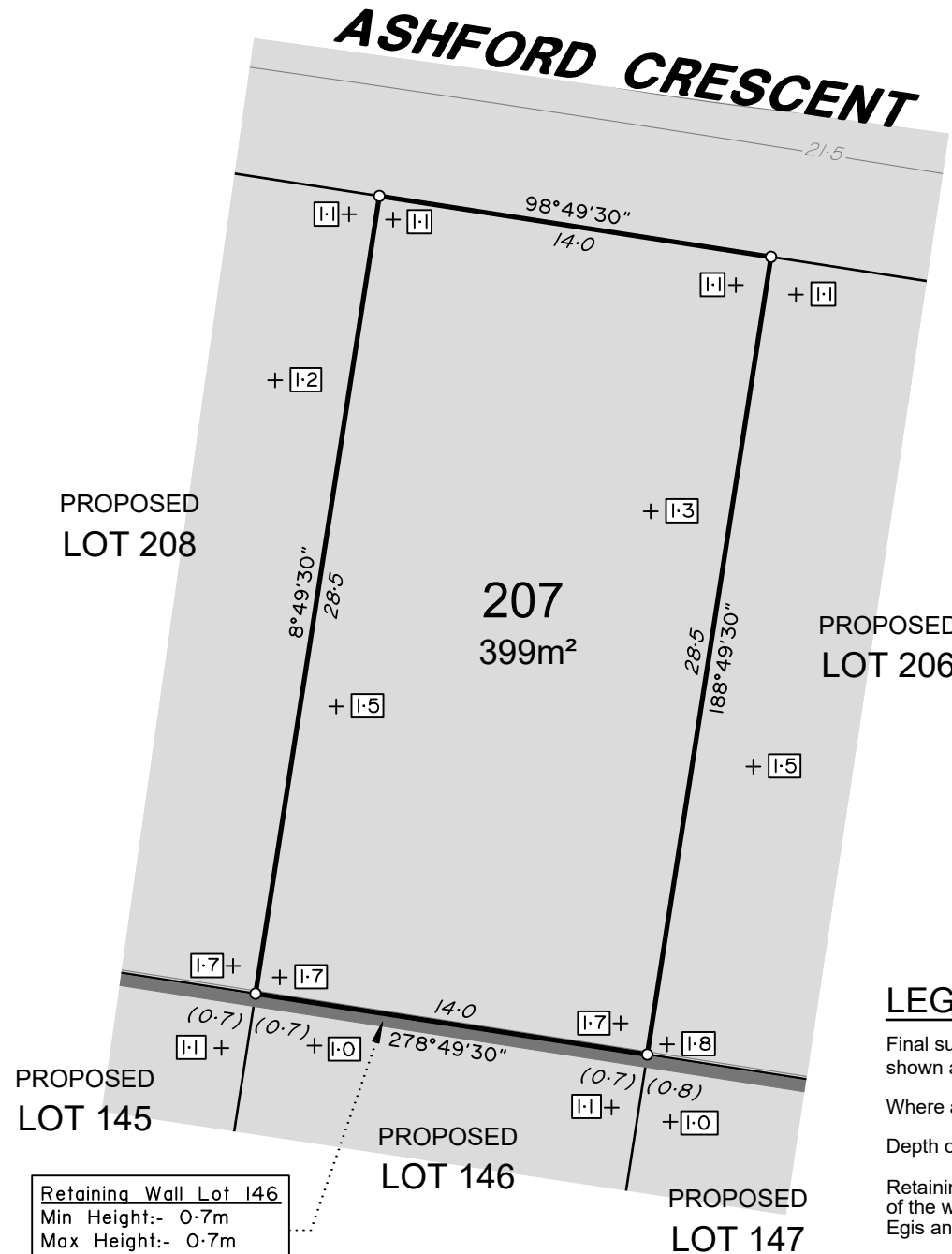

#### ADDITIONAL NOTES:

The LOT dimensions and area shown hereon are subject to final field survey and also to the requirements of Council and any other authority which may have requirements under any relevant legislation

Final surface contours shown hereon have been supplied by Egis.

Compaction of any fill material placed on this site shall be completed to level one inspection and testing services in accordance with AS3798-2007.

Depth of fill values are calculated to the lower of the pre-development surface and the ground surface from Survey.

Copyright © Veris Australia Pty Ltd August 2025

#### Lilywood Landings Stage 8 For Lennium Group

#### IMPORTANT NOTES:

(These notes are an integral part of this plan)

This plan has been prepared for Lennium Group for the purposes of A Disclosure Plan Under the Land Sales Act 1984 (as amended).

It is not to be used by any other person or corporation or for any other purposes and is subject to the following limitations:

Please refer to the approved Development Application for conditions relating to the LOT and to approved Operational Works drawings for services location and possible easements.

THESE DESIGNS AND DRAWINGS ARE COPYRIGHT AND ARE NOT TO BE USED OR REPRODUCED WITHOUT THE WRITTEN PERMISSION OF VERIS

#### Data Sources

Cadastral Boundaries: 401871-LC01-P.dwg

Engineering Design: X\_22-000082\_8\_BASE-20250812.dwg

Final Surface Contours: 22-000082-5-12-Design-Contours-250mm-20250808.dwg

Depth of Fill: 22-000082-5-12-depth-contour-0.1m-20250808.dwg

Retaining Walls: X\_22-000082\_8\_BASE-20250812.dwg

Issue	Revisions	Date	Drawn
B	Updated Engineering	12/08/2025	TEM
A	Original	6/02/2025	TEM

Locality: Lilywood  
Local Authority: Moreton Bay C. C.  
Horizontal Meridian: MGA, Zone56  
Vertical Level Datum: AHD  
Scale: 1:250 @ A4  
Designed: Egis  
Drawn: TEM 6/02/2025  
Checked: DC  
Plot Date: 12 Aug, 2025  
Computer File Ref: 401871-S18-DP(B).dwg

#### DISCLOSURE PLAN of Proposed LOT 207 being part of Lot 12 on RP866105



**veris**

BRISBANE (07) 3666 4700 WHITSUNDAYS (07) 4945 6600

MACKAY (07) 4957 9700 CAIRNS (07) 4252 9400

veris.com.au  
ACN 615 735 727  
Veris Australia Pty Ltd

Drawing No 401871-DP207 Issue B

#### LEGEND

Final surface contours based on A.H.D. datum at an interval of 0.5m, shown as: 15.5

Where applicable, areas to be filled are shown as:

Depth of fill, in metres, shown as:- +0.5

Retaining wall and retaining wall height, shown on the lower side of the wall, have been calculated from digital data supplied by Egis and shown as:

(1.2)



Retaining Wall Lot 208  
Min Height:- 0.3m  
Max Height:- 0.3m  
Average Height:- 0.3m

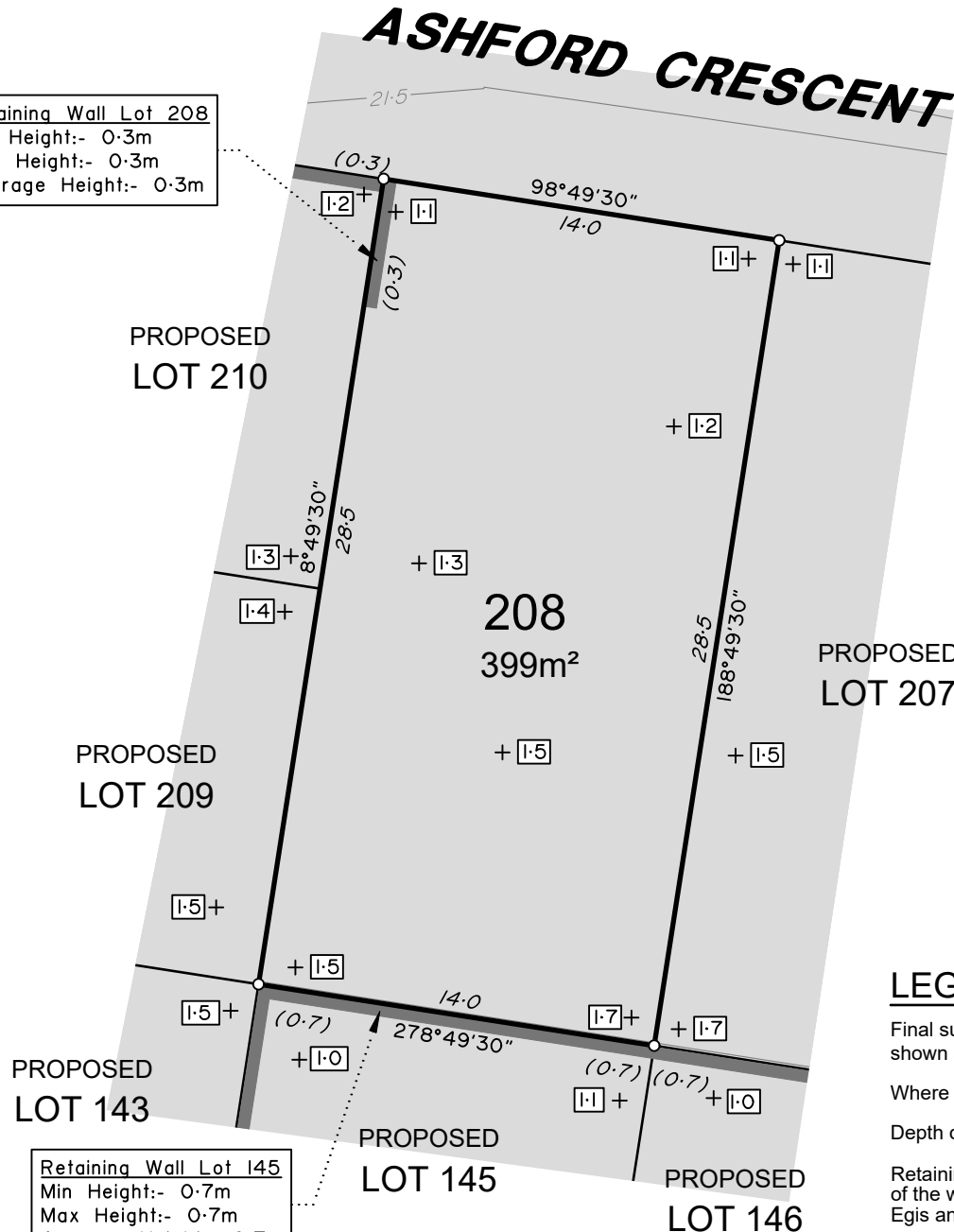

Retaining Wall Lot 145  
Min Height:- 0.7m  
Max Height:- 0.7m  
Average Height:- 0.7m

#### ADDITIONAL NOTES:

The LOT dimensions and area shown hereon are subject to final field survey and also to the requirements of Council and any other authority which may have requirements under any relevant legislation

Final surface contours shown hereon have been supplied by Egis.

Compaction of any fill material placed on this site shall be completed to level one inspection and testing services in accordance with AS3798-2007.

Depth of fill values are calculated to the lower of the pre-development surface and the ground surface from Survey.

Copyright © Veris Australia Pty Ltd August 2025

### Lilywood Landings Stage 8 For Lennium Group

#### IMPORTANT NOTES:

(These notes are an integral part of this plan)

This plan has been prepared for Lennium Group for the purposes of A Disclosure Plan Under the Land Sales Act 1984 (as amended).

It is not to be used by any other person or corporation or for any other purposes and is subject to the following limitations:

Please refer to the approved Development Application for conditions relating to the LOT and to approved Operational Works drawings for services location and possible easements.

THESE DESIGNS AND DRAWINGS ARE COPYRIGHT AND ARE NOT TO BE USED OR REPRODUCED WITHOUT THE WRITTEN PERMISSION OF VERIS

#### Data Sources

Cadastral Boundaries: 401871-LC01-P.dwg

Engineering Design: X\_22-000082\_8\_BASE-20250812.dwg

Final Surface Contours: 22-000082-5-12-Design-Contours-250mm-20250808.dwg

Depth of Fill: 22-000082-5-12-depth-contour-0.1m-20250808.dwg

Retaining Walls: X\_22-000082\_8\_BASE-20250812.dwg

Issue	Revisions	Date	Drawn
B	Updated Engineering	12/08/2025	TEM
A	Original	6/02/2025	TEM

Locality: Lilywood  
Local Authority: Moreton Bay C. C.  
Horizontal Meridian: MGA, Zone56  
Vertical Level Datum: AHD  
Scale: 1:250 @ A4  
Designed: Egis  
Drawn: TEM 6/02/2025  
Checked: DC  
Plot Date: 12 Aug, 2025  
Computer File Ref: 401871-S18-DP(B).dwg

DISCLOSURE PLAN  
of Proposed LOT 208  
being part of  
Lot 12  
on RP866105



**veris**

BRISBANE (07) 3666 4700 WHITSUNDAYS (07) 4945 6600

MACKAY (07) 4957 9700 CAIRNS (07) 4252 9400

veris.com.au  
ACN 615 735 727  
Veris Australia Pty Ltd

Drawing No 401871-DP208 Issue B

## LEGEND

Final surface contours based on A.H.D. datum at an interval of 0.5m, shown as: 15.5

Where applicable, areas to be filled are shown as:

Depth of fill, in metres, shown as:- +0.5

Retaining wall and retaining wall height, shown on the lower side of the wall, have been calculated from digital data supplied by Egis and shown as:

(1.2)



ASHFORD CRESCENT

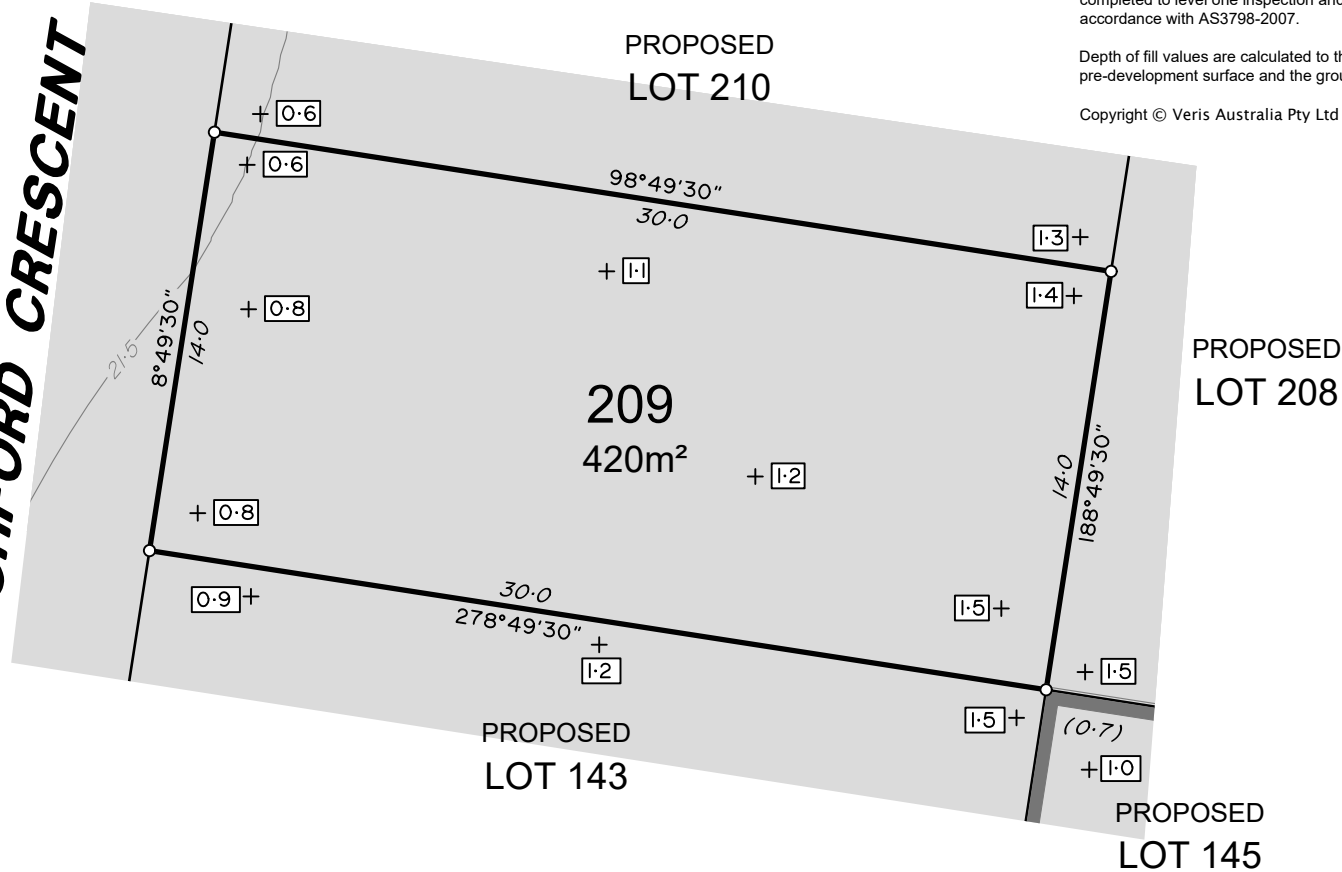

## LEGEND

Final surface contours based on A.H.D. datum at an interval of 0.5m, shown as: — 15.5 —

Where applicable, areas to be filled are shown as:

Depth of fill, in metres, shown as: + 0.5

Retaining wall and retaining wall height, shown on the lower side of the wall, have been calculated from digital data supplied by Egis and shown as:

(1.2)

0 12.5m 50 mm 25m 100 mm 37.5m 150 mm SCALE BAR

### ADDITIONAL NOTES:

The LOT dimensions and area shown hereon are subject to final field survey and also to the requirements of Council and any other authority which may have requirements under any relevant legislation

Final surface contours shown hereon have been supplied by Egis.

Compaction of any fill material placed on this site shall be completed to level one inspection and testing services in accordance with AS3798-2007.

Depth of fill values are calculated to the lower of the pre-development surface and the ground surface from Survey.

Copyright © Veris Australia Pty Ltd August 2025

## Lilywood Landings Stage 8 For Lennium Group

### IMPORTANT NOTES:

(These notes are an integral part of this plan)

This plan has been prepared for Lennium Group for the purposes of A Disclosure Plan Under the Land Sales Act 1984 (as amended).

It is not to be used by any other person or corporation or for any other purposes and is subject to the following limitations:

Please refer to the approved Development Application for conditions relating to the LOT and to approved Operational Works drawings for services location and possible easements.

THESE DESIGNS AND DRAWINGS ARE COPYRIGHT AND ARE NOT TO BE USED OR REPRODUCED WITHOUT THE WRITTEN PERMISSION OF VERIS

### Data Sources

Cadastral Boundaries: 401871-LC01-P.dwg

Engineering Design: X\_22-000082\_8\_BASE-20250812.dwg

Final Surface Contours: 22-000082-5-12-Design-Contours-250mm-20250808.dwg

Depth of Fill: 22-000082-5-12-Depth-Contours-0.1m-20250808.dwg

Retaining Walls: X\_22-000082\_8\_BASE-20250812.dwg

X\_22-000082\_8\_BASE-20250812.dwg

B Updated Engineering 12/08/2025 TEM

A Original 6/02/2025 TEM

Issue Revisions Date Drawn

Locality: Lilywood

Local Authority: Moreton Bay C. C.

Horizontal Meridian: MGA, Zone56

Vertical Level Datum: AHD

Scale: 1:250 @ A4

Designed: Egis

Drawn: TEM 6/02/2025

Checked: DC

Plot Date: 12 Aug, 2025

Computer File Ref: 401871-S18-DP(B).dwg

## DISCLOSURE PLAN of Proposed LOT 209

being part of

Lot 12

on RP866105



veris

BRISBANE WHITSUNDAYS  
(07) 3666 4700 (07) 4945 6600

MACKAY CAIRNS  
(07) 4957 9700 (07) 4252 9400

veris.com.au

ACN 615 735 727  
Veris Australia Pty Ltd

Drawing No Issue  
401871-DP209 B



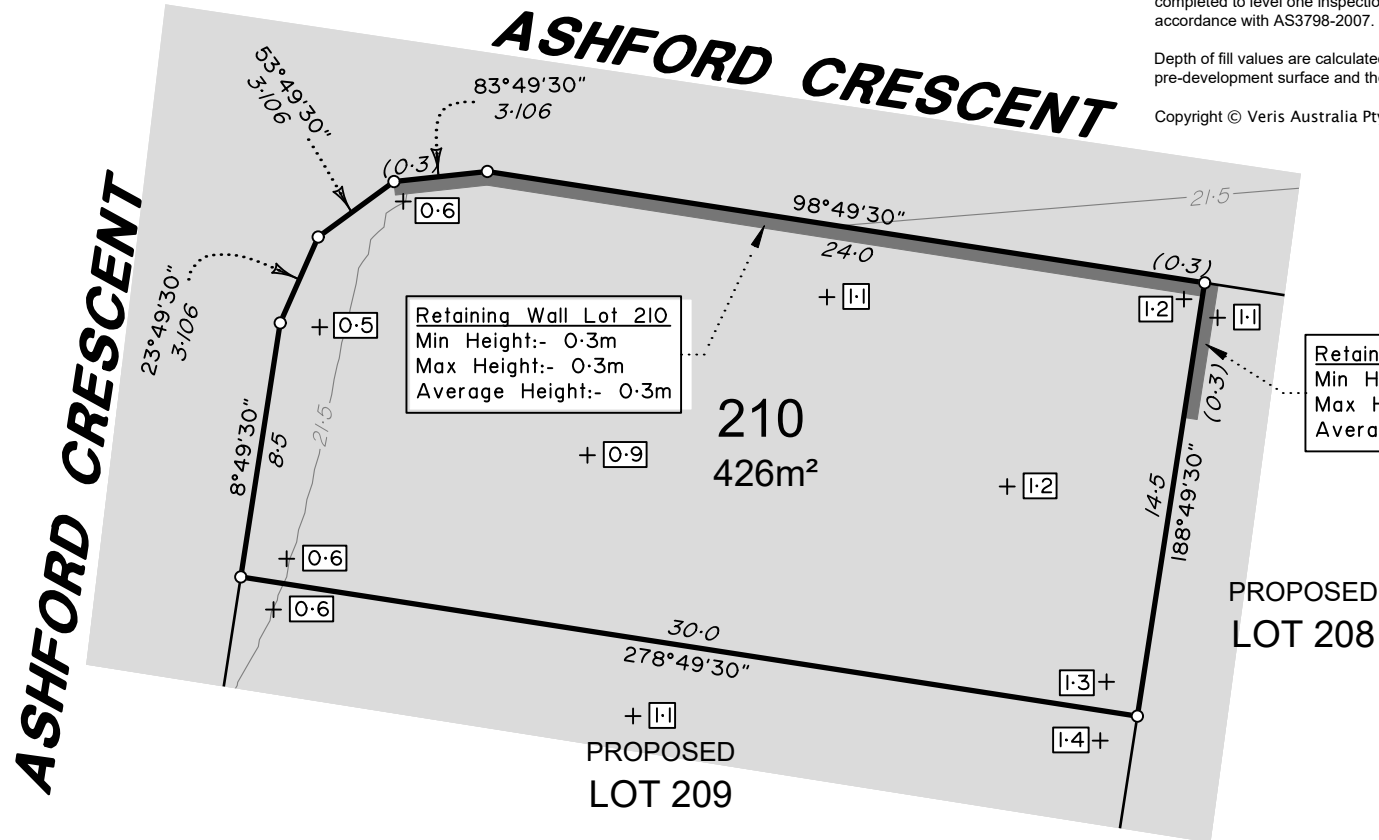

#### ADDITIONAL NOTES:

The LOT dimensions and area shown hereon are subject to final field survey and also to the requirements of Council and any other authority which may have requirements under any relevant legislation

Final surface contours shown hereon have been supplied by Egis.

Compaction of any fill material placed on this site shall be completed to level one inspection and testing services in accordance with AS3798-2007.

Depth of fill values are calculated to the lower of the pre-development surface and the ground surface from Survey.

Copyright © Veris Australia Pty Ltd August 2025

### Lilywood Landings Stage 8 For Lennium Group

#### IMPORTANT NOTES:

(These notes are an integral part of this plan)

This plan has been prepared for Lennium Group for the purposes of A Disclosure Plan Under the Land Sales Act 1984 (as amended).

It is not to be used by any other person or corporation or for any other purposes and is subject to the following limitations:

Please refer to the approved Development Application for conditions relating to the LOT and to approved Operational Works drawings for services location and possible easements.

THESE DESIGNS AND DRAWINGS ARE COPYRIGHT AND ARE NOT TO BE USED OR REPRODUCED WITHOUT THE WRITTEN PERMISSION OF VERIS

#### Data Sources

Cadastral Boundaries: 401871-LC01-P.dwg

Engineering Design: X\_22-000082\_8\_BASE-20250812.dwg

Final Surface Contours: 22-000082-5-12-Design-Contours-250mm-20250808.dwg

Depth of Fill: 22-000082-5-12-Depth-contour-0.1m-20250808.dwg

Retaining Walls: X\_22-000082\_8\_BASE-20250812.dwg

X\_22-000082\_8\_BASE-20250812.dwg

B Updated Engineering 12/08/2025 TEM

A Original 6/02/2025 TEM

Issue Revisions Date Drawn

Locality: Lilywood

Local Authority: Moreton Bay C. C.

Horizontal Meridian: MGA, Zone56

Vertical Level Datum: AHD

Scale: 1:250 @ A4

Designed: Egis

Drawn: TEM 6/02/2025

Checked: DC

Plot Date: 12 Aug, 2025

Computer File Ref: 401871-S18-DP(B).dwg

## LEGEND

Final surface contours based on A.H.D. datum at an interval of 0.5m, shown as: — 15.5 —

Where applicable, areas to be filled are shown as:

Depth of fill, in metres, shown as:- +0.5

Retaining wall and retaining wall height, shown on the lower side of the wall, have been calculated from digital data supplied by Egis and shown as:

(1.2)

0 12.5m 50 mm 25m 100 mm 37.5m 150 mm SCALE BAR



# veris

BRISBANE WHITSUNDAYS  
(07) 3666 4700 (07) 4945 6600

MACKAY CAIRNS  
(07) 4957 9700 (07) 4252 9400

veris.com.au

ACN 615 735 727  
Veris Australia Pty Ltd

Drawing No Issue  
401871-DP210 B

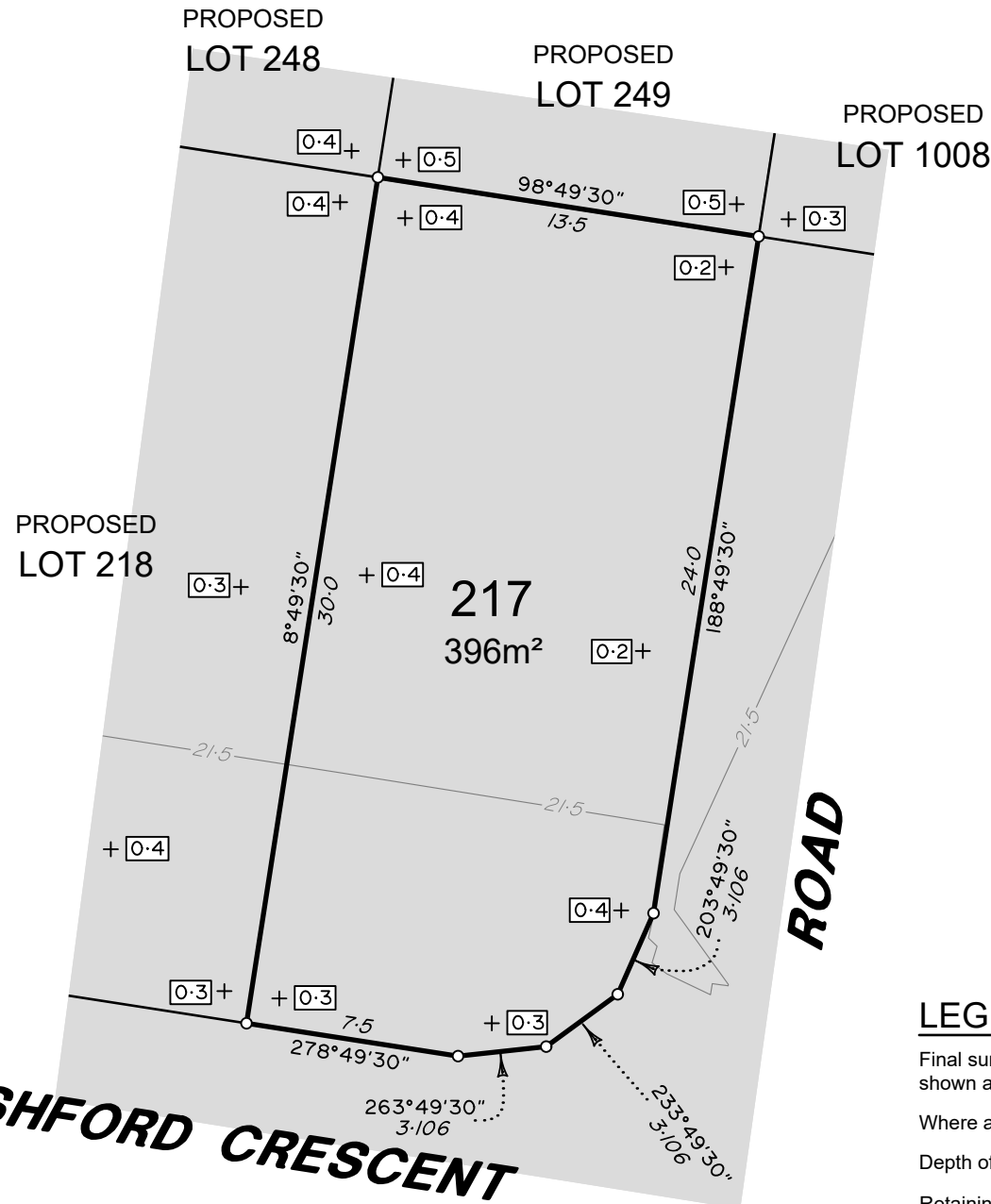

Drawing No	Issue
401871-DP217	B

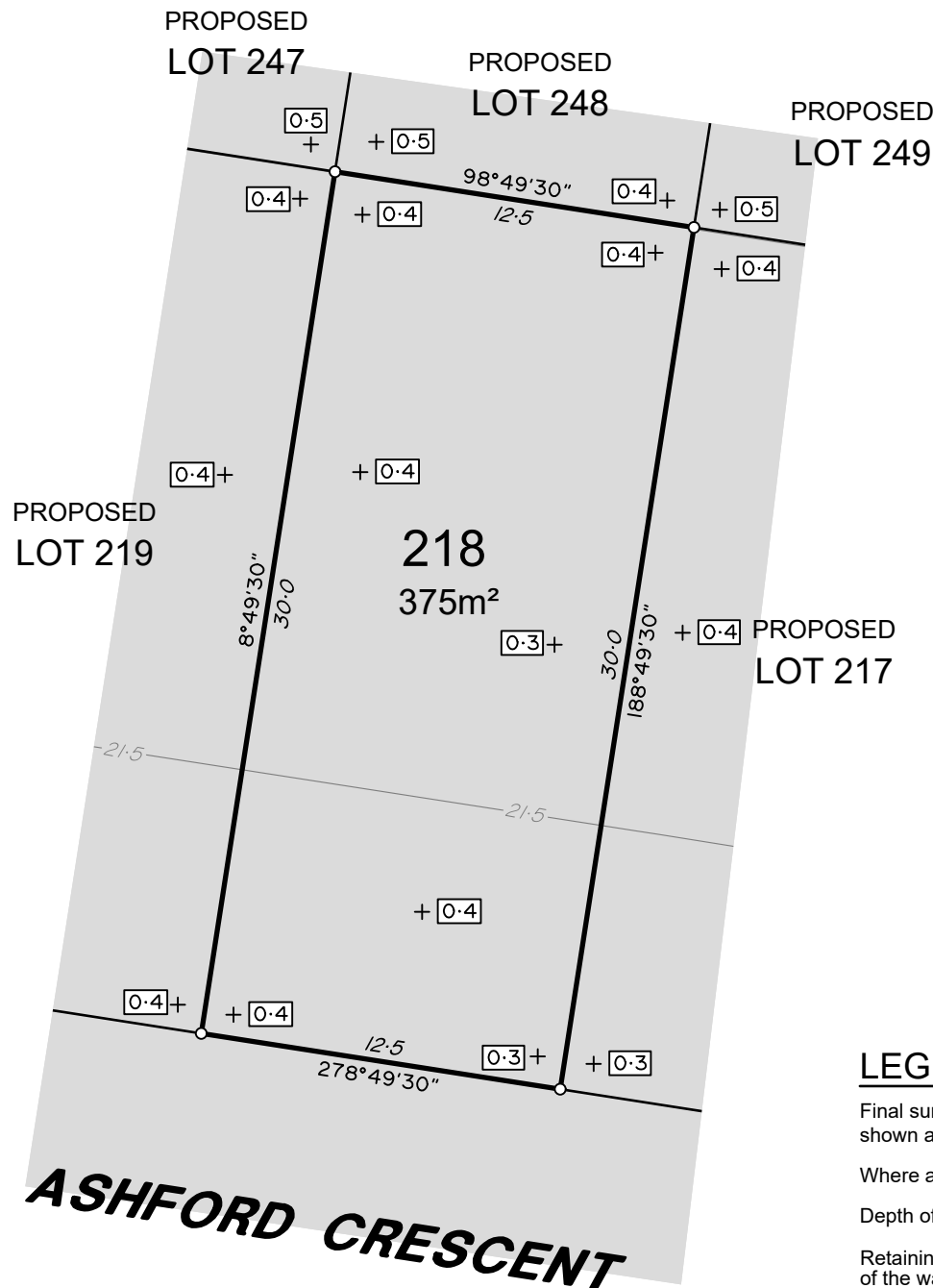

#### ADDITIONAL NOTES:

The LOT dimensions and area shown hereon are subject to final field survey and also to the requirements of Council and any other authority which may have requirements under any relevant legislation

Final surface contours shown hereon have been supplied by Egis.

Compaction of any fill material placed on this site shall be completed to level one inspection and testing services in accordance with AS3798-2007.

Depth of fill values are calculated to the lower of the pre-development surface and the ground surface from Survey.

Copyright © Veris Australia Pty Ltd August 2025

#### Lilywood Landings Stage 8 For Lennium Group

#### IMPORTANT NOTES:

(These notes are an integral part of this plan)

This plan has been prepared for Lennium Group for the purposes of A Disclosure Plan Under the Land Sales Act 1984 (as amended).

It is not to be used by any other person or corporation or for any other purposes and is subject to the following limitations:

Please refer to the approved Development Application for conditions relating to the LOT and to approved Operational Works drawings for services location and possible easements.

THESE DESIGNS AND DRAWINGS ARE COPYRIGHT AND ARE NOT TO BE USED OR REPRODUCED WITHOUT THE WRITTEN PERMISSION OF VERIS

#### Data Sources

Cadastral Boundaries: 401871-LC01-P.dwg

Engineering Design: X\_22-000082\_8\_BASE-20250812.dwg

Final Surface Contours: 22-000082-5-12-Design-Contours-250mm-20250808.dwg

Depth of Fill: 22-000082-5-12-depth-contour-0.1m-20250808.dwg

Retaining Walls: X\_22-000082\_8\_BASE-20250812.dwg

X\_22-000082\_8\_BASE-20250812.dwg

X\_22-000082\_8\_BASE-20250812.dwg

X\_22-000082\_8\_BASE-20250812.dwg

X\_22-000082\_8\_BASE-20250812.dwg

X\_22-000082\_8\_BASE-20250812.dwg

X\_22-000082\_8\_BASE-20250812.dwg

X\_22-000082\_8\_BASE-20250812.dwg

X\_22-000082\_8\_BASE-20250812.dwg

X\_22-000082\_8\_BASE-20250812.dwg

X\_22-000082\_8\_BASE-20250812.dwg

X\_22-000082\_8\_BASE-20250812.dwg

X\_22-000082\_8\_BASE-20250812.dwg

X\_22-000082\_8\_BASE-20250812.dwg

X\_22-000082\_8\_BASE-20250812.dwg

X\_22-000082\_8\_BASE-20250812.dwg

X\_22-000082\_8\_BASE-20250812.dwg

X\_22-000082\_8\_BASE-20250812.dwg

X\_22-000082\_8\_BASE-20250812.dwg

X\_22-000082\_8\_BASE-20250812.dwg

X\_22-000082\_8\_BASE-20250812.dwg

X\_22-000082\_8\_BASE-20250812.dwg

X\_22-000082\_8\_BASE-20250812.dwg

X\_22-000082\_8\_BASE-20250812.dwg

X\_22-000082\_8\_BASE-20250812.dwg

X\_22-000082\_8\_BASE-20250812.dwg

X\_22-000082\_8\_BASE-20250812.dwg

X\_22-000082\_8\_BASE-20250812.dwg

X\_22-000082\_8\_BASE-20250812.dwg

X\_22-000082\_8\_BASE-20250812.dwg

X\_22-000082\_8\_BASE-20250812.dwg

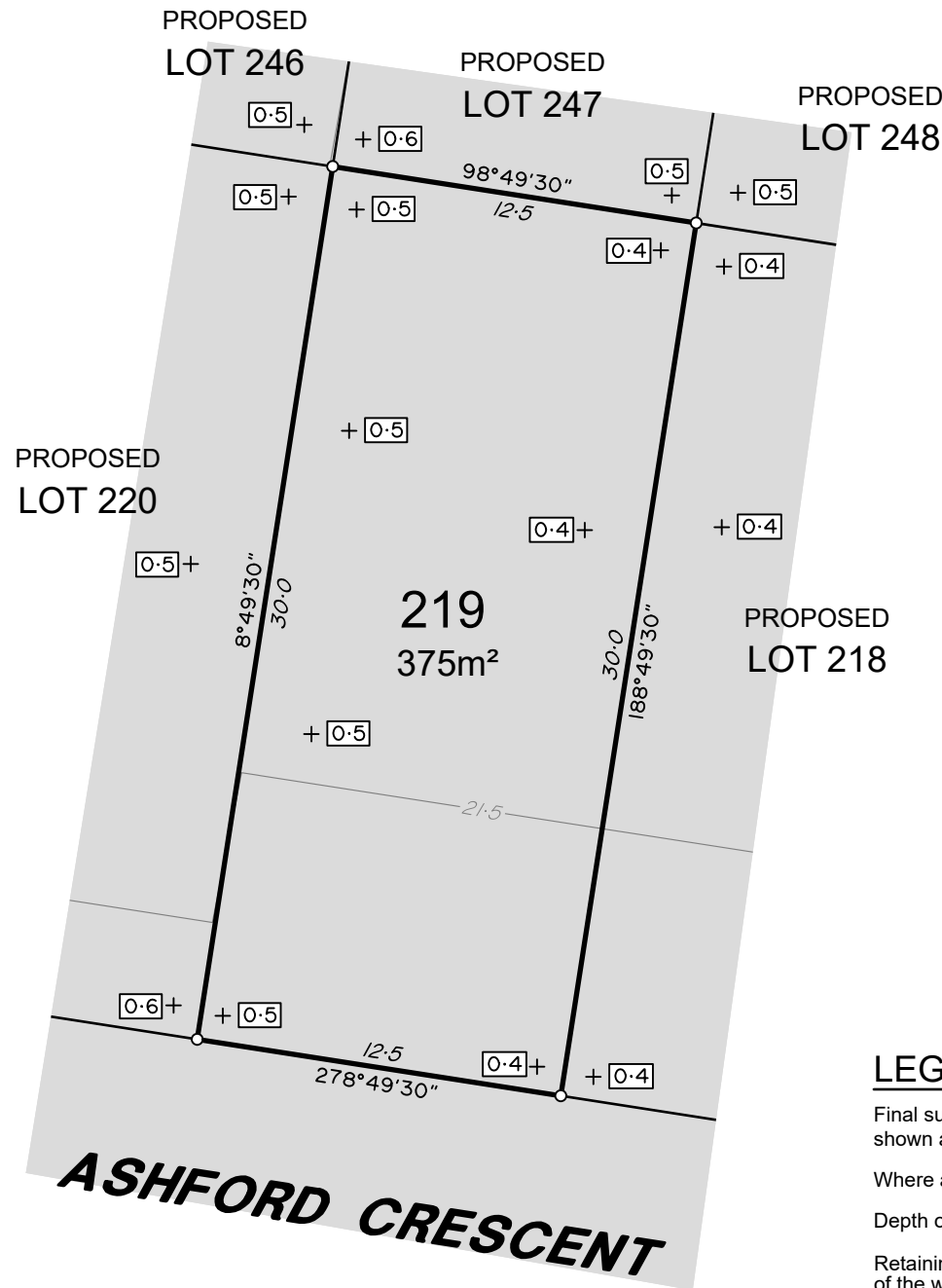

#### ADDITIONAL NOTES:

The LOT dimensions and area shown hereon are subject to final field survey and also to the requirements of Council and any other authority which may have requirements under any relevant legislation

Final surface contours shown hereon have been supplied by Egis.

Compaction of any fill material placed on this site shall be completed to level one inspection and testing services in accordance with AS3798-2007.

Depth of fill values are calculated to the lower of the pre-development surface and the ground surface from Survey.

Copyright © Veris Australia Pty Ltd August 2025

#### Lilywood Landings Stage 8 For Lennium Group

#### IMPORTANT NOTES:

(These notes are an integral part of this plan)

This plan has been prepared for Lennium Group for the purposes of A Disclosure Plan Under the Land Sales Act 1984 (as amended).

It is not to be used by any other person or corporation or for any other purposes and is subject to the following limitations:

Please refer to the approved Development Application for conditions relating to the LOT and to approved Operational Works drawings for services location and possible easements.

THESE DESIGNS AND DRAWINGS ARE COPYRIGHT AND ARE NOT TO BE USED OR REPRODUCED WITHOUT THE WRITTEN PERMISSION OF VERIS

#### Data Sources

Cadastral Boundaries: 401871-LC01-P.dwg

Engineering Design: X\_22-000082\_8\_BASE-20250812.dwg

Final Surface Contours: 22-000082-5-12-Design-Contours-250mm-20250808.dwg

Depth of Fill: 22-000082-5-12-depth-contour-0.1m-20250808.dwg

Retaining Walls: X\_22-000082\_8\_BASE-20250812.dwg

Issue	Revisions	Date	Drawn
B	Updated Engineering	12/08/2025	TEM
A	Original	6/02/2025	TEM

Locality: Lilywood  
Local Authority: Moreton Bay C. C.  
Horizontal Meridian: MGA, Zone56  
Vertical Level Datum: AHD  
Scale: 1:250 @ A4  
Designed: Egis  
Drawn: TEM 6/02/2025  
Checked: DC  
Plot Date: 12 Aug, 2025  
Computer File Ref: 401871-S18-DP(B).dwg

DISCLOSURE PLAN  
of Proposed LOT 219  
being part of  
Lot 12  
on RP866105



**veris**

BRISBANE (07) 3666 4700 WHITSUNDAYS (07) 4945 6600

MACKAY (07) 4957 9700 CAIRNS (07) 4252 9400

veris.com.au  
ACN 615 735 727  
Veris Australia Pty Ltd

Drawing No 401871-DP219 Issue B

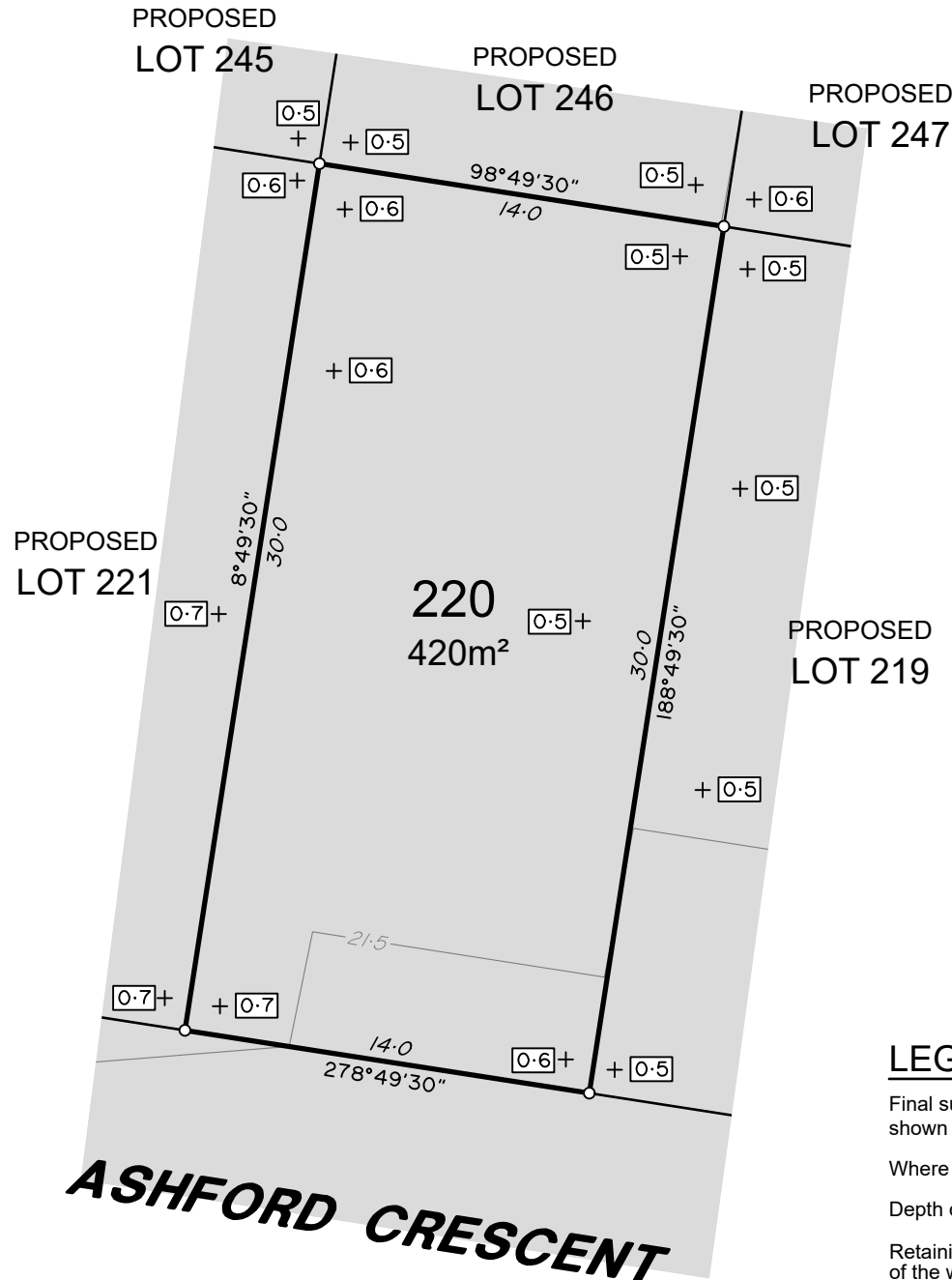

#### ADDITIONAL NOTES:

The LOT dimensions and area shown hereon are subject to final field survey and also to the requirements of Council and any other authority which may have requirements under any relevant legislation

Final surface contours shown hereon have been supplied by Egis.

Compaction of any fill material placed on this site shall be completed to level one inspection and testing services in accordance with AS3798-2007.

Depth of fill values are calculated to the lower of the pre-development surface and the ground surface from Survey.

Copyright © Veris Australia Pty Ltd August 2025

### Lilywood Landings Stage 8 For Lennium Group

#### IMPORTANT NOTES:

(These notes are an integral part of this plan)  
This plan has been prepared for Lennium Group for the purposes of A Disclosure Plan Under the Land Sales Act 1984 (as amended).  
It is not to be used by any other person or corporation or for any other purposes and is subject to the following limitations:

Please refer to the approved Development Application for conditions relating to the LOT and to approved Operational Works drawings for services location and possible easements.

THESE DESIGNS AND DRAWINGS ARE COPYRIGHT AND ARE NOT TO BE USED OR REPRODUCED WITHOUT THE WRITTEN PERMISSION OF VERIS

#### Data Sources

Cadastral Boundaries: 401871-LC01-P.dwg  
Engineering Design: X\_22-000082\_8\_BASE-20250812.dwg  
Final Surface Contours: 22-000082-5-12-Design-Contours-250mm-20250808.dwg  
Depth of Fill: 22-000082-5-12-Design-Contours-250mm-20250808.dwg  
Retaining Walls: X\_22-000082\_8\_BASE-20250812.dwg

Issue	Revisions	Date	Drawn
B	Updated Engineering	12/08/2025	TEM
A	Original	6/02/2025	TEM

Locality: Lilywood  
Local Authority: Moreton Bay C. C.  
Horizontal Meridian: MGA, Zone56  
Vertical Level Datum: AHD  
Scale: 1:250 @ A4  
Designed: Egis  
Drawn: TEM 6/02/2025  
Checked: DC  
Plot Date: 12 Aug, 2025  
Computer File Ref: 401871-S18-DP(B).dwg

**DISCLOSURE PLAN**  
of Proposed LOT 220  
being part of  
Lot 12  
on RP866105



**veris**

BRISBANE (07) 3666 4700 WHITSUNDAYS (07) 4945 6600

MACKAY (07) 4957 9700 CAIRNS (07) 4252 9400

veris.com.au  
ACN 615 735 727  
Veris Australia Pty Ltd

Drawing No 401871-DP220 Issue B

## LEGEND

Final surface contours based on A.H.D. datum at an interval of 0.5m, shown as: — 15.5 —

Where applicable, areas to be filled are shown as:

Depth of fill, in metres, shown as:- +0.5

Retaining wall and retaining wall height, shown on the lower side of the wall, have been calculated from digital data supplied by Egis and shown as:

(1.2)

0 12.5m 50 mm 25m 100 mm 37.5m 150 mm SCALE BAR

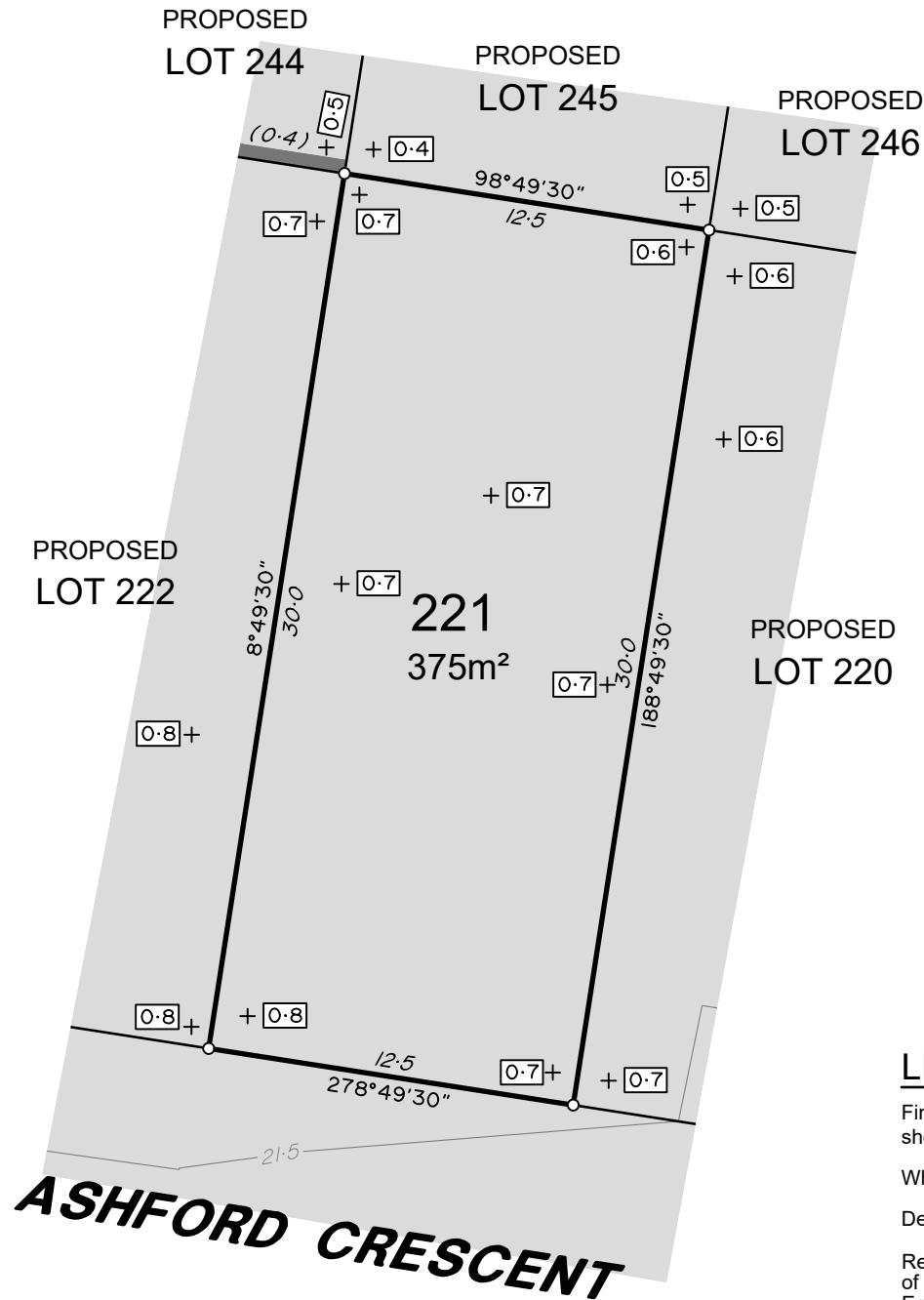

## LEGEND

Final surface contours based on A.H.D. datum at an interval of 0.5m, shown as: 

Where applicable, areas to be filled are shown as: 

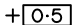
Depth of fill, in metres, shown as:- 

Retaining wall and retaining wall height, shown on the lower side of the wall, have been calculated from digital data supplied by Egis and shown as: 

(1.2)

### ADDITIONAL NOTES:

The LOT dimensions and area shown hereon are subject to final field survey and also to the requirements of Council and any other authority which may have requirements under any relevant legislation

Final surface contours shown hereon have been supplied by Egis.

Compaction of any fill material placed on this site shall be completed to level one inspection and testing services in accordance with AS3798-2007.

Depth of fill values are calculated to the lower of the pre-development surface and the ground surface from Survey.

Copyright © Veris Australia Pty Ltd August 2025

## Lilywood Landings Stage 8 For Lennium Group

### IMPORTANT NOTES:

(These notes are an integral part of this plan)

This plan has been prepared for Lennium Group for the purposes of A Disclosure Plan Under the Land Sales Act 1984 (as amended).

It is not to be used by any other person or corporation or for any other purposes and is subject to the following limitations:

Please refer to the approved Development Application for conditions relating to the LOT and to approved Operational Works drawings for services location and possible easements.

THESE DESIGNS AND DRAWINGS ARE COPYRIGHT AND ARE NOT TO BE USED OR REPRODUCED WITHOUT THE WRITTEN PERMISSION OF VERIS

### Data Sources

Cadastral Boundaries: 401871-LC01-P.dwg

Engineering Design: X\_22-000082\_8\_BASE-20250812.dwg

Final Surface Contours: 22-000082-5-12-Design-Contours-250mm-20250808.dwg

Depth of Fill: 22-000082-5-12-depth-contour-0.1m-20250808.dwg

Retaining Walls: X\_22-000082\_8\_BASE-20250812.dwg

X\_22-000082\_8\_BASE-20250812.dwg

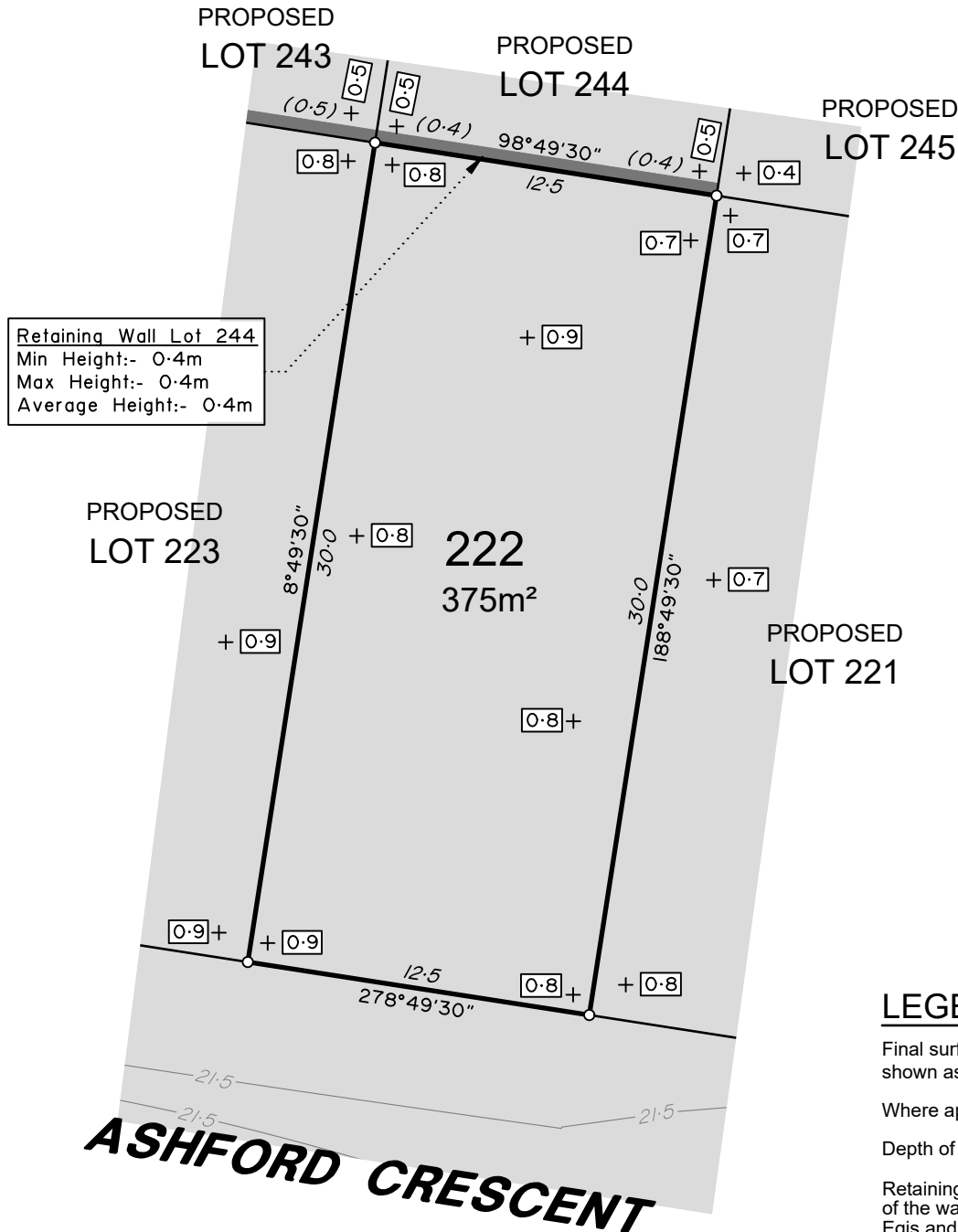

#### ADDITIONAL NOTES:

The LOT dimensions and area shown hereon are subject to final field survey and also to the requirements of Council and any other authority which may have requirements under any relevant legislation

Final surface contours shown hereon have been supplied by Egis.

Compaction of any fill material placed on this site shall be completed to level one inspection and testing services in accordance with AS3798-2007.

Depth of fill values are calculated to the lower of the pre-development surface and the ground surface from Survey.

Copyright © Veris Australia Pty Ltd August 2025

#### Lilywood Landings Stage 8 For Lennium Group

#### IMPORTANT NOTES:

(These notes are an integral part of this plan)

This plan has been prepared for Lennium Group for the purposes of A Disclosure Plan Under the Land Sales Act 1984 (as amended).

It is not to be used by any other person or corporation or for any other purposes and is subject to the following limitations:

Please refer to the approved Development Application for conditions relating to the LOT and to approved Operational Works drawings for services location and possible easements.

THESE DESIGNS AND DRAWINGS ARE COPYRIGHT AND ARE NOT TO BE USED OR REPRODUCED WITHOUT THE WRITTEN PERMISSION OF VERIS

#### Data Sources

Cadastral Boundaries: 401871-LC01-P.dwg

Engineering Design: X\_22-000082\_8\_BASE-20250812.dwg

Final Surface Contours: 22-000082-5-12-Design-Contours-250mm-20250808.dwg

Depth of Fill: 22-000082-5-12-depth-contour-0.1m-20250808.dwg

Retaining Walls: X\_22-000082\_8\_BASE-20250812.dwg

X\_22-000082\_8\_BASE-20250812.dwg

X\_22-000082\_8\_BASE-20250812.dwg

X\_22-000082\_8\_BASE-20250812.dwg

X\_22-000082\_8\_BASE-20250812.dwg

X\_22-000082\_8\_BASE-20250812.dwg

X\_22-000082\_8\_BASE-20250812.dwg

X\_22-000082\_8\_BASE-20250812.dwg

X\_22-000082\_8\_BASE-20250812.dwg

X\_22-000082\_8\_BASE-20250812.dwg

X\_22-000082\_8\_BASE-20250812.dwg

X\_22-000082\_8\_BASE-20250812.dwg

X\_22-000082\_8\_BASE-20250812.dwg

X\_22-000082\_8\_BASE-20250812.dwg

X\_22-000082\_8\_BASE-20250812.dwg

X\_22-000082\_8\_BASE-20250812.dwg

X\_22-000082\_8\_BASE-20250812.dwg

X\_22-000082\_8\_BASE-20250812.dwg

X\_22-000082\_8\_BASE-20250812.dwg

X\_22-000082\_8\_BASE-20250812.dwg

X\_22-000082\_8\_BASE-20250812.dwg

X\_22-000082\_8\_BASE-20250812.dwg

X\_22-000082\_8\_BASE-20250812.dwg

X\_22-000082\_8\_BASE-20250812.dwg

X\_22-000082\_8\_BASE-20250812.dwg

X\_22-000082\_8\_BASE-20250812.dwg

X\_22-000082\_8\_BASE-20250812.dwg

X\_22-000082\_8\_BASE-20250812.dwg

X\_22-000082\_8\_BASE-20250812.dwg

X\_22-000082\_8\_BASE-20250812.dwg

X\_22-000082\_8\_BASE-20250812.dwg

X\_22-000082\_8\_BASE-20250812.dwg

X\_22-000082\_8\_BASE-20250812.dwg

X\_22-000082\_8\_BASE-20250812.dwg



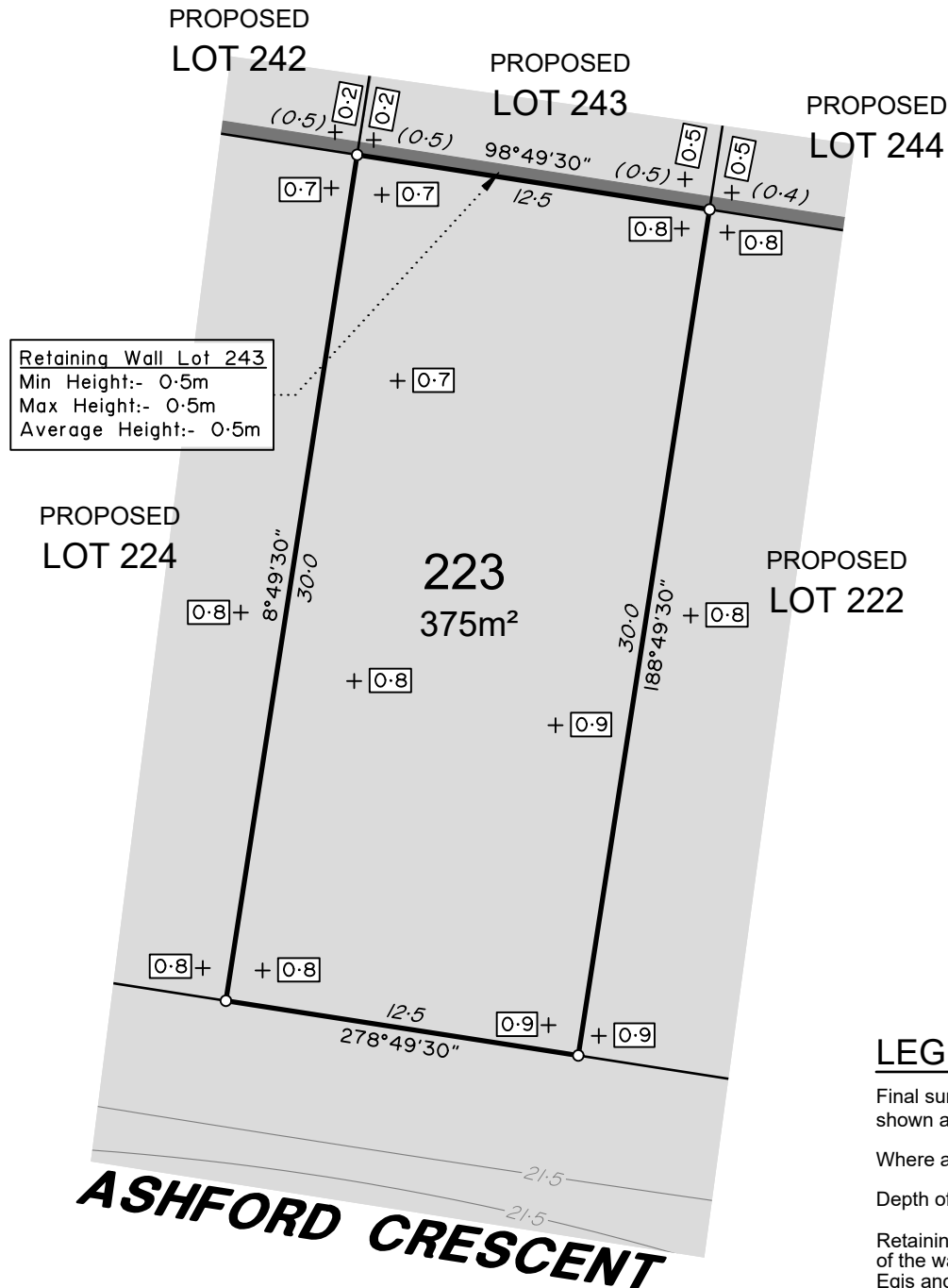

0 12.5m 25m 37.5m  
50 mm 100 mm 150 mm SCALE BAR

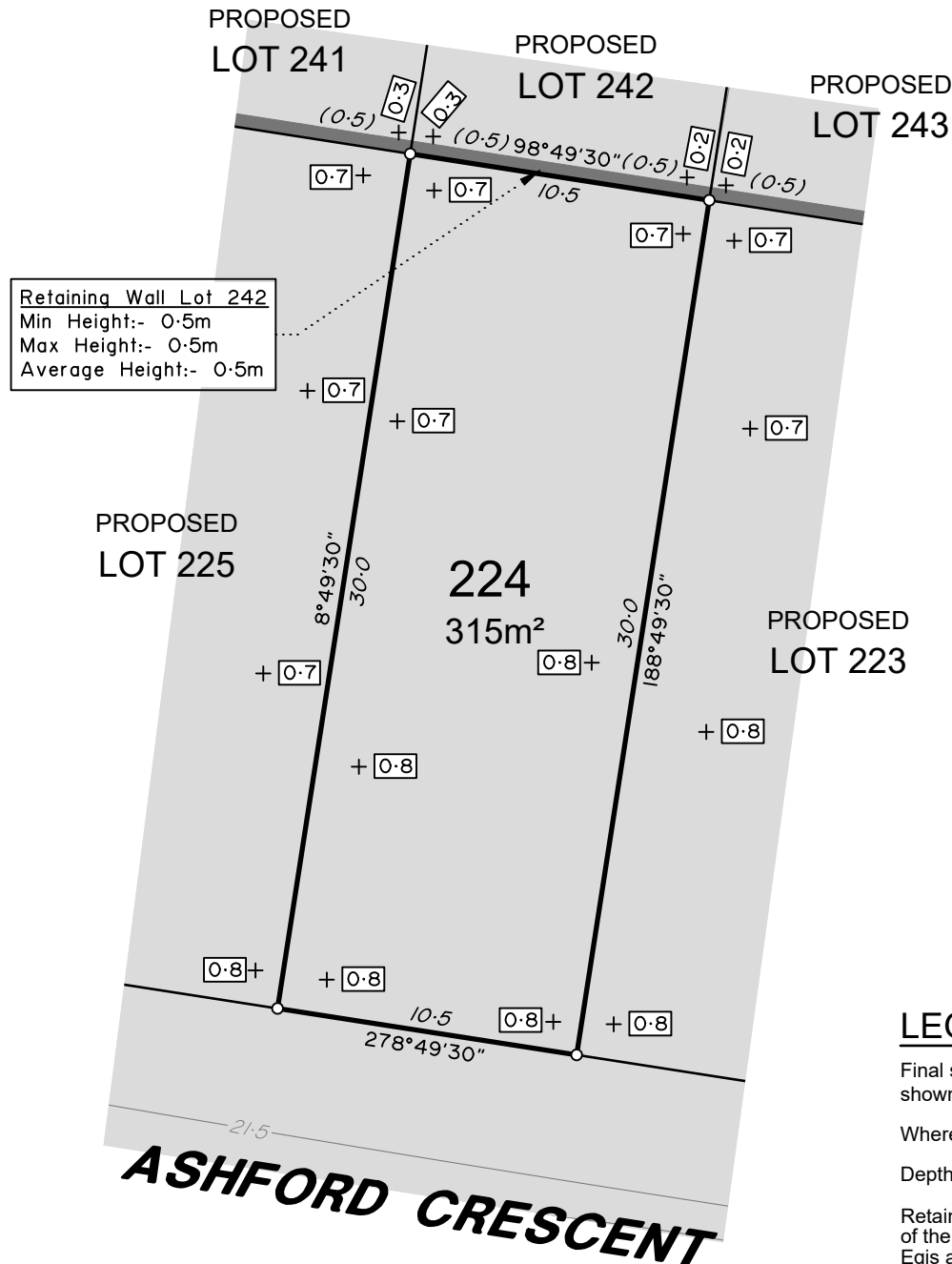

#### ADDITIONAL NOTES:

The LOT dimensions and area shown hereon are subject to final field survey and also to the requirements of Council and any other authority which may have requirements under any relevant legislation

Final surface contours shown hereon have been supplied by Egis.

Compaction of any fill material placed on this site shall be completed to level one inspection and testing services in accordance with AS3798-2007.

Depth of fill values are calculated to the lower of the pre-development surface and the ground surface from Survey.

Copyright © Veris Australia Pty Ltd August 2025

#### Lilywood Landings Stage 8 For Lennium Group

#### IMPORTANT NOTES:

(These notes are an integral part of this plan)

This plan has been prepared for Lennium Group for the purposes of A Disclosure Plan Under the Land Sales Act 1984 (as amended).

It is not to be used by any other person or corporation or for any other purposes and is subject to the following limitations:

Please refer to the approved Development Application for conditions relating to the LOT and to approved Operational Works drawings for services location and possible easements.

THESE DESIGNS AND DRAWINGS ARE COPYRIGHT AND ARE NOT TO BE USED OR REPRODUCED WITHOUT THE WRITTEN PERMISSION OF VERIS

#### Data Sources

Cadastral Boundaries: 401871-LC01-P.dwg

Engineering Design: X\_22-000082\_8\_BASE-20250812.dwg

Final Surface Contours: 22-000082-5-12-Design-Contours-250mm-20250808.dwg

Depth of Fill: 22-000082-5-12-depth-contour-0.1m-20250808.dwg

Retaining Walls: X\_22-000082\_8\_BASE-20250812.dwg

Issue	Revisions	Date	Drawn
B	Updated Engineering	12/08/2025	TEM
A	Original	6/02/2025	TEM

Locality: Lilywood  
Local Authority: Moreton Bay C. C.  
Horizontal Meridian: MGA, Zone56  
Vertical Level Datum: AHD  
Scale: 1:250 @ A4  
Designed: Egis  
Drawn: TEM 6/02/2025  
Checked: DC  
Plot Date: 12 Aug, 2025  
Computer File Ref: 401871-S18-DP(B).dwg

DISCLOSURE PLAN  
of Proposed LOT 224  
being part of  
Lot 12  
on RP866105



**veris**

BRISBANE WHITSUNDAYS  
(07) 3666 4700 (07) 4945 6600

MACKAY CAIRNS  
(07) 4957 9700 (07) 4252 9400

veris.com.au  
ACN 615 735 727  
Veris Australia Pty Ltd

Drawing No Issue  
401871-DP224 B

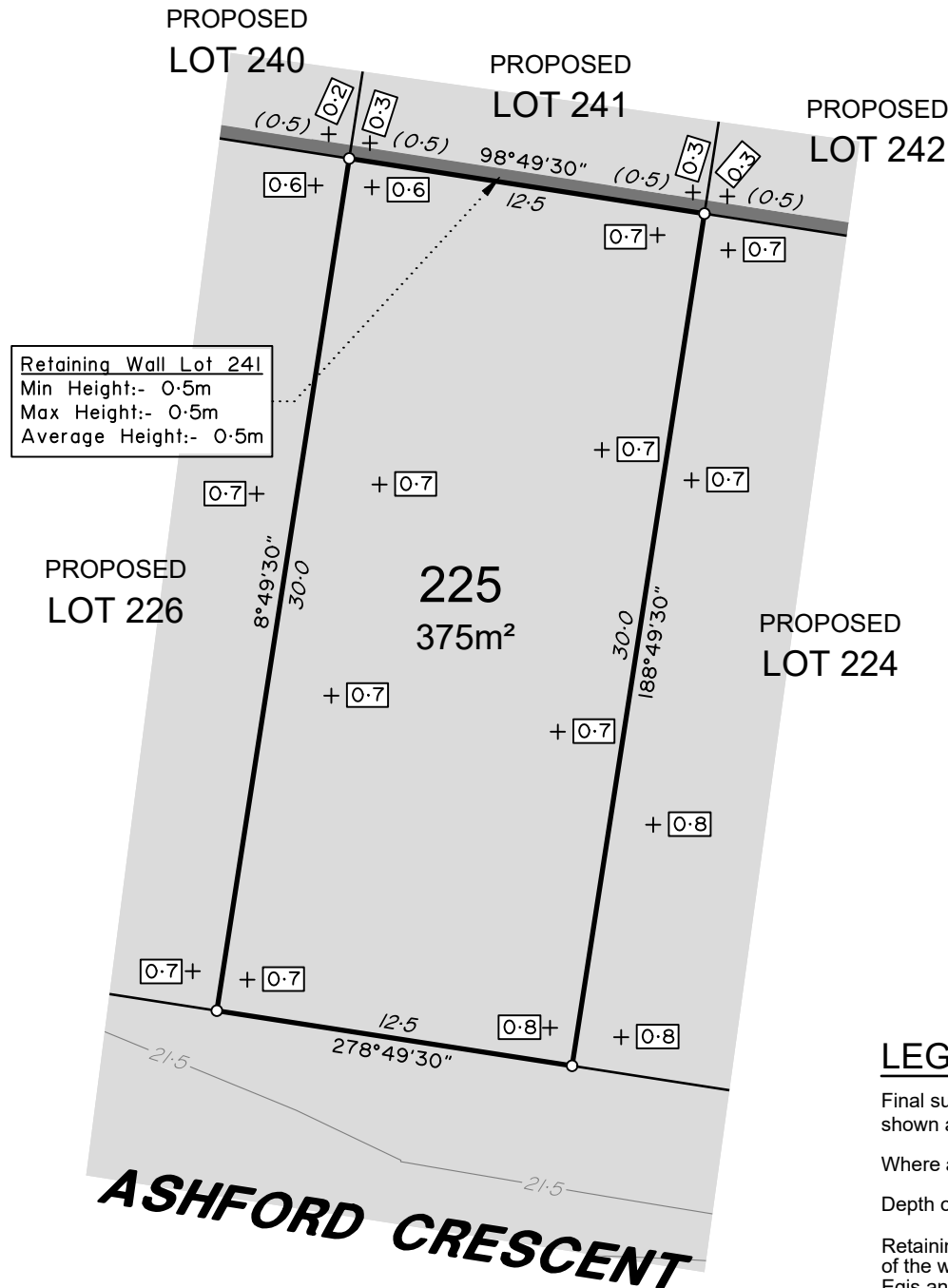

## LEGEND

Final surface contours based on A.H.D. datum at an interval of 0.5m, shown as: — 15.5 —

Where applicable, areas to be filled are shown as: [shaded area]

Depth of fill, in metres, shown as:- +0.5

Retaining wall and retaining wall height, shown on the lower side of the wall, have been calculated from digital data supplied by Egis and shown as: (1.2)

### ADDITIONAL NOTES:

The LOT dimensions and area shown hereon are subject to final field survey and also to the requirements of Council and any other authority which may have requirements under any relevant legislation

Final surface contours shown hereon have been supplied by Egis.

Compaction of any fill material placed on this site shall be completed to level one inspection and testing services in accordance with AS3798-2007.

Depth of fill values are calculated to the lower of the pre-development surface and the ground surface from Survey.

Copyright © Veris Australia Pty Ltd August 2025

## Lilywood Landings Stage 8 For Lennium Group

### IMPORTANT NOTES:

(These notes are an integral part of this plan)

This plan has been prepared for Lennium Group for the purposes of A Disclosure Plan Under the Land Sales Act 1984 (as amended).

It is not to be used by any other person or corporation or for any other purposes and is subject to the following limitations:

Please refer to the approved Development Application for conditions relating to the LOT and to approved Operational Works drawings for services location and possible easements.

THESE DESIGNS AND DRAWINGS ARE COPYRIGHT AND ARE NOT TO BE USED OR REPRODUCED WITHOUT THE WRITTEN PERMISSION OF VERIS

### Data Sources

Cadastral Boundaries: 401871-LC01-P.dwg

Engineering Design: X\_22-000082\_8\_BASE-20250812.dwg

Final Surface Contours: 22-000082-5-12-Design-Contours-250mm-20250808.dwg

Depth of Fill: 22-000082-5-12-depth-contour-0.1m-20250808.dwg

Retaining Walls: X\_22-000082\_8\_BASE-20250812.dwg

Issue	Revisions	Date	Drawn
B	Updated Engineering	12/08/2025	TEM
A	Original	6/02/2025	TEM

Locality: Lilywood  
Local Authority: Moreton Bay C. C.  
Horizontal Meridian: MGA, Zone56  
Vertical Level Datum: AHD  
Scale: 1:250 @ A4  
Designed: Egis  
Drawn: TEM 6/02/2025  
Checked: DC  
Plot Date: 12 Aug, 2025  
Computer File Ref: 401871-S18-DP(B).dwg

DISCLOSURE PLAN  
of Proposed LOT 225  
being part of  
Lot 12  
on RP866105



veris

BRISBANE WHITSUNDAYS  
(07) 3666 4700 (07) 4945 6600

MACKAY CAIRNS  
(07) 4957 9700 (07) 4252 9400

veris.com.au  
ACN 615 735 727  
Veris Australia Pty Ltd

Drawing No Issue  
401871-DP225 B

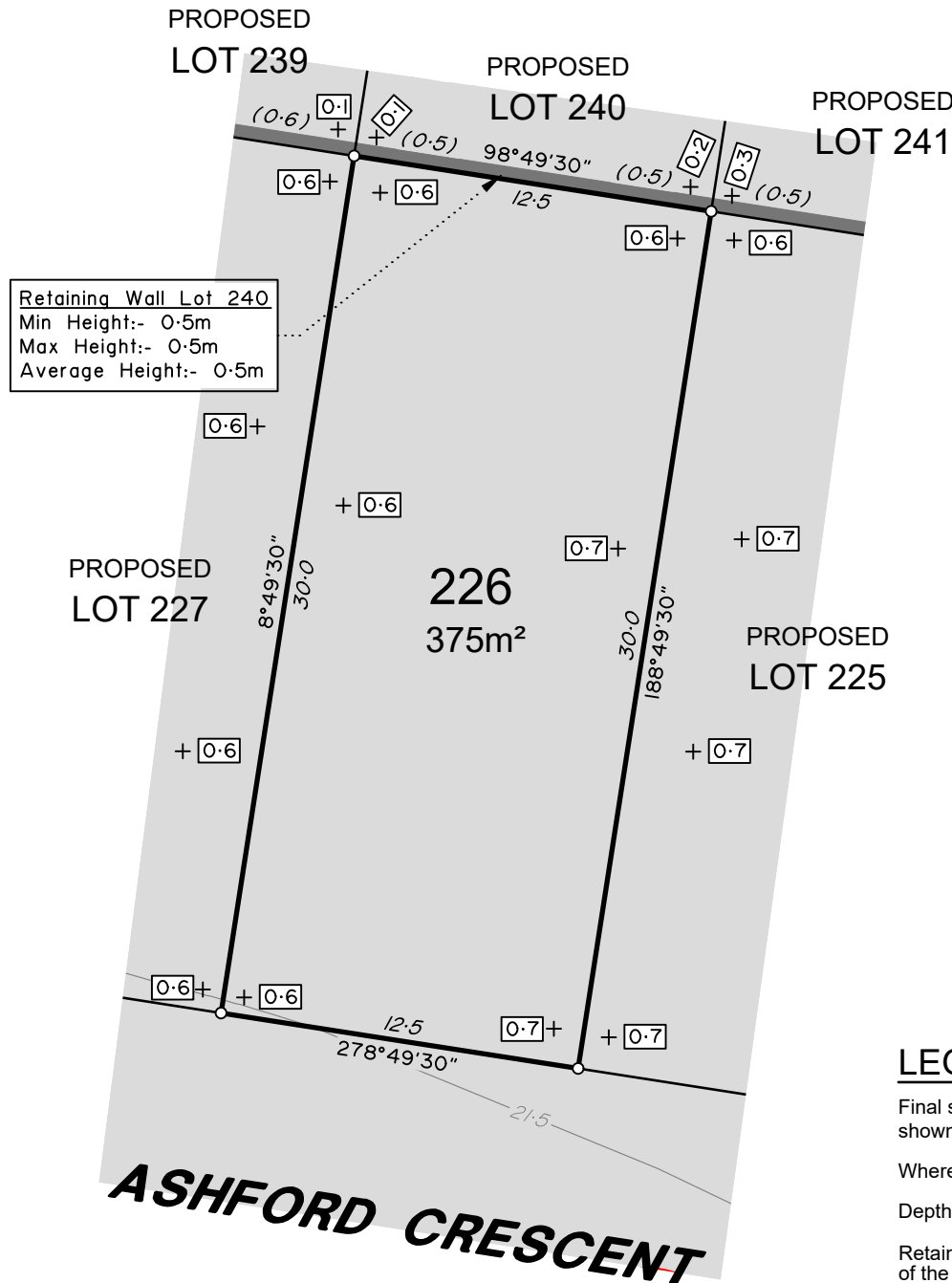

#### ADDITIONAL NOTES:

The LOT dimensions and area shown hereon are subject to final field survey and also to the requirements of Council and any other authority which may have requirements under any relevant legislation

Final surface contours shown hereon have been supplied by Egis.

Compaction of any fill material placed on this site shall be completed to level one inspection and testing services in accordance with AS3798-2007.

Depth of fill values are calculated to the lower of the pre-development surface and the ground surface from Survey.

Copyright © Veris Australia Pty Ltd August 2025

#### Lilywood Landings Stage 8 For Lennium Group

#### IMPORTANT NOTES:

(These notes are an integral part of this plan)

This plan has been prepared for Lennium Group for the purposes of A Disclosure Plan Under the Land Sales Act 1984 (as amended).

It is not to be used by any other person or corporation or for any other purposes and is subject to the following limitations:

Please refer to the approved Development Application for conditions relating to the LOT and to approved Operational Works drawings for services location and possible easements.

THESE DESIGNS AND DRAWINGS ARE COPYRIGHT AND ARE NOT TO BE USED OR REPRODUCED WITHOUT THE WRITTEN PERMISSION OF VERIS

#### Data Sources

Cadastral Boundaries: 401871-LC01-P.dwg

Engineering Design: X\_22-000082\_8\_BASE-20250812.dwg

Final Surface Contours: 22-000082-5-12-Design-Contours-250mm-20250808.dwg

Depth of Fill: 22-000082-5-12-depth-contour-0.1m-20250808.dwg

Retaining Walls: X\_22-000082\_8\_BASE-20250812.dwg

X\_22-000082\_8\_BASE-20250812.dwg

X\_22-000082\_8\_BASE-20250812.dwg

X\_22-000082\_8\_BASE-20250812.dwg

X\_22-000082\_8\_BASE-20250812.dwg

X\_22-000082\_8\_BASE-20250812.dwg

X\_22-000082\_8\_BASE-20250812.dwg

X\_22-000082\_8\_BASE-20250812.dwg

X\_22-000082\_8\_BASE-20250812.dwg

X\_22-000082\_8\_BASE-20250812.dwg

X\_22-000082\_8\_BASE-20250812.dwg

X\_22-000082\_8\_BASE-20250812.dwg

X\_22-000082\_8\_BASE-20250812.dwg

X\_22-000082\_8\_BASE-20250812.dwg

X\_22-000082\_8\_BASE-20250812.dwg

X\_22-000082\_8\_BASE-20250812.dwg

X\_22-000082\_8\_BASE-20250812.dwg

X\_22-000082\_8\_BASE-20250812.dwg

X\_22-000082\_8\_BASE-20250812.dwg

X\_22-000082\_8\_BASE-20250812.dwg

X\_22-000082\_8\_BASE-20250812.dwg

X\_22-000082\_8\_BASE-20250812.dwg

X\_22-000082\_8\_BASE-20250812.dwg

X\_22-000082\_8\_BASE-20250812.dwg

X\_22-000082\_8\_BASE-20250812.dwg

X\_22-000082\_8\_BASE-20250812.dwg

X\_22-000082\_8\_BASE-20250812.dwg

X\_22-000082\_8\_BASE-20250812.dwg

X\_22-000082\_8\_BASE-20250812.dwg

X\_22-000082\_8\_BASE-20250812.dwg

X\_22-000082\_8\_BASE-20250812.dwg

X\_22-000082\_8\_BASE-20250812.dwg

X\_22-000082\_8\_BASE-20250812.dwg

X\_22-000082\_8\_BASE-20250812.dwg

X\_22-000082\_8\_BASE-20250812.dwg

X\_22-000082\_8\_BASE-20250812.dwg

X\_22-000082\_8\_BASE-20250812.dwg

X\_22-000082\_8\_BASE-20250812.dwg

X\_22-000082\_8\_BASE-20250812.dwg

X\_22-000082\_8\_BASE-20250812.dwg

X\_22-000082\_8\_BASE-20250812.dwg

X\_22-000082\_8\_BASE-20250812.dwg

X\_22-000082\_8\_BASE-20250812.dwg

X\_22-000082\_8\_BASE-20250812.dwg

X\_22-000082\_8\_BASE-20250812.dwg

X\_22-000082\_8\_BASE-20250812.dwg

X\_22-000082\_8\_BASE-20250812.dwg

X\_22-000082\_8\_BASE-20250812.dwg

X\_22-000082\_8\_BASE-20250812.dwg

X\_22-000082\_8\_BASE-20250812.dwg

X\_22-000082\_8\_BASE-20250812.dwg

X\_22-000082\_8\_BASE-20250812.dwg

X\_22-000082\_8\_BASE-20250812.dwg

X\_22-000082\_8\_BASE-20250812.dwg

X\_22-000082\_8\_BASE-20250812.dwg

X\_22-000082\_8\_BASE-20250812.dwg

X\_22-000082\_8\_BASE-20250812.dwg

X\_22-000082\_8\_BASE-20250812.dwg

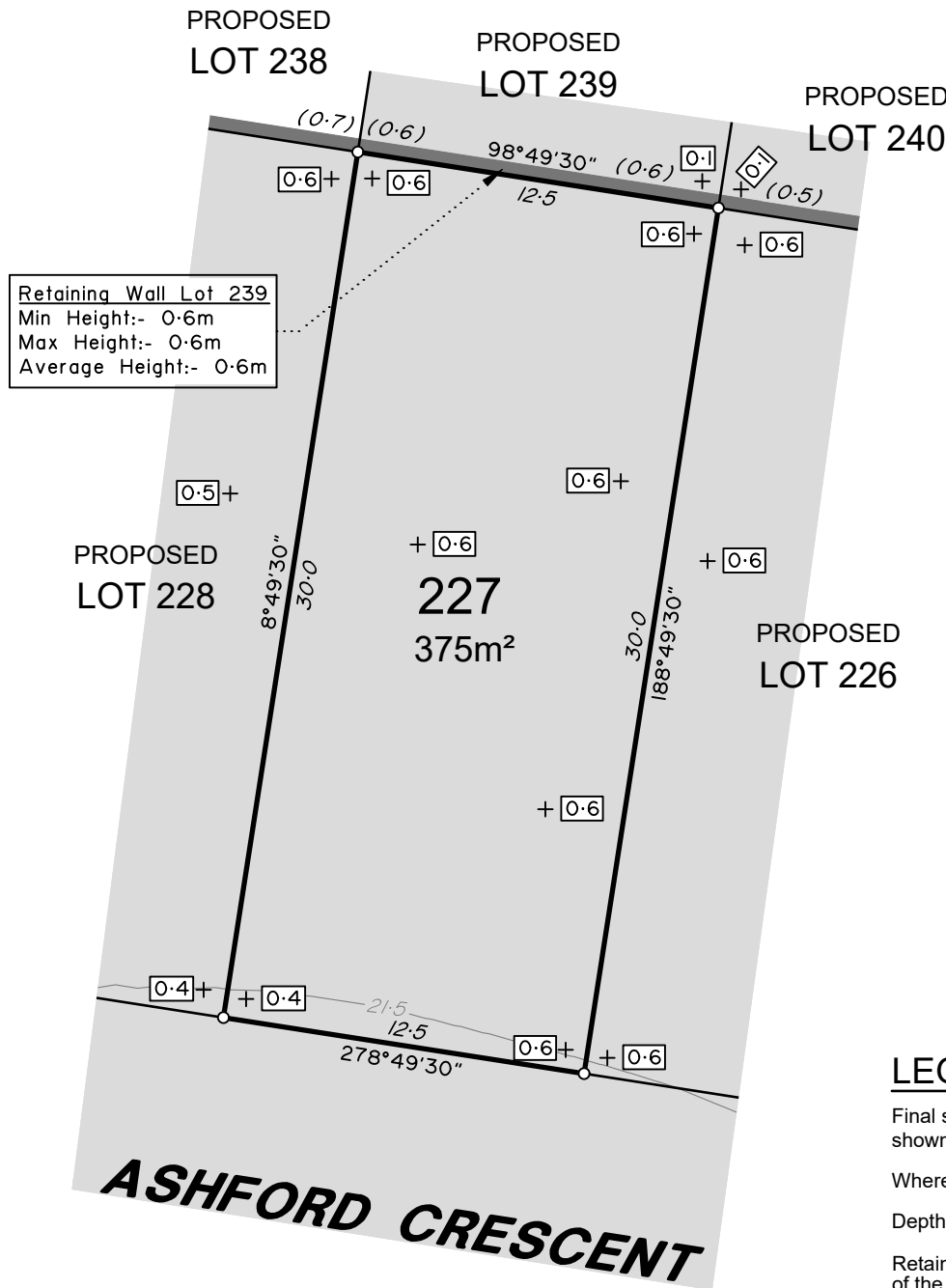

#### ADDITIONAL NOTES:

The LOT dimensions and area shown hereon are subject to final field survey and also to the requirements of Council and any other authority which may have requirements under any relevant legislation

Final surface contours shown hereon have been supplied by Egis.

Compaction of any fill material placed on this site shall be completed to level one inspection and testing services in accordance with AS3798-2007.

Depth of fill values are calculated to the lower of the pre-development surface and the ground surface from Survey.

Copyright © Veris Australia Pty Ltd August 2025

#### Lilywood Landings Stage 8 For Lennium Group

#### IMPORTANT NOTES:

(These notes are an integral part of this plan)

This plan has been prepared for Lennium Group for the purposes of A Disclosure Plan Under the Land Sales Act 1984 (as amended).

It is not to be used by any other person or corporation or for any other purposes and is subject to the following limitations:

Please refer to the approved Development Application for conditions relating to the LOT and to approved Operational Works drawings for services location and possible easements.

THESE DESIGNS AND DRAWINGS ARE COPYRIGHT AND ARE NOT TO BE USED OR REPRODUCED WITHOUT THE WRITTEN PERMISSION OF VERIS

#### Data Sources

Cadastral Boundaries: 401871-LC01-P.dwg

Engineering Design: X\_22-000082\_8\_BASE-20250812.dwg

Final Surface Contours: 22-000082-5-12-Design-Contours-250mm-20250808.dwg

Depth of Fill: 22-000082-5-12-depth-contour-0.1m-20250808.dwg

Retaining Walls: X\_22-000082\_8\_BASE-20250812.dwg

X\_22-000082\_8\_BASE-20250812.dwg

X\_22-000082\_8\_BASE-20250812.dwg

X\_22-000082\_8\_BASE-20250812.dwg

X\_22-000082\_8\_BASE-20250812.dwg

X\_22-000082\_8\_BASE-20250812.dwg

X\_22-000082\_8\_BASE-20250812.dwg

X\_22-000082\_8\_BASE-20250812.dwg

X\_22-000082\_8\_BASE-20250812.dwg

X\_22-000082\_8\_BASE-20250812.dwg

X\_22-000082\_8\_BASE-20250812.dwg

X\_22-000082\_8\_BASE-20250812.dwg

X\_22-000082\_8\_BASE-20250812.dwg

X\_22-000082\_8\_BASE-20250812.dwg

X\_22-000082\_8\_BASE-20250812.dwg

X\_22-000082\_8\_BASE-20250812.dwg

X\_22-000082\_8\_BASE-20250812.dwg

X\_22-000082\_8\_BASE-20250812.dwg

X\_22-000082\_8\_BASE-20250812.dwg

X\_22-000082\_8\_BASE-20250812.dwg

X\_22-000082\_8\_BASE-20250812.dwg

X\_22-000082\_8\_BASE-20250812.dwg

X\_22-000082\_8\_BASE-20250812.dwg

X\_22-000082\_8\_BASE-20250812.dwg

X\_22-000082\_8\_BASE-20250812.dwg

X\_22-000082\_8\_BASE-20250812.dwg

X\_22-000082\_8\_BASE-20250812.dwg

X\_22-000082\_8\_BASE-20250812.dwg

X\_22-000082\_8\_BASE-20250812.dwg

X\_22-000082\_8\_BASE-20250812.dwg

X\_22-000082\_8\_BASE-20250812.dwg

X\_22-000082\_8\_BASE-20250812.dwg

X\_22-000082\_8\_BASE-20250812.dwg

X\_22-000082\_8\_BASE-20250812.dwg

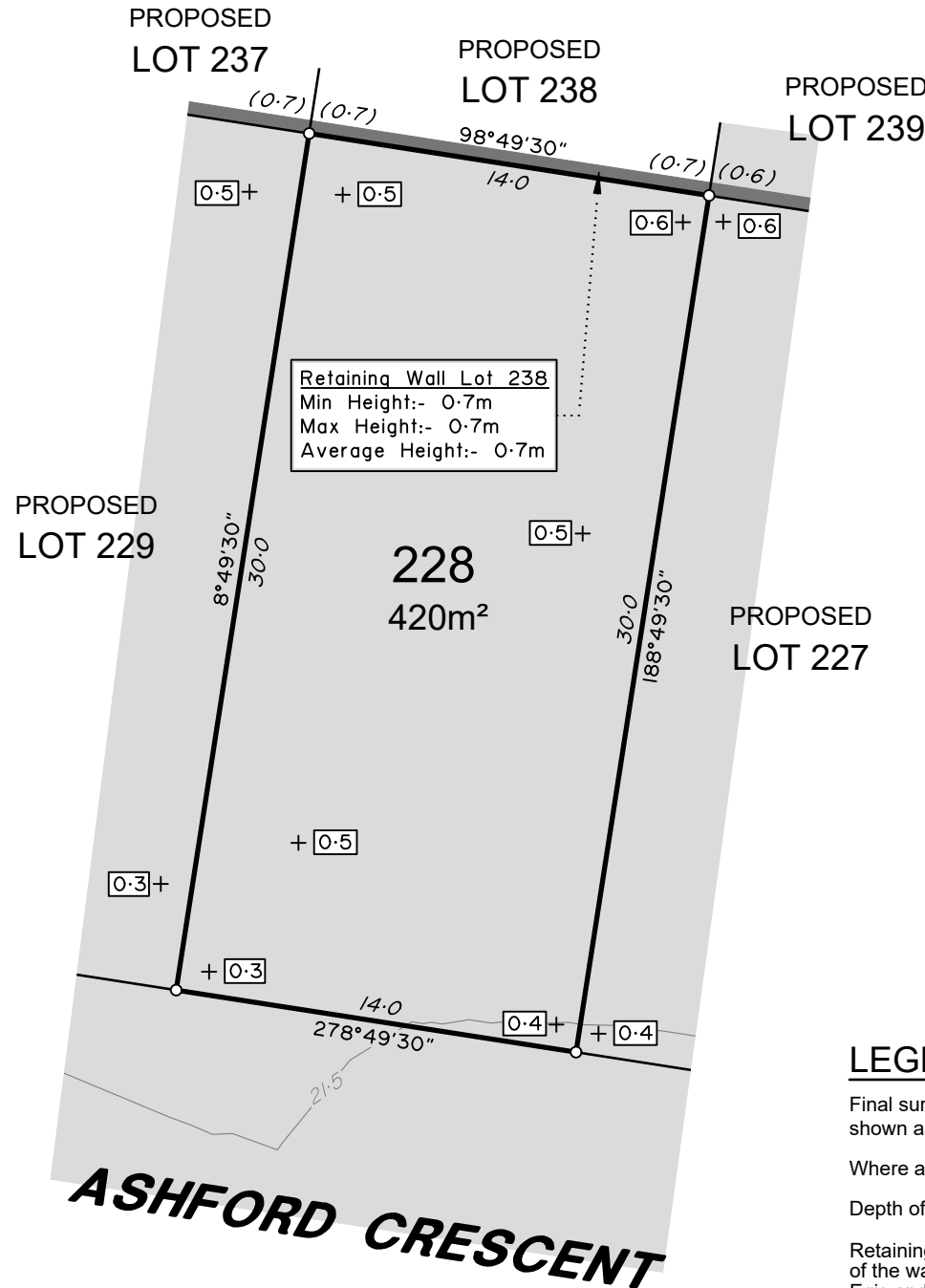

#### ADDITIONAL NOTES:

The LOT dimensions and area shown hereon are subject to final field survey and also to the requirements of Council and any other authority which may have requirements under any relevant legislation

Final surface contours shown hereon have been supplied by Egis.

Compaction of any fill material placed on this site shall be completed to level one inspection and testing services in accordance with AS3798-2007.

Depth of fill values are calculated to the lower of the pre-development surface and the ground surface from Survey.

Copyright © Veris Australia Pty Ltd August 2025

#### Lilywood Landings Stage 8 For Lennium Group

#### IMPORTANT NOTES:

(These notes are an integral part of this plan)

This plan has been prepared for Lennium Group for the purposes of A Disclosure Plan Under the Land Sales Act 1984 (as amended).

It is not to be used by any other person or corporation or for any other purposes and is subject to the following limitations:

Please refer to the approved Development Application for conditions relating to the LOT and to approved Operational Works drawings for services location and possible easements.

THESE DESIGNS AND DRAWINGS ARE COPYRIGHT AND ARE NOT TO BE USED OR REPRODUCED WITHOUT THE WRITTEN PERMISSION OF VERIS

#### Data Sources

Cadastral Boundaries: 401871-LC01-P.dwg

Engineering Design: X\_22-000082\_8\_BASE-20250812.dwg

Final Surface Contours: 22-000082-5-12-Design-Contours-250mm-20250808.dwg

Depth of Fill: 22-000082-5-12-depth-contour-0.1m-20250808.dwg

Retaining Walls: X\_22-000082\_8\_BASE-20250812.dwg

X\_22-000082\_8\_BASE-20250812.dwg

## LEGEND

Final surface contours based on A.H.D. datum at an interval of 0.5m, shown as: — 15.5 —

Where applicable, areas to be filled are shown as: [shaded area]

Depth of fill, in metres, shown as:- +0.5

Retaining wall and retaining wall height, shown on the lower side of the wall, have been calculated from digital data supplied by Egis and shown as: (1.2)



veris

BRISBANE (07) 3666 4700 WHITSUNDAYS (07) 4945 6600

MACKAY (07) 4957 9700 CAIRNS (07) 4252 9400

veris.com.au

ACN 615 735 727  
Veris Australia Pty Ltd

Drawing No 401871-DP228 Issue B



PROPOSED  
LOT 237

PROPOSED  
LOT 238

PROPOSED  
LOT 228

Retaining Wall Lot 229  
Min Height:- 0.1m  
Max Height:- 0.5m  
Average Height:- 0.3m

Retaining Wall Lot 237  
Min Height:- 0.7m  
Max Height:- 0.7m  
Average Height:- 0.7m

229  
516m<sup>2</sup>

ROAD

HOLSTEIN LANE

## LEGEND

Final surface contours based on A.H.D. datum at an interval of 0.5m, shown as: 

Where applicable, areas to be filled are shown as: 

Depth of fill, in metres, shown as:- 

Retaining wall and retaining wall height, shown on the lower side of the wall, have been calculated from digital data supplied by Egis and shown as: 

(1.2)

### ADDITIONAL NOTES:

The LOT dimensions and area shown hereon are subject to final field survey and also to the requirements of Council and any other authority which may have requirements under any relevant legislation

Final surface contours shown hereon have been supplied by Egis.

Compaction of any fill material placed on this site shall be completed to level one inspection and testing services in accordance with AS3798-2007.

Depth of fill values are calculated to the lower of the pre-development surface and the ground surface from Survey.

Copyright © Veris Australia Pty Ltd August 2025

Lilywood Landings  
Stage 8  
For  
Lennium Group

### IMPORTANT NOTES:

(These notes are an integral part of this plan)

This plan has been prepared for Lennium Group for the purposes of A Disclosure Plan Under the Land Sales Act 1984 (as amended).

It is not to be used by any other person or corporation or for any other purposes and is subject to the following limitations:

Please refer to the approved Development Application for conditions relating to the LOT and to approved Operational Works drawings for services location and possible easements.

THESE DESIGNS AND DRAWINGS ARE COPYRIGHT AND ARE NOT TO BE USED OR REPRODUCED WITHOUT THE WRITTEN PERMISSION OF VERIS

### Data Sources

Cadastral Boundaries: 401871-LC01-P.dwg

Engineering Design: X\_22-000082\_8\_BASE-20250812.dwg

Final Surface Contours: 22-000082-5-12-Design-Contours-250mm-20250808.dwg

Depth of Fill: 22-000082-5-12-Design-Contours-250mm-20250808.dwg

Retaining Walls: X\_22-000082\_8\_BASE-20250812.dwg

X\_22-000082\_8\_BASE-20250812.dwg

B Updated Engineering 12/08/2025 TEM

A Original 6/02/2025 TEM

Issue Revisions Date Drawn

Locality: Lilywood

Local Authority: Moreton Bay C. C.

Horizontal Meridian: MGA, Zone56

Vertical Level Datum: AHD

Scale: 1:250 @ A4

Designed: Egis

Drawn: TEM 6/02/2025

Checked: DC

Plot Date: 12 Aug, 2025

Computer File Ref: 401871-S18-DP(B).dwg

DISCLOSURE PLAN

of Proposed LOT 229

being part of

Lot 12

on RP866105



veris

BRISBANE WHITSUNDAYS  
(07) 3666 4700 (07) 4945 6600

MACKAY CAIRNS  
(07) 4957 9700 (07) 4252 9400

veris.com.au

ACN 615 735 727

Veris Australia Pty Ltd

Drawing No Issue

401871-DP229 B

0 12.5m 50 mm 25m 100 mm 37.5m 150 mm SCALE BAR